

Pin strip for SMD
971-SLR-SMD-1,1
 Plug-in area \varnothing 1,1 mm

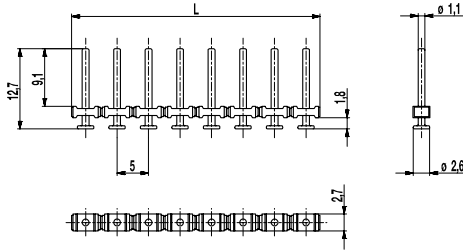

PCB Layout

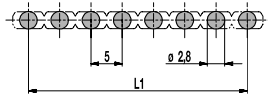

$L1 = (\text{No. of poles} - 1) \times \text{pitch}$
 Solder paste thickness: 0,15 - 0,2 mm

971-SLR-SMD is a pin strip with a pitch of 5 mm for the application in a reflow soldering process. In contrary to the well-known pin rows 971-SLR and 971-SLR-THR, for which holes in the PCB are necessary, the SMD types of WECO base on true surface assembly. Soldering expands at the end of the pins guarantee optimal retention force on the printed circuit board. We recommend this pin strip with a diameter of 1,1 in the mating area for higher numbers of poles, in order to minimize the plug-in and withdrawal forces here. Just like all THR versions of WECO also the housings of the SMD series are made out of high temperature resistant plastic material and exhibit a very high CTI value. For the automatic assembling all pin strips of this series are packed in Tape-on-Reel and equipped with high temperature resistant Pick Caps, which can easily be removed after the soldering process.

Part Numbers

| No. of poles | 971-SLR-SMD-1,1 | Length | PU |
|--------------|-----------------|--------|------|
| 2 | 12.893.822 | 9,50 | 1000 |
| 3 | 13.893.822 | 14,50 | 500 |
| 4 | 14.893.822 | 19,50 | 500 |
| 5 | 15.893.822 | 24,50 | 250 |
| 6 | 16.893.822 | 29,50 | 250 |
| 10 | 20.893.822 | 49,50 | 100 |
| 12 | 22.893.822 | 59,50 | 100 |

further number of poles on request

General Information

| | |
|------------------------|---|
| Pitch | 5 mm |
| No. of poles | 2 - 12 |
| Usable with | plug connectors of series 115-F-.../...-1,1-SW; 950-FL-DS, 950-TFL-DS, 950-NAF-DS, 950-GFL-DS, 950-NLFL-DS, 950-RFL-DS |
| Additional Information | Also, please take into consideration the pin strips 971-SLR for wave soldering and 971-SLR-THR for Through-Hole-Reflow. |

Technical Data

| Overvoltage Category | III | III | II |
|--------------------------|--------------------------|--------|--------|
| Pollution Severity Level | 3 | 2 | 2 |
| Rated Voltage | 160 V | 160 V | 320 V |
| Rated Impulse Voltage | 2,5 kV | 2,5 kV | 2,5 kV |
| Rated Insulation Voltage | 130 V acc. to EN 60998-1 | | |
| Rated Current | 10 A | | |
| Soldering process | Reflow solder | | |

Material

| | |
|----------------------------|--|
| Moulding | PA HT, black, V-0 |
| Comparative Tracking Index | CTI \geq 600 |
| Insulating Group | I |
| Temperature Range | -40°C up to 120°C; reflow solder temperature (Peak) max. 260°C (15-30 s) |
| Solder pin | \varnothing 1,1 mm (plug-in area); tin plated brass |

Approvals

| | Current | Voltage | Group | AWG | Nm |
|--|---------|---------|-------|-----|----|
| | 10 | 300 | B | | |
| | 10 | 300 | B | | |

Options / Accessories

- Other plug pin lengths on request
- Other solder pin surfaces on request

Part Numbers: Tape-on-Reel

| No. of poles | 971-SLR-SMD-1,1 | Tape Width | Tape Height | PU |
|--------------|-----------------|------------|-------------|-----|
| 2 | 12.893.822.A00 | 32 mm | 15,9 mm | 500 |
| 3 | 13.893.822.A00 | 32 mm | 15,9 mm | 500 |
| 4 | 14.893.822.A00 | 56 mm | 15,9 mm | 500 |
| 5 | 15.893.822.A00 | 56 mm | 15,9 mm | 500 |
| 6 | 16.893.822.A00 | 56 mm | 15,9 mm | 500 |
| 7 | 17.893.822.A00 | 56 mm | 15,9 mm | 500 |
| 8 | 18.893.822.A00 | 72 mm | 14,9 mm | 500 |
| 9 | 19.893.822.A00 | 72 mm | 14,9 mm | 500 |
| 10 | 20.893.822.A00 | 72 mm | 14,9 mm | 500 |
| 11 | 21.893.822.A00 | 88 mm | 15,8 mm | 500 |
| 12 | 22.893.822.A00 | 88 mm | 15,8 mm | 500 |

further number of poles on request