

REV	LOCALS	DESCRIPTION	DRAW	DATE
AO	NEW	PERLIMINARY	LITAO	2016.03.05

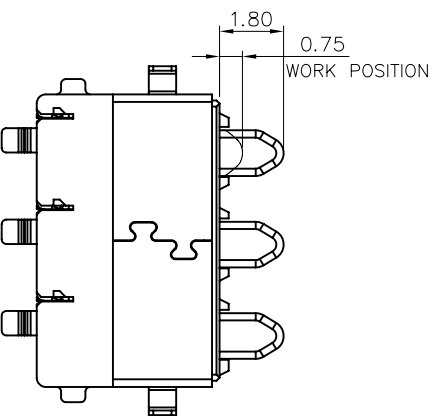
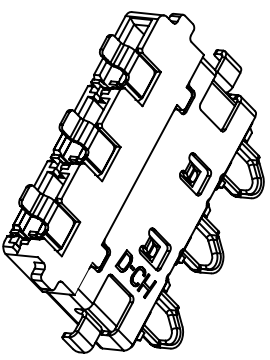
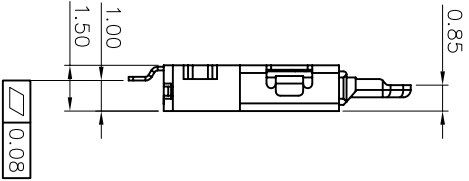
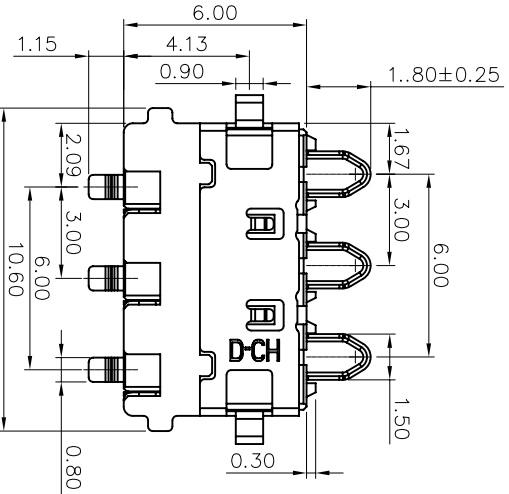
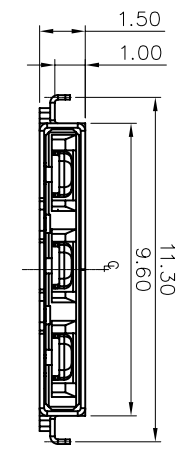

- NOTES:
- MATERIAL:
 - Housing: High Temperature Thermoplastic UL94V-0; Color Black.
 - Terminal: Copper Alloy, T=0.12mm.
 - Shell: Stainless Steel, T=0.15mm.
 - FINISH:
 - Terminal: Plated Gold on the Contact Area, Plated Matte Tin on the Solder Tails, Underplated Nickel Over all.
 - Shell: Plated Gold on the Contact Area, Underplated Nickel Over all.
 - SPECIALITY:
 - Rated current: 1.0A
 - Rated voltage: 30V
 - Contact Resistance: 50mΩ MAX
 - Insulation Resistance: 100MΩ MIN 100V DC
 - Dielectric withstanding voltage: 250V AC.
 - Solder ability: 245±5→5±0.5s.
 - Durability: 3000 Cycles Min.

Ordering Information

B Battery Series
 A Finished Product
 No. of PINS: 03(3PIN)
 Plating Number

Running number
 150: Height 1.50mm
 300: Pitch 3.00mm

PART NUMBER	DESCRIPTION
BA0301300150-108	WITH LOGO
BA0301300150-108-01	WITHOUT LOGO

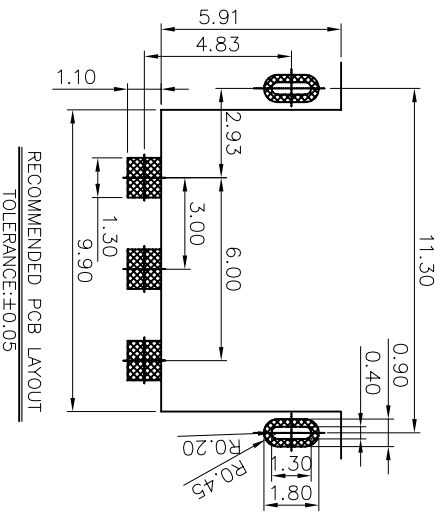

RECOMMENDED PCB LAYOUT
 TOLERANCE: ±0.05

MEASURE POINT: (QP) (TP) (P)

QUADRANT POINT (QP)

TANGENCY POINT (TP)

INTERSECTION POINT (P)

UNLESS OTHERWISE SPECIFIED, TOLERANCE:

X	±0.25
X.X	±0.20
X.XX	±0.10
ANGULAR	±3°

SHEN ZHEN D-CHAIN TECHNOLOGY CO., LTD

D-CHAIN

DESIGN	LITAO	DATE	2016.03.05	TITLE:
CHECKED		DATE		1.50H 3.0PITCH BATTERY
APPROVED		DATE		INSERT 1.0MM REVERSE TYPE
PART NO:	BA0301300150-108	REV:	A0	SCALE: 1:1
DRAWING NO:	DOBBA0301300150-108	SIZE:	A4	UNIT: mm
		SHEET:	1/1	