

目錄 MAPX	设 变 内 容 MODIFICATION	日期 DATE

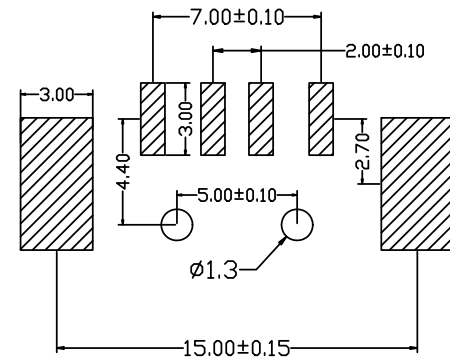
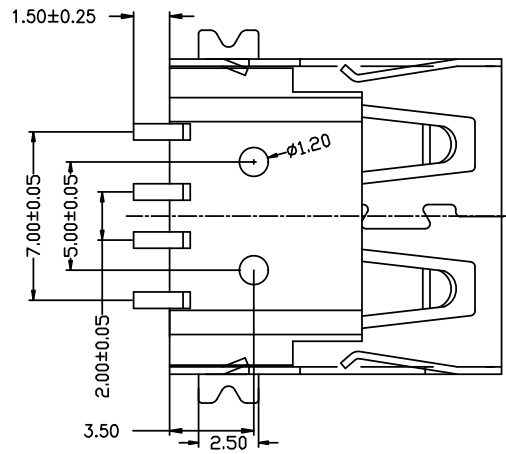
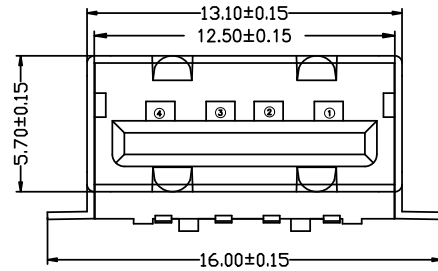
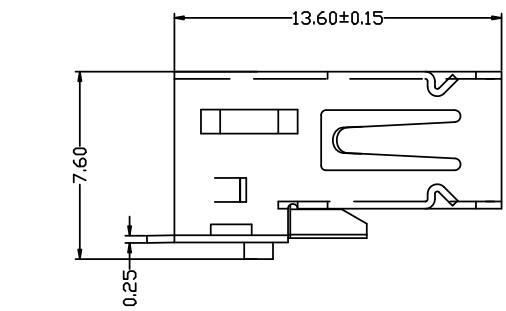

PCB:LAYOUT

电气特性:Electrical:

1. 额定电流: Current Rating  
1.5A/contact terminal
2. 额定电压: Voltage Rating  
30V DC
3. 接触阻抗: Contact Resistance  
30 milliohms MAX
4. 耐电压: Dielectnic Withstanding Voltage:  
500 V AC AT Sea Level
5. 绝缘阻抗: Lnsulation Resistance:  
1000MEGA ohms MIN

物理性能: Mechanical:

1. 插拔力: Cnnector Mate and Unmate Force  
Mate force: 3.57kgf (MAX)  
Unmate force: 0.7kgf (MIN)
2. 端子保持力: Terminal Retenion  
1.2kgf (MIN)
3. 寿命: 1500次

原材料: Matorial:

1. 塑胶: Housing: LCP NC
2. 端子: Contact: Copper Alloy C2680
3. 外壳: Shell: SPCC

电镀: Finish:

1. 端子 Contact: Au 0.7u" Plated on contact area  
Tin50u" Plated on solder area  
Nickel 50u" Plated underplating over all.
2. 外壳 Shell: Nickel 50u" Min plating over all.

# 深圳市精拓金电子有限公司

Pin NUMBER		SIGNAL NAME		产品图 PRODUCT CHART DWG		单位 UNITS		MM		制图 DRAWING		林属升		产品料号 PRODUCT PART NO.		904-241B2032S10100	
1		VBUS		公差一览表 TOLERANCE UNLESS OTHERWISE		比例 SCALE		1:1		审核 CHKD		郭志富		产品名称 PRODUCT NO.		AF鱼叉脚贴板无边内弹铁壳反向 LCP本色1.2柱	
2		D-		.X ±0.25 .X' ±5'		日期 DATE		2015/10/20		核准 APPD		黄国荣		角法 VIEW		版本 VER	
3		D+		.X ±0.20 .X' ±2'													
4		GND		.XX ±0.15 .XX' ±1'													
				.XXX ±0.10 .XXX' ±0.5'													