

NOTES:

1.MATERIAL:

1-1.HOUSING: LCP, COLOUR:BLACK, UL94-V0.
1-2.INSERTMOLDING: LCP, COLOUR:BLACK, UL94-V0.

1-3.CONTACT: C5191(T=0.20mm)
GOLD PLATING 3u" Min. IN CONTACT AREA,
100u" Min. Tin PLATED ON SOLDER TAILS.
50u" Min. NICKEL PLATED OVERALL.

1-4.SHELL: SUS304(T=0.30mm)
50u" Min. NICKEL PLATED OVERALL.

2.ELECTRICAL CHARACTERISTICS:

2-1. CURRENT RATING: 0.5A
2-2. CONTACT RESISTANCE: 30mΩ MAX.
2-3. INSULATION RESISTANCE: 100MΩ MIN.
2-4. DIELECTRIC WITHSTAND VOLTAGE: AC
500V/MINUTE.

2-5. OPERATING TEMPERATURE RANGE:
-25°C~+85°C

3.MECHANICAL CHARACTERISTICS:

3-1. INSERTION FORCE: 4.0Kgf MAX.
3-2. EXTRACTION FORCE: 0.7Kgf MIN.,2.5Kgf
MAX.

4.DURABILITY: 10000 CYCLES.

5.SALT FOG TEST:48H.

6. MARK * IS THE QC DIMENSION

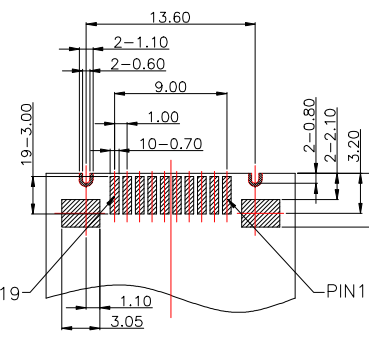
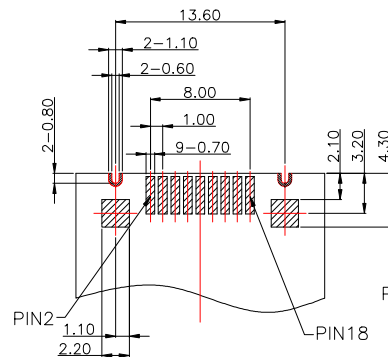
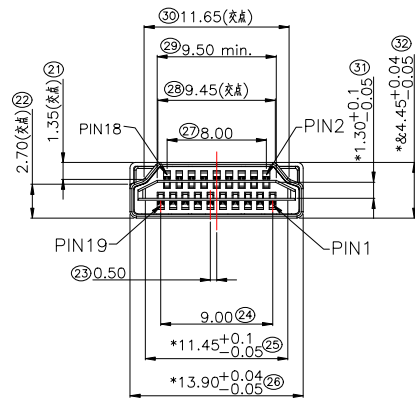
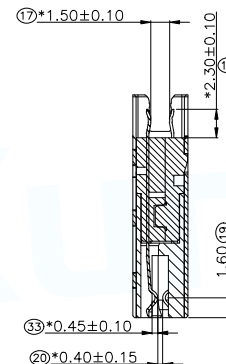
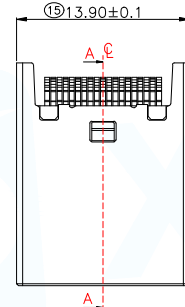
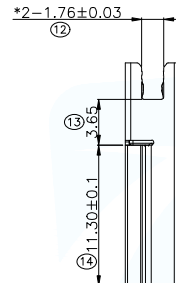
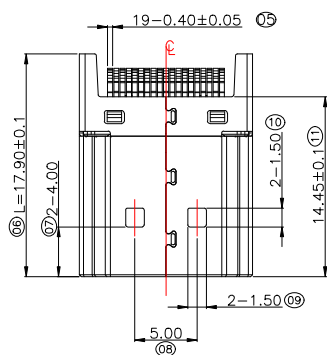

RECOMMENDED PCBA TOLERANCE±0.05MM

MANUFACTURE DWG			 东莞市讯普电子科技有限公司 DongGuan XunPu Electronics Co.,Ltd	
UNLESS OTHERWISE SPECIFIED TOLERANCES			TITLE: HDMI A TYPE 板上型	
DECIMALS:	ANGLES:	PAR	HDMI-003	
X.X:±0.25	.X':±1.0°	DWN		
X.XX:±0.15	.XX':±0.5°	CHKD		
X.XXX:±0.10		APVD		
CUSTOMER COPY		SCALE1:1	UNIT:MM	
		SIZE:A4	SHEET:1F1	REV:A