





-  RF Transformer
-  Operating temperature range: 0°C to 70°C
-  Storage temperature range: -40°C to +85°C
-  RoHS compliant
-  Impedance=100Ω



Electrical Specifications @25°C, Z₀=100Ω

Part Number	Turns Ratio	Insertion Loss	Hi-pot	Frequency Range
		P1-3:P3-4:P6-5:P8-6	70-680MHz	P1-4 To P5-8
RFT-085SG	1:1:1:1±5%	6.0dB Max	4000Vac 60S	

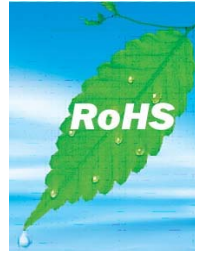
MECHANICAL

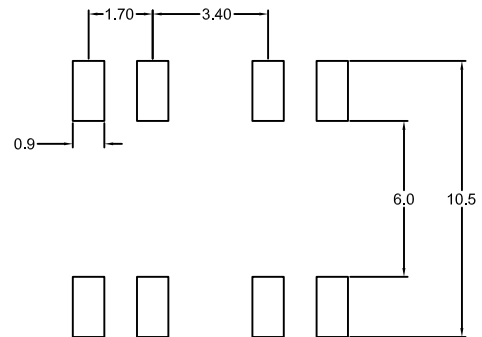
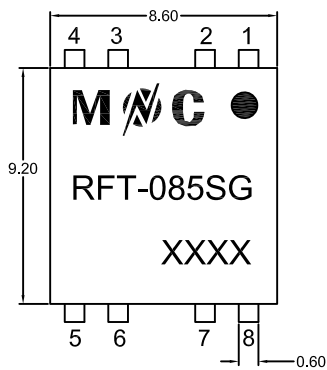

Recommend PAD Layout

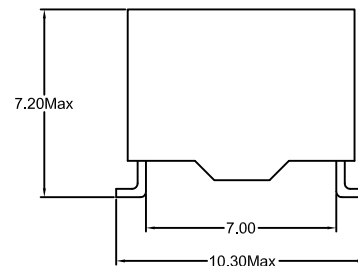
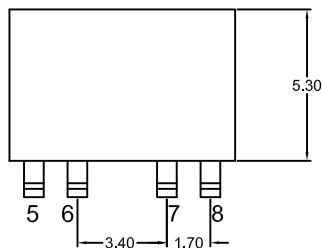

Unless otherwise specified all tolerances are:±0.25 in mm

SCHEMATICS

