

环保物料

TEL: 0769-82001899

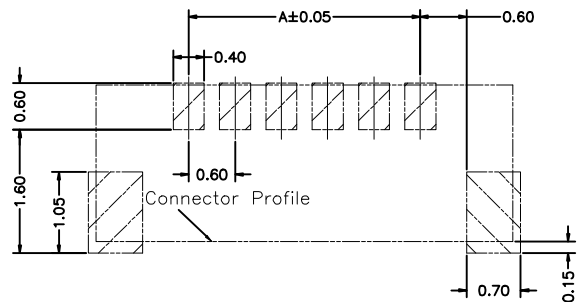

RECOMMENDED PCB LAYOUT
DEFAULT TOL: ±0.05

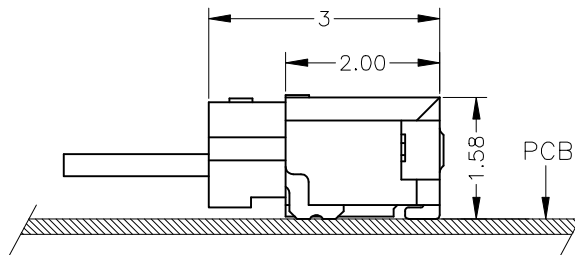

MATED CONDITION

NOTES:

1.MATERIAL:

Housing: Thermal Plastic, High Temp, (UL94V-0)
Contact: Copper Alloy
Nail: Brass

2.FINISH:

Contact:

50u" Min, NICKEL UNDERPLATING OVERALL.
1.GOLD FLASH PLATING OVERALL.
2.100u" MIN. MATT TIN OVERALL.

Nail:

50u" MIN, NICKEL UNDERPLATING OVERALL.
100u" MIN, MATT TIN OVERALL.

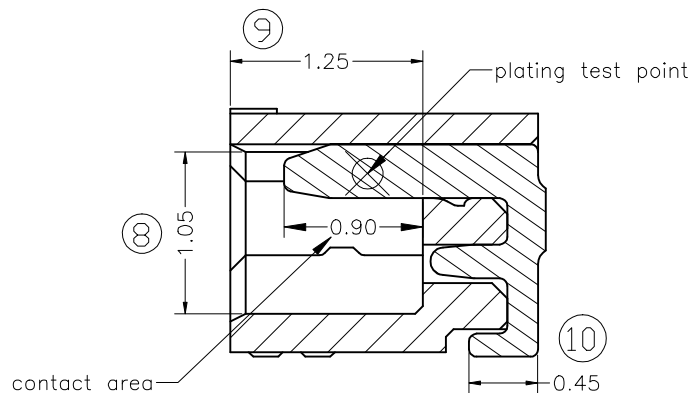
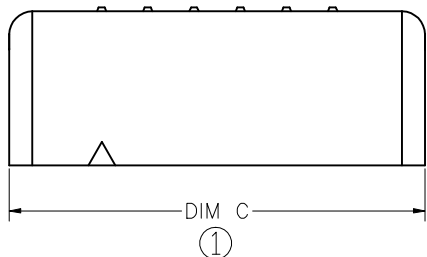

SECTION A-A
SCALE 2:1

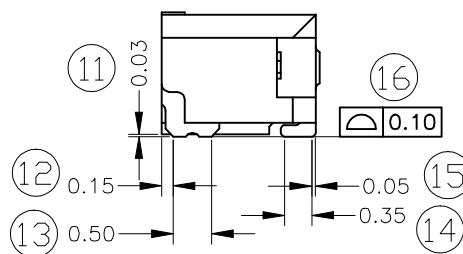
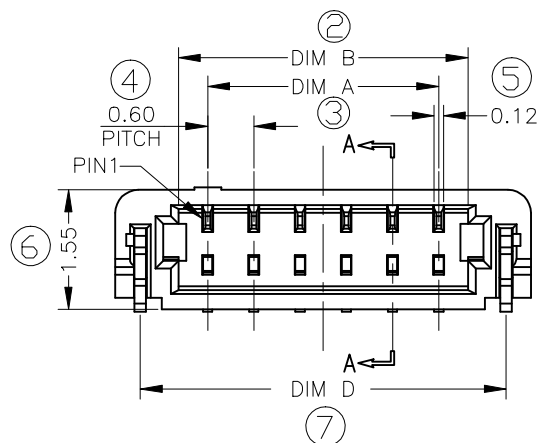

CKT.	Dim A	Dim B	Dim C	Dim D
2	0.60	1.36	3.00	2.35
4	1.80	2.56	4.20	3.55
5	2.40	3.16	4.80	4.15
6	3.00	3.76	5.40	4.75
7	3.60	4.36	6.00	5.35
8	4.20	4.96	6.60	5.95
10	5.40	6.16	7.80	7.15
12	6.60	7.36	9.00	8.35
14	7.80	8.56	10.20	9.55
16	9.00	9.76	11.40	10.75

				TOLERANCE UNLESS OTHERWISE		DRAWN	CK tan	XFCN 兴飞连接器有限公司 CONNECTORS XFCN CONNECTORS CO., LTD.		SHEET	1/1
				X.	±0.30	X°	±5°			CHKD	DATE
				.X	±0.20	.X°	±2°	APPD	PRODUCT NAME	0.60mm IDC Style Connectors	
				.XX	±0.08	.XX°	±1°	VIEW	PART. NO.	M0611RS-XX-GB	
				.XXX	±0.03	.XXX°	±0.5°				
A0	MODIFICATION		DATE							DWG NO.	009