

# HSF

NOTES:  
 Current Rating: 0.5AMP  
 Voltage Rating: 50V AC/DC  
 Contact Resistance: 30mΩ max  
 Withstand Voltage: 100V AC for 1minute  
 Insulation Resistance: 500MΩ min  
 Operation Temperature: -25°C to +105°C

Housing Material: PA9T(UL94V-0), NATURAL  
 Contact Material: Copper alloy  
 Fixing Material: Copper alloy  
 Contact plating: Au over Ni  
 Fixing plating: Sn over Ni

## Ordering Information

3622-S XXX - XXX XX X 02

|             |              |   |                 |
|-------------|--------------|---|-----------------|
| No. of Pins | Housing High | Contact Plating                               | T=Tube          |
| 14P 36P     | 022=2.20     | G1=3u"Gold                                    | P=Tube+CAP      |
| 20P 40P     | 027=2.70     | G3=10u"Gold                                   | R=Tape&Reel+CAP |
| 24P 50P     | 048=4.80     | G4=15u"Gold                                   |                 |
| 30P 60P     |              | G5=30u"Gold                                   |                 |
| 32P         |              | H5=30u"Gold(Contact area, 3u"Gold other area) |                 |

| ASS'Y HEIGHT(K) | PLUG(H2) | SOCKET(H1) |
|-----------------|----------|------------|
| 3.00            | 2.33     | 2.20       |
| 3.50            | 2.80     |            |
| 4.00            | 2.80     |            |
| 4.50            | 3.33     | 2.73       |
| 5.00            | 3.83     |            |
| 5.50            | 4.33     |            |
| 6.00            | 4.83     |            |
| 6.50            | 3.33     |            |
| 7.00            | 3.83     |            |
| 7.50            | 4.33     | 4.70       |
| 8.00            | 4.83     |            |

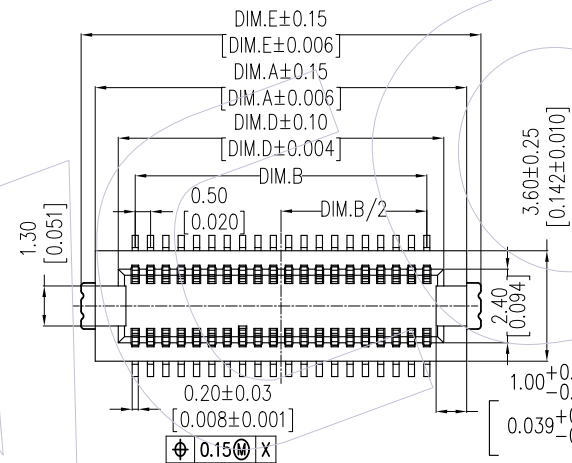
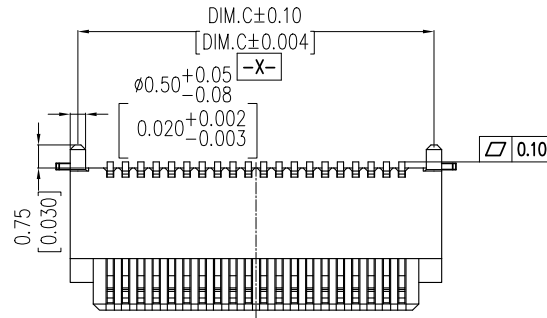
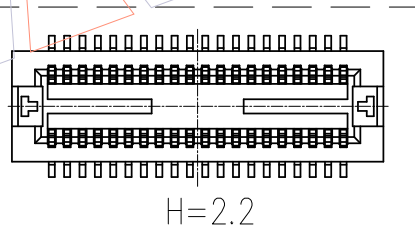

Recommended P.C.B Layout (Top Side)  
 (PCB BOARD TOLERANCE ± 0.05)

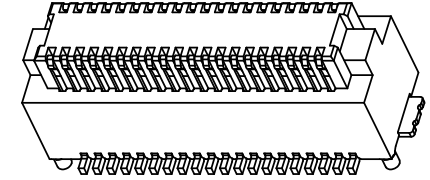
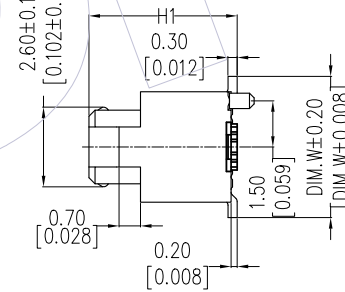
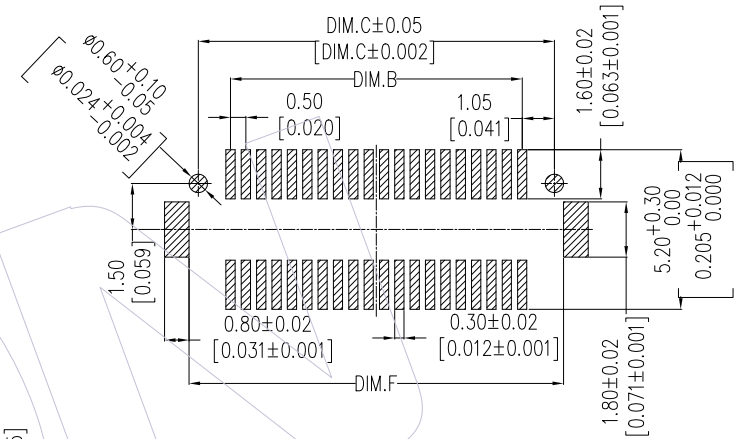

| PART NO.           | DIM.H1 | DIM.W |
|--------------------|--------|-------|
| 3622-SXXX-022XXX02 | 2.20   |       |
| 3622-SXXX-027XXX02 | 2.73   | 4.60  |
| 3622-SXXX-048XXX02 | 4.70   |       |

| PIN NO. | DIM.A | DIM.B | DIM.C | DIM.D | DIM.E | DIM.F |
|---------|-------|-------|-------|-------|-------|-------|
| 14      | 5.60  | 3.00  | 5.10  | 4.10  | 6.50  | 5.70  |
| 20      | 7.10  | 4.50  | 6.60  | 5.60  | 8.00  | 7.20  |
| 24      | 8.10  | 5.50  | 7.60  | 6.60  | 9.00  | 8.20  |
| 30      | 9.60  | 7.00  | 9.10  | 8.10  | 10.50 | 9.70  |
| 32      | 10.10 | 7.50  | 9.60  | 8.60  | 11.00 | 10.20 |
| 36      | 11.10 | 8.50  | 10.60 | 9.60  | 12.00 | 11.20 |
| 40      | 12.10 | 9.50  | 11.60 | 10.60 | 13.00 | 12.20 |
| 50      | 14.60 | 12.00 | 14.10 | 13.10 | 15.50 | 14.70 |
| 60      | 17.10 | 14.50 | 16.60 | 15.60 | 18.00 | 17.20 |

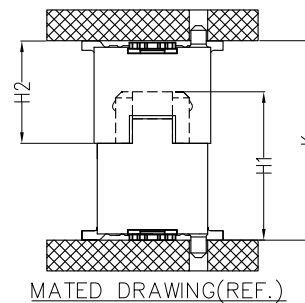

| OPERATION    | DRAW    | DATE       | SCALE | Fit | PART NO.                               |
|--------------|---------|------------|-------|-----|--|
| x.x ± 0.40   | Ding    | 2018/03/09 | UNIT  | mm  | 3622-SXXX-XXXXXX02                     |
| x.xx ± 0.25  | CHECK   | DATE       | SIZE  | A4  | TITLE:                                 |
| x.xxx ± 0.15 | APPROVE | DATE       | SHEET | 1/1 | 0.50pitch BTB FEMALE SMT TYPE W/ LATCH |
| Angle ± 3'   |         |            | PROJ. |     | Customer NO.                           |
| DIM TOL      |         |            |       |     |  |

# WCON

Http: www.wcon.com

|   |  |
|---|--|
| WCON-Dongguan<br>Tel: +86 769 85358920<br>Fax: +86 769 85358915<br>E-mail: sales@wcon.com | WCON-Kunshan<br>Tel: +86 512 57468408<br>Fax: +86 512 57468468<br>E-mail: salesks@wcon.com |
|---|--|

| REV | DATE       | MODIFICATION DESCRIPTION | CHANGE |
|-----|------------|--------------------------|--------|
| A0  | 2018/03/09 | NEW                      | -----  |