

REV	LOCATIONS	DESCRIPTION	DATE	REVISER	APPD

Electrical

Current Rating: 2.0A AC/DC
Voltage Rating: 100V AC/DC
Contact Resistance: 10mΩ Max
Insulation Resistance: 1000MΩ Min
Withstanding Voltage: 800V AC/minute
Temperature Range-Operating: -25°C~+85°C

Material

Housing: PA66(UL 94V-0)
Applicable Terminal: FT20001
Mates With(Wafer): FWF20001,FWF20002,F20003,FWF20004,
FWF20014,FWF20015,FWF20016Series

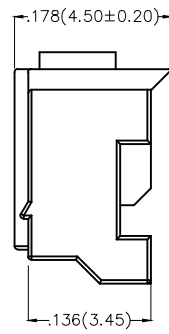
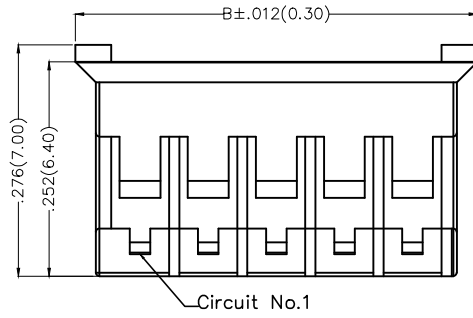
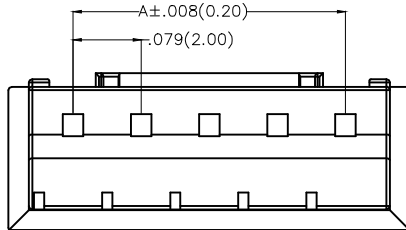

Circuits (n)	Part No.	Dimensions(in/mm)	
		A	B
2	FHG20001-S02M2W1B	.079(2.00)	.228(5.80)
3	FHG20001-S03M2W1B	.157(4.00)	.307(7.80)
4	FHG20001-S04M2W1B	.236(6.00)	.386(9.80)
5	FHG20001-S05M2W1B	.315(8.00)	.465(11.80)
6	FHG20001-S06M2W1B	.394(10.00)	.543(13.80)
7	FHG20001-S07M2W1B	.472(12.00)	.622(15.80)
8	FHG20001-S08M2W1B	.551(14.00)	.701(17.80)
9	FHG20001-S09M2W1B	.630(16.00)	.779(19.80)
10	FHG20001-S10M2W1B	.709(18.00)	.858(21.80)
11	FHG20001-S11M2W1B	.787(20.00)	.937(23.80)
12	FHG20001-S12M2W1B	.866(22.00)	1.016(25.80)
13	FHG20001-S13M2W1B	.945(24.00)	1.094(27.80)
14	FHG20001-S14M2W1B	1.024(26.00)	1.173(29.80)
15	FHG20001-S15M2W1B	1.102(28.00)	1.252(31.80)
16	FHG20001-S16M2W1B	1.181(30.00)	1.331(33.80)

Ordering Information

FHG 200 01 - S XX M 2 W1 B
1 2 3 4 5 6 7 8 9

1	Category FHG-Housing	2	Series Number 200-Pitch2.0mm	3	Distinction No. 01	4	Row Option Single Row	5	Circuits XX
6	Entry Type M-Male	7	Material-Resin 2-PA66	8	Color-Resin W1-White	9	Packaging B-PE Bag		

 THIRD ANGLE PROJECTION	GENERAL TOLERANCES (UNLESS SPECIFIED)		APPROVE BY FRANK	DATE 25/JUN/13	PART NO. FHG20001-SXXM2W1B	ITEM NO. FHG20001	 Leader Of Industry	
	DESIGN UNITS Inch (metric)	X.X ±.012(0.30) X.XX ±.008(0.20) X.XXX ±.006(0.15) X.XXX ±.004(0.10)	X' ±5" X' ±2" .XX' ±1" .XXX' ±0.5'	CHECKED BY JACOB	DATE 25/JUN/13	TITLE Wire to Board Pitch 2.0mm(Housing)		REV 0
SCALE 5:1	SIZE A4	DRAWN BY CHERRY		DATE 25/JUN/13	THIS DRAWING CONTAINS INFORMATION THAT IS PROPRIETARY TO TXGA INDUSTRIAL ELECTRONICS(S.Z)CO.,LTD AND SHOULD NOT BE USED WITHOUT WRITTEN PERMISSION			