

REV	LOCATIONS	DESCRIPTION	DATE	REVISER	APPD

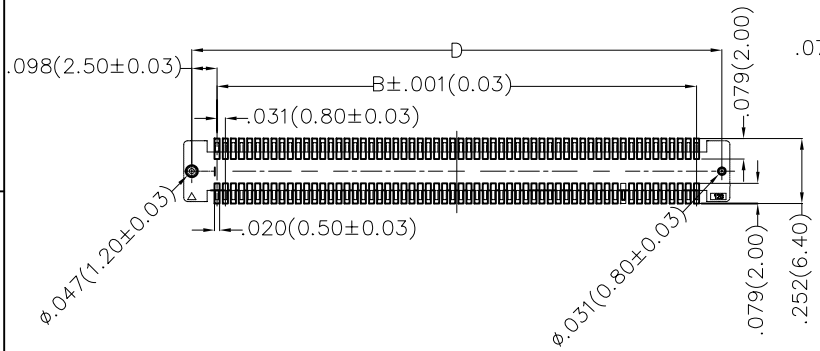
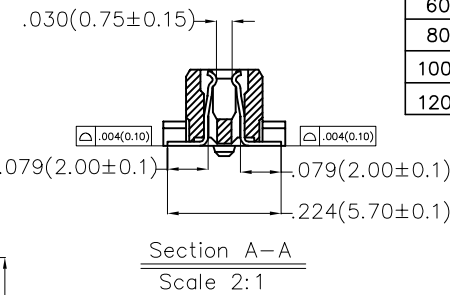
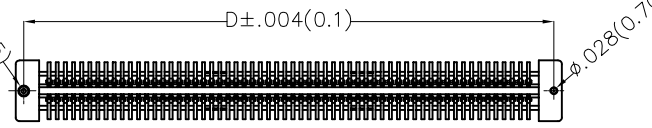
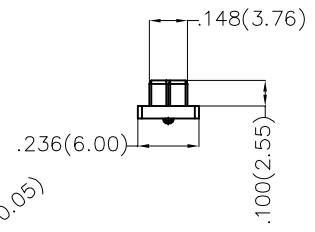
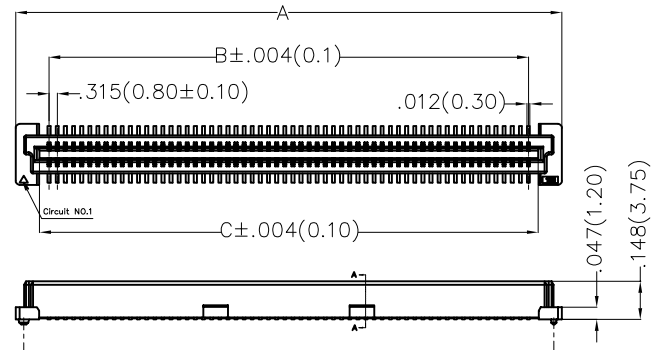

Recommended P.C.B Layout(Top Side)
(PCB Board Tolerance±0.05)

Electrical
 Current Rating: 0.5A AC(rms)/DC
 Voltage Rating: 50V AC(rms)/DC
 Contact Resistance: 50 mΩ Max.
 Insulation Resistance: 500 MΩ Min.
 Withstanding Voltage: 200V AC r.m.s
 Temperature Range-Operating: -35°C~+85°C
 Material and Plating
 Housing: LCP (UL94V-0)
 Contacts Pin: Phosphor Bronze
 Plating: Gold plated

Circuits (n)	Part No.	Dimensions(in/mm)			
		A	B	C	D
40	FBB08006-F40S1XX3W5M	.858(21.80)	.598(15.20)	.673(17.10)	.795(20.20)
50	FBB08006-F50S1XX3W5M	1.016(25.80)	.756(19.20)	.831(21.10)	.953(24.20)
60	FBB08006-F60S1XX3W5M	1.173(29.80)	.913(23.20)	.988(25.10)	1.110(28.20)
80	FBB08006-F80S1XX3W5M	1.488(37.80)	1.228(31.20)	1.303(33.10)	1.425(36.20)
100	FBB08006-F100S1XX3W5M	1.803(45.80)	1.543(39.20)	1.618(41.10)	1.470(44.20)
120	FBB08006-F120S1XX3W5M	2.118(53.80)	1.858(47.20)	1.933(49.10)	2.055(52.20)

Ordering Information

FBB 080 06 — F XX S 1 XX 3 W5 M
 1 2 3 4 5 6 7 8 9 10 11

1 Category FBB-Board To Board	2 Series Number 080-Pitch0.8mm	3 Distinction No. 06	4 Type F-Female	5 Circuits XX	6 Entry Angle S-180° Vertical
7 Plating 1-Gold plated	8 Thickness of Plating 01-1μ" 05-5μ" Custom plate available	9 Material-Resin 3-LCP	10 Color-Resin W5-Natural	11 Packaging M-Reel	

 THIRD ANGLE PROJECTION DESIGN UNITS Inch (metric) SCALE 5:1	GENERAL TOLERANCES (UNLESS SPECIFIED) X.X±.012(0.30) X.X±.008(0.20) X.XX±.006(0.15) X.XXX±.004(0.10)	X.±5° X.±2° .XX±1° .XXX±0.5°	APPROVE BY FRANK	DATE 14/AUG/19	PART NO. FBB08006-FXXS1XX3W5M	ITEM NO. FBB08006	 Leader Of Industry REV 0 SHEET NO. 1/1
			CHECKED BY CHERRY	DATE 14/AUG/19	TITLE Board to Board Pitch 0.8mm 180° Vertical (SMT)	THIS DRAWING CONTAINS INFORMATION THAT IS PROPRIETARY TO TXGA INDUSTRIAL ELECTRONICS(S.Z)CO.,LTD AND SHOULD NOT BE USED WITHOUT WRITTEN PERMISSION	
			DRAWN BY ZOEY	DATE 14/AUG/19			