

### GT-TC074X-HXXX-LX

**G-SWITCH**

**Operating Force**

A=160gf  
B=250gf  
C=100gf

D=70gf

E=130gf

F=320gf

G=400gf

**Switch Height (mm)**  
H038=3.8 H043=4.3  
H045=4.5 H050=5.0  
H055=5.5 H060=6.0  
H065=6.5 H070=7.0  
H080=8.0 H085=8.5  
H090=9.0 H095=9.5

**Switch lifetime (Force)**

L05=50,000 Cycles (B, F, G)

L1=100,000 Cycles (A, B)

L3=300,000 Cycles (A, C, D)

L5=500,000 Cycles (A, C, D)

**G-Switch Specification:**

Operating temperature range -30 to+85

Rating 50mA.12V DC

Insulation resistance: 100MΩ min.100V DC

Dielectric strength 250V AC for 1 min

Contact resistance: 100m Ω max.

Travel:0.25±0.1mm

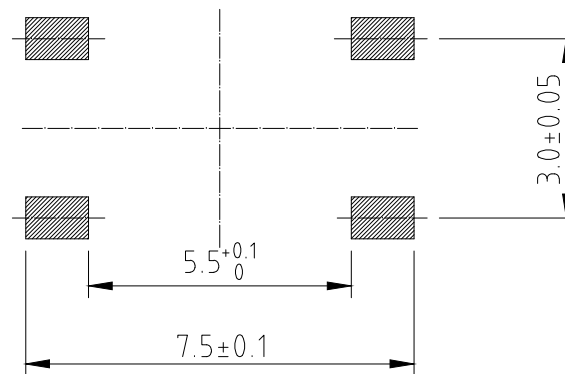
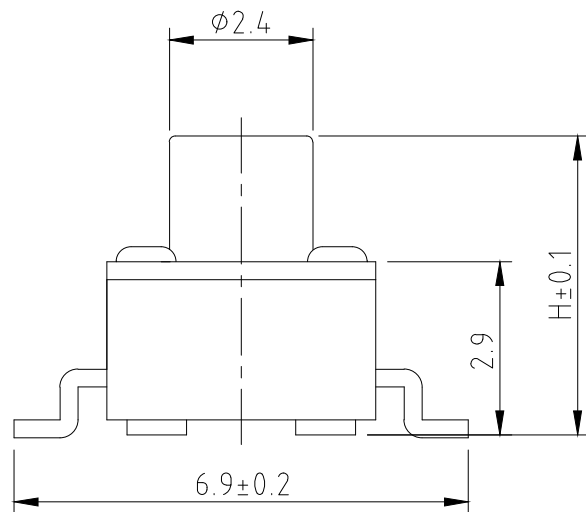

### P.C.B LAND DIMENSION

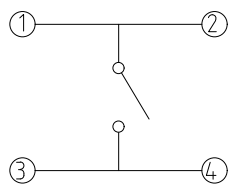

电路图



Unless otherwise specified, Tolerance:  
X. ±0.30  
X.x ±0.20  
X.xx ±0.15  
X.xxx ±0.10  
Angles ±3°

**G-Switch Electronic (HongKong) CO.,Ltd.**

DESIGN FengFengChen

DATE 2019.05.29

Molde code:

CHECKED

DATE

GT-TC074X-HXXX-LX

APPROVED

DATE

<http://www.dg-switch.com>

REV.: X1

SCALE: 4:1

UNIT: mm

TEL:0769-82388879

SIZE: A4

SHEET: 1/1

