

P.C.B LAND DIMENSION

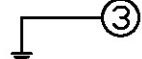

CIRCUIT DIAGRAM

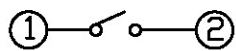
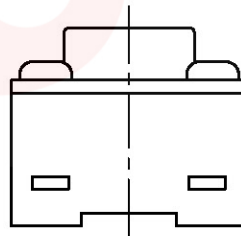

GT-TCX73X-HXXX-LX

G-SWITCH

Operating Force

- A=160gf
- B=250gf
- C=100gf
- D=300gf
- E=130gf

Switch lifetime (Force)

- L1=100,000 Cycles
- L3=300,000 Cycles
- L5=500,000 Cycles

G Height (mm)

- 073=6.5mm
- A73=5.7mm
- B73=7.5mm

Switch Height (mm)

- H038=3.8(A2.5) H040=4.0(A2.5)
- H043=4.3(A2.5) H045=4.5(A2.5)
- H048=4.8(A2.5) H050=5.0(A2.3)
- H055=5.5(A2.3) H060=6.0(A2.2)
- H070=7.0(A2.2) H075=7.5(A2.2)
- H080=8.0(A2.2) H085=8.5(A2.2)
- H090=9.0(A2.2) H095=9.5(A2.2)

G-Switch Specification:

Operating temperature range: -30°C to +85°C
 Rating: 50mA, 12V DC
 Insulation resistance: 100MΩ min. 100V DC
 Dielectric strength: 250V AC for 1 min
 Contact resistance: 100mΩ max.
 Travel: 0.25±0.1mm



G-Switch Electronic (HongKong) CO.,Ltd.

Unless otherwise specified, Tolerance:
 X. ±0.30
 X.x ±0.20
 X.xx ±0.15
 X.xxx ±0.10
 Angles ±3°

DESIGN FengFengChen DATE 2019.05.29
 CHECKED DATE
 APPROVED DATE
<http://www.dg-switch.com>
 TEL:0769-82388879

Molde code:
GT-TCX73X-HXXX-LX
 REV.: X1 SCALE: 4:1 UNIT: mm
 SIZE: A4 SHEET: 1/1