

RoHS 2.0

| REV. | ECN NO. | DESCRIPTION | DATE     | DESIGN |
|------|---------|-------------|----------|--------|
| A1.  | /.      | 重新核对图面      | 21.01.04 | LiHui  |

| PIN NUMBER | SIGNAL NAME |
|------------|-------------|
| PIN 1      | Vbus        |
| PIN 2      | D-          |
| PIN 3      | D+          |
| PIN 4      | GND         |
| PIN 5      | StdA_SSRX-  |
| PIN 6      | StdA_SSRX+  |
| PIN 7      | GND_DRAIN   |
| PIN 8      | StdA_SSTX-  |
| PIN 9      | StdA_SSTX+  |
| SHELL      | GND         |

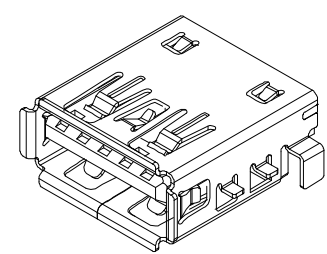
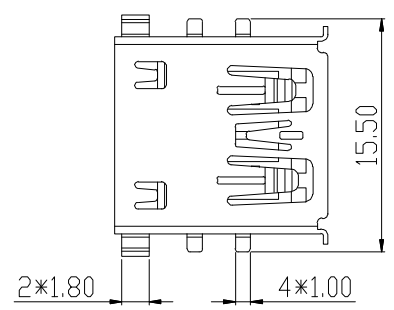

3D VIEW

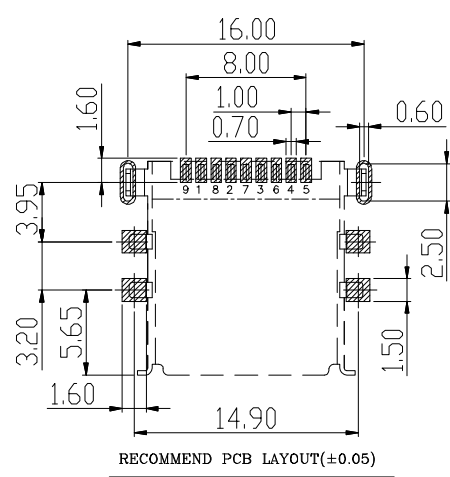
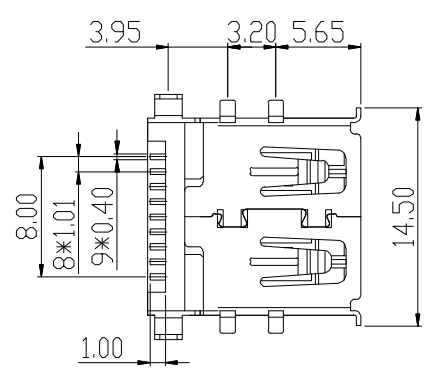
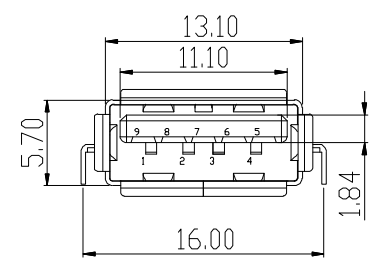
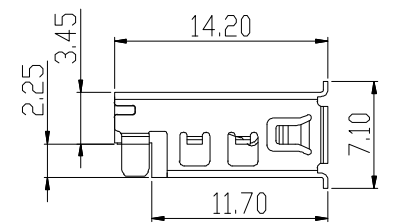
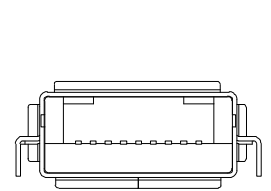

NOTES:

- MATERIAL:
  - HOUSING: LCP ,COLOR IS BLUE,HIGH TEMPERATURE PLASTIC;
  - CONTACT: BRASS (H65 T=0.20mm);
  - SHELL: COLD ROLLED IRON (SPCC T=0.30mm);
- ELECTRICAL:
  - VOLTAGE RATING: 30V DC ;
  - CURRENT RATING: 1.5A ;
  - CONTACT RESISTANCE: 30MILLIOHMS MAX.;
  - WITHSTAND VOLTAGE: 100V AC RMS 50(60)Hz,1MIN.;
  - INSULATION RESISTANCE: 100MEGOHMS MIN @500V DC;
- MECHANICAL:
  - MATING FORCE: 35N MAX.;
  - UNMATING FORCE: 5~35N ;
  - OPERATING LIFE: 1500 CYCLES MIN.;
- PLATING:
  - TERMINAL:
    - NI PLATING OVER ALL,
    - Tin PLATING ON SOLDER AREA,
    - Au G/Fu" ON CONTACT AREA;
  - SHELL: NI PLATING OVER ALL;
- ENVIRONMENTAL:
  - STORAGE TEMPERATURE RANGE: -40°C~+85°C;
  - OPERATION TEMPERATURE RANGE: -25°C~+70°C;

# 富港电子

|   |                        |              |              |
|---|------------------------|--------------|--------------|
| UNLESS OTHERWISE SPECIFIED:<br>X.xxx ±0.10<br>X.xx ±0.20<br>X.x ±0.30 | NAME:                  | P/N:         |              |
|   | <b>3.0 A母沉板直脚卷边B款</b>  | ST-003-008-J |              |
| ANGULAR:<br>X.xx° ±1°<br>X.x° ±3°<br>X.° ±5°                          | THIRD ANGLE PROJECTION | UNIT:        | SCALE:       |
|   |                        | mm           | 1:1          |
| DRAWN:  | CHECKED:               | SIZE:        | SHEET: REV.: |
|   |                        | A4           | 1/1 A1       |
|   |                        | APPROVED     |              |