

序号	名称	材料
1	接触件	黄铜 (镀锡)
2	基座	LCP (UL94-0)
3	焊片	磷青铜 (镀锡)

- Current rating: 1A AC/DC (AWG #26)
 - Voltage rating: 50V AC/DC
 - Temperature range: -25°C to 85°C
 - Contact resistance: Initial value/20mΩ max
Electrical properties
 - Insulation resistance: 100MΩ min
 - Withstanding voltage: 500V AC/minute
 - Applicable wire: AWG #30 to #26
- Environmental controls
- Banned contains SS - 00259 are restricted substances.
 - The corresponding issued by SGS or ITS Isp-aes data, Not the material in a list, and validity.

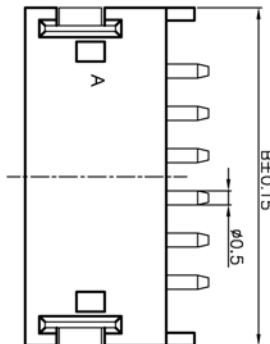
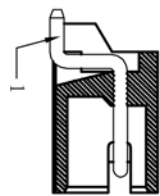
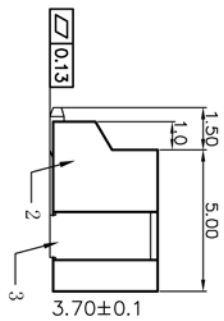
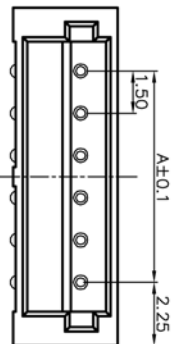
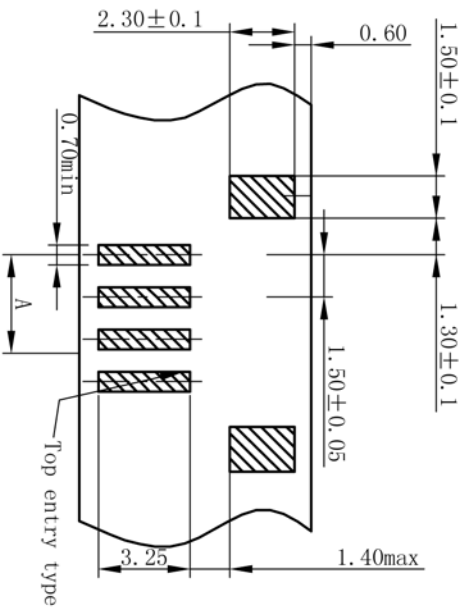

版次	日期	内容
A1	08-05-01	

孔位 poles	A	B
2	1.50	6.00
3	3.00	7.50
4	4.50	9.00
5	6.00	10.50
6	7.50	12.00
7	9.00	13.50
8	10.50	15.00
9	12.00	16.50
10	13.50	18.00
11	15.00	19.50
12	16.50	21.0
13	18.00	22.5
14	19.50	24.0
15	21.00	25.5

博穆电子有限公司

尺寸公差	角度公差	品名: ZH1AWB	设计
.X ±0.1	.X° ±0.1°	图号:	审核
.XX ±0.05	.XX° ±0.05°	比例: --	批准
.XXX ±0.005	.XXX° ±0.005°	页数: 1/1	版本: A