

| linear dimension(Tolerances Standard GB/T 14486-2008) |       |              |               |               |                |                 |             | —     | $\nabla$       | $\perp$     |
|---|-------|--------------|---------------|---------------|----------------|-----------------|-------------|-------|----------------|-------------|
| variable range  | to 6  | over 6 to 10 | over 10 to 30 | over 30 to 60 | over 60 to 100 | over 100 to 160 | over 160 to | to 10 | over 10 to 100 | over 100 to |
| tolerance   | ±0.20 | ±0.30        | ±0.50         | ±0.70         | ±1.00          | ±1.30           | ±1.60       | 0.10  | 0.30           | 0.60        |

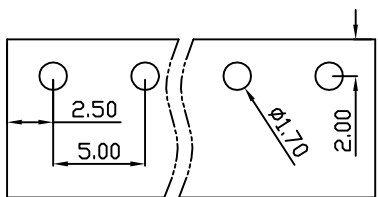

PCB Layout

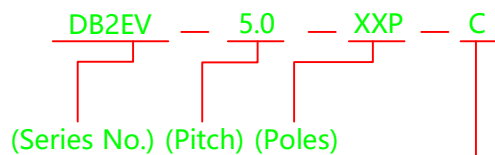
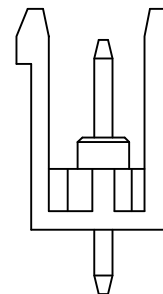
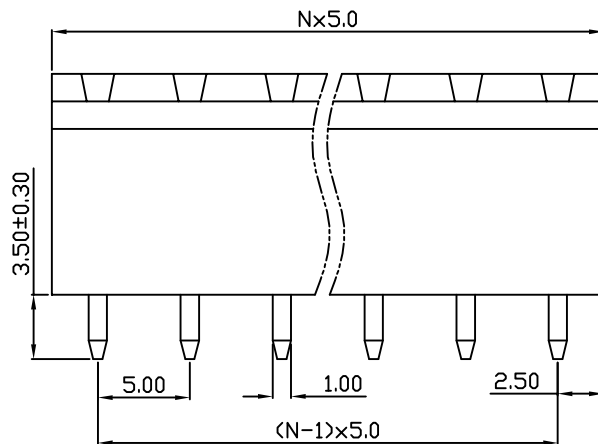
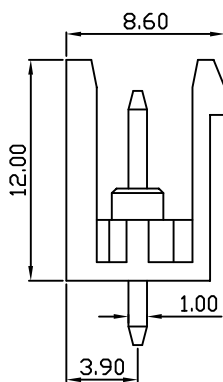
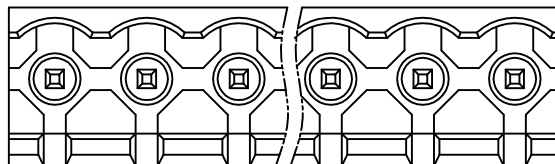

(Color):GN:(Green), BK:(Black), BU:(Blue), RD:(Red), GY:(Gray)  
OG:(Orange), WT:(White), YL:(Yellow), CR:(Clear)

APPD: J Ting Chen 2022.11.21  
CHKD: Duck Mao 2022.11.21  
DRFT: Steven Lu 2022.11.21

| UL/CUL 技术参数 |                                   | UL/CUL Technical Data |     |     |
|-------------|-----------------------------------|-----------------------|-----|-----|
| 等级          | Use Group                         | B                     | C   | D   |
| 额定电压        | Rated Voltage [V]                 | 300                   | -   | 300 |
| 额定电流        | Rated Current [A]                 | 15                    | -   | 10  |
| 接线范围        | Wire Range                        | -                     |     |     |
| 单/多芯线       | Solid/Stranded [AWG]              |                       |     |     |
| 耐电压         | Withstanding Voltage              | 1600V/1Min            |     |     |
| IEC 技术参数    |                                   | IEC Technical Data    |     |     |
| 过电压类别       | Overvoltage Category              | III                   | III | II  |
| 污染等级        | Contamination Class               | 3                     | 2   | 2   |
| 额定电压        | Rated Voltage [V]                 | 250                   | 320 | 630 |
| 额定电流        | Rated Current [A]                 | 15                    | 15  | 15  |
| 额定冲击电压      | Impulse withstand voltagea [KV]   | 4                     | 4   | 4   |
| 导线截面积       | Conductor cross section           | -                     |     |     |
| 硬质/柔性导线     | Solid/flexible [mm <sup>2</sup> ] |                       |     |     |
| 材料          |                                   | Material              |     |     |
| 绝缘材料        | Insulation Material               | PA66                  |     |     |
| 阻燃等级        | Imflamability                     | UL94V-0               |     |     |
| 导体材料        | Contacto Material                 | 铜合金 Copper alloy      |     |     |
| 导体表面镀层      | Contactive Coating                | 镀锡 Sn Plated          |     |     |
| 一般参数        |                                   | Other Data            |     |     |
| 间距          | Pitch [mm]                        | 5.0                   |     |     |
| 极数          | Poles [P]                         | 02~24                 |     |     |
| 剥线长度        | Stripping Length [mm]             | -                     |     |     |
| 螺丝          | Screw/扭矩 Torque(Max) [N.m]        | -                     |     |     |
| 工作温度        | Operating temperatur [°C]         | -40~+105              |     |     |
| 引针尺寸        | Pin Dimensions [mm]               | 1.0x1.0               |     |     |
| PCB板孔径      | PCB Hole Diameter [mm]            | 1.70                  |     |     |

**DORABO**

宁波地博电气有限公司  
Ningbo Dorabo Electric CO., Ltd

NAME:

DB2EV-5.0-XXP-C



SIZE: A4

mm  
(inch)

REV

T0-1

TYPE: CUSTOMER\_DRAWING

SCALE: 1:1

SHEET

1/1