

ROHS

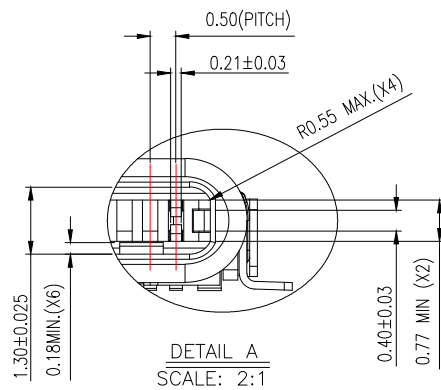
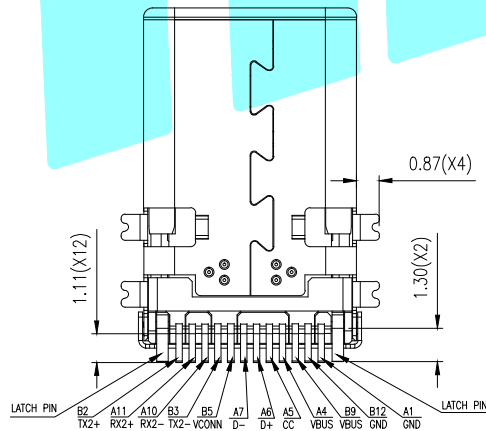
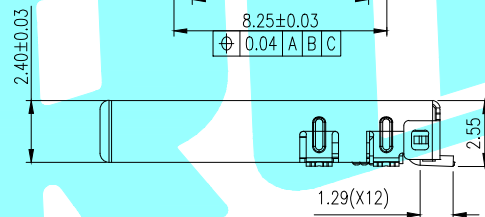
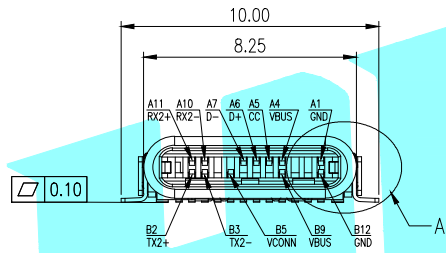
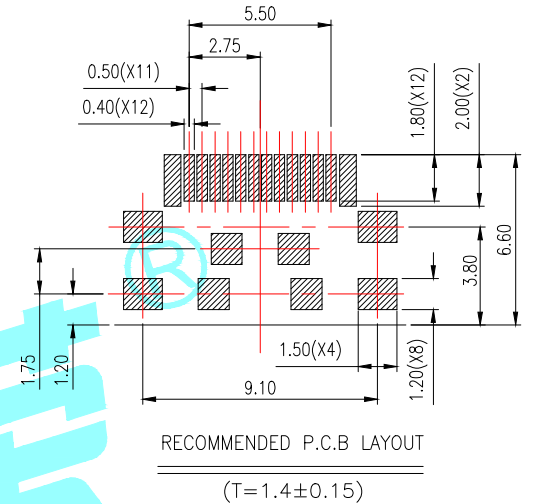
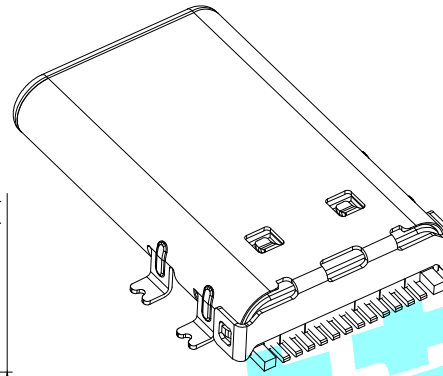
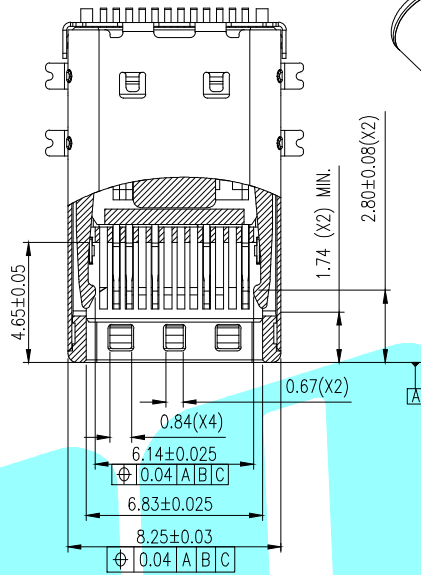
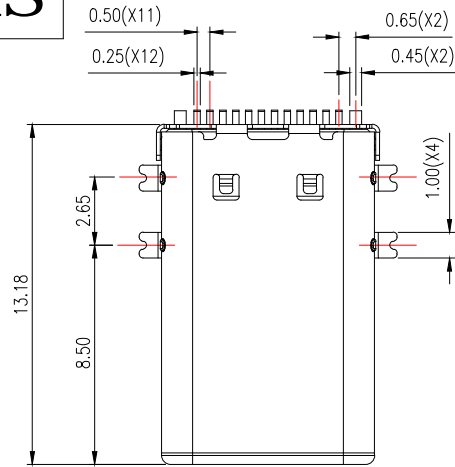

NOTES:

1. MATERIALS:

- SHELL: STAINLESS STEEL, T=0.15±0.01mm
- SPRING: STAINLESS STEEL, T=0.10±0.01mm
- LATCH: STAINLESS STEEL, T=0.40±0.01mm
- HOUSING: THERMOPLASTIC
- MOLDING1: HIGH-THERMOPLASTIC+ BRONZE, T=0.20±0.01mm
- MOLDING2: HIGH-THERMOPLASTIC+ BRONZE, T=0.20±0.01mm

2. PLATING:

- CONTACT: CONTACT AREA Au PLATED 30u"Min. OR REFER TO THE PART NO. CODE DEFINED. UNDER PLATE 80u"Min. NICKEL OVERALL. 120u" Min. TIN PLATING ON SOLDER TAIL
- SHELL: 30u"Min. NICKEL PLATING OVERALL

3. ELECTRICAL PERFORMANCE:

- INSULATION RESISTANCE: 100Mohm MIN.
- CONTACT RESISTANCE: 40mohm MAX.
- DIELECTRIC WITHSTANDING: 100 VAC
- CURRENT RATING: 3A MIN.

4. MECHANICAL PERFORMANCE:

- MATING FORCE: 5~20N
- UNMATING FORCE: 8~20N
- DURABILITY: 10000 CYCLES

APPROVALS		DATE		 ELECTRONICS CO.,LTD			
DRAWN	LIUCAN	2021.7.24					
CHECKED				PART NO.		TYPE-C-31-G-10	
APPROVALS				UNIT: mm		SCALE: 1:1	PROJ:
TOLERANCES ARE				30~以上 ±0.30	ANGLE	±2'	DRAWING NO.
				10~30 ±0.20			
				5~10 ±0.15			
				~ 5 ±0.10	SHEET 1 OF 1		

ECN NO.	REV.	DATE.	NEW	DESCRIPTION.	CHANGE.	CHECK.	APPRO.
---------	------	-------	-----	--------------	---------	--------	--------