

# ROHS

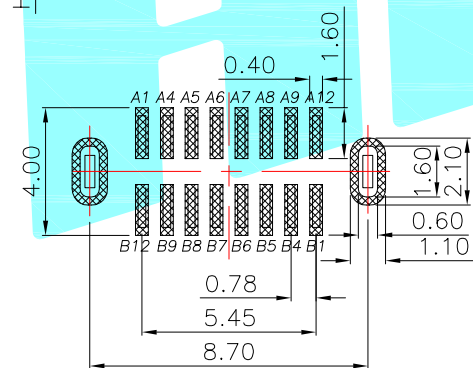
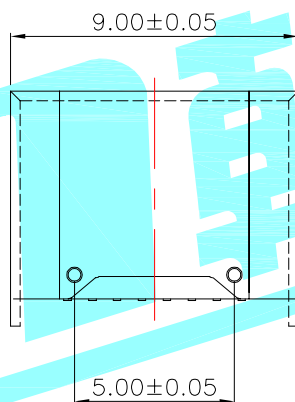
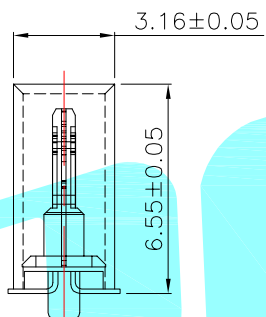
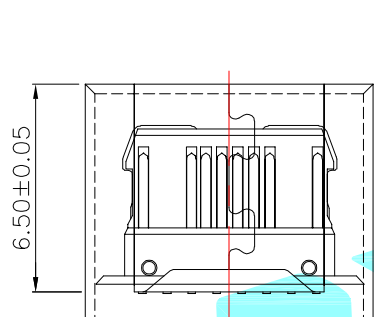
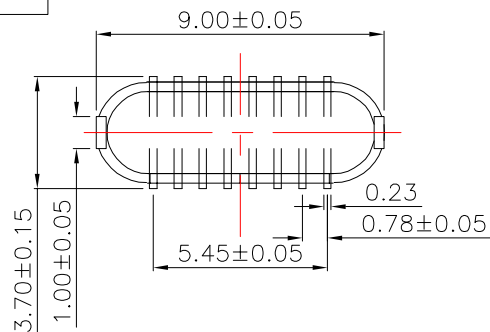

PIN	SIGNAL NAME	PIN	SIGNAL NAME
A1	GND	B12	GND
A4	Vbus	B9	Vbus
A5	CC1	B8	SBU2
A6	D+	B7	D-
A7	D-	B6	D+
A8	SBU1	B5	CC2
A9	Vbus	B4	Vbus
A12	GND	B1	GND

NOTE:

- MATERIAL SPECIFICATION:
  - HOUSING: LCP, BLACK.
  - CONTACTS: COPPER ALLOY, Ni/Au PLATED
  - FRONT SHELL: STAINLESS STEEL, Ni PLATED
  - MID-PLATE: STAINLESS STEEL
- MECHANICAL PERFORMANCE,
  - INSERTION FORCE: 5~20N.
  - REMOVAL FORCE: 5~20N.
  - LIFE: 10000 CYCLES.
- ELECTRICAL PERFORMANCE,
  - RATING: 5.0A 20V AC.
  - INSULATION RESISTANCE: 100MΩ MIN
  - DIELECTRIC WITHSTAND VOLTAGE, AC 250V
- ENVIRONMENTAL PERFORMANCE:
  - OPERATING TEMPERATURE: -40°C~+85°C.

PART NO	H
TYPE-C-31-D-11	1.2
TYPE-C-31-D-11A	0.8

RECOMMENDED PCB LAYOUT(TOP VIEW)

APPROVALS		DATE	HRC® ELECTRONICS CO.,LTD			
DRAWN	LIUCAN	2021.7.18	TITLE:	USB CONNECTOR		
CHECKED			APPROVALS	PART NO.		
TOLERANCES ARE		30~以上 ±0.30	ANGLE	UNIT: mm	SCALE: 1:1	PROJ:
		10~30 ±0.25		DRAWING NO.		SHEET 1 OF 1
		5~10 ±0.20				
		~ 5 ±0.15				

ECN NO.	REV.	DATE.	DESCRIPTION.	CHANGE.	CHECK.	APPRO.
	A1	2022.7.27	完善PIN脚定义		LIUCAN	
	A		NEW			