

| linear dimension(Tolerances Standard GB/T 14486-2008) | | | | | | | | — ▯ ⊥ | | |
|---|-------|---------|----------|----------|-----------|------------|--------|-------|-----------|--------|
| variable range | to | over | over | over | over | over | over | to | over | over |
| | 6 | 6 to 10 | 10 to 30 | 30 to 60 | 60 to 100 | 100 to 160 | 160 to | | 10 to 100 | 100 to |
| tolerance | ±0.20 | ±0.30 | ±0.50 | ±0.70 | ±1.00 | ±1.30 | ±1.60 | 0.10 | 0.30 | 0.60 |

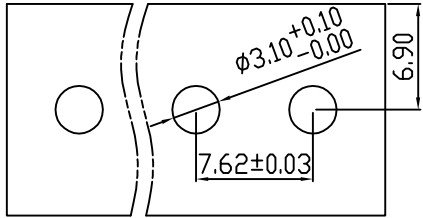

PCB LAYOUT

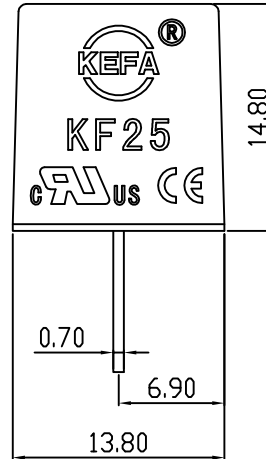
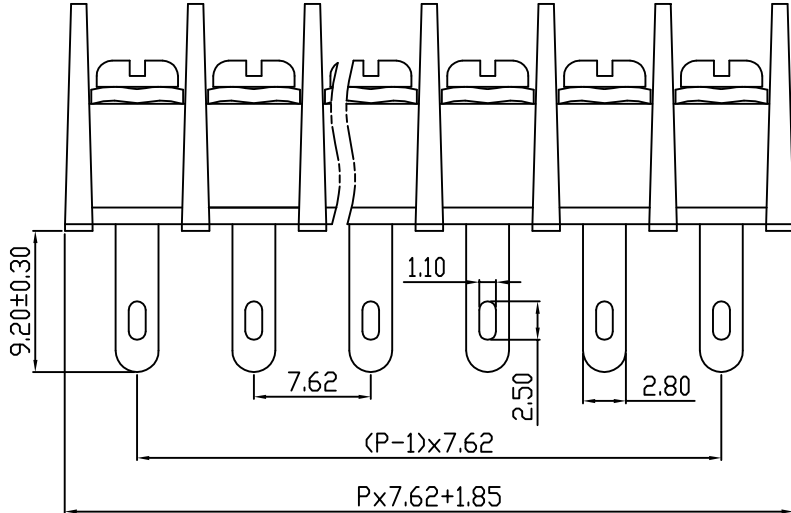
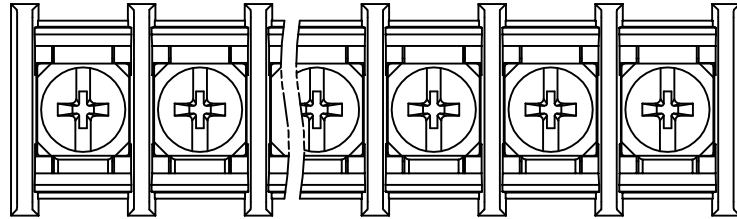

KF25



REVISION RECORD

| REV. | DESCRIPTION | ECN No. | APPROVED | DATE |
|------|-------------|---------|----------|----------|
| A | 新发行 | | CLF | 21.09.11 |
| | | | | |
| | | | | |

| UL/CUL 技术参数 UL/CUL Technical Data | | | | |
|--|--|------------------|---|---|
| 等级 Use Group | | B | C | D |
| 额定电压 Rated Voltage [V] | | 300 | - | - |
| 额定电流 Rated Current [A] | | 20 | - | - |
| 接线范围 Wire Range 单/多芯线 Solid/Stranded [AWG] | | 22-12 | | |
| IEC 技术参数 IEC Technical Data | | | | |
| 额定电压 Rated Voltage [V] | | 250 | | |
| 额定电流 Rated Current [A] | | 24 | | |
| 耐电压 Withstanding Voltage [V/1Min] | | 2000V/1Min | | |
| 导线截面积 Conductor cross section 硬质/柔性导线 Solid/flexible [mm ²] | | 2.5 | | |
| 材料 Material | | | | |
| 绝缘材料 Insulation Material | | PA66 | | |
| 阻燃等级 Imflammability | | UL94V-0 | | |
| 导体材料 Contactor Material | | 铜合金 Copper alloy | | |
| 导体表面镀层 Contactive Coating | | 镀锡 Tin Plated | | |
| 一般参数 Other Data | | | | |
| 间距 Pitch [mm] | | 7.62 | | |
| 极数 Poles [P] | | 02~24 | | |
| 剥线长度 Stripping Length [mm] | | - | | |
| 螺丝 Screw/扭矩 Torque(Max) [N.m] | | M3/0.8 | | |
| 工作温度 Operating temperatur [°C] | | -40~+105 | | |
| 引针尺寸 Pin Dimensions [mm] | | 9.2 | | |
| PCB板孔径 PCB Hole Diameter [mm] | | 3.1 | | |

| | | | | | | | | | | | | |
|------|-----|------|----------|--|----|---------|----|-------------------------------|-----|-----------------------------|--------|---|
| DES. | LQQ | DATE | 21.09.11 | 单位/UNITS | mm | 尺寸/SIZE | A4 | 比例/SCALE | 1:1 | 第三视角/THIRD ANGLE PROJECTION | 版本/REV | A |
| CHK. | BY | DATE | 21.09.11 | 慈溪市科发电子有限公司 CIXI KEFA ELECTRONIC CO., LTD | | | | 名称/TITLE KF25H-7.62 | | | | |
| APP. | CLF | DATE | 21.09.11 | | | | | | | | | |