

CIRCUIT DIAGRAM

1. Maximum rating: 50mA 12V DC
1.最大额定值: 50mA 12V DC
Minimum rating: 10μA 1V DC
最小额定值: 10μA 1V DC
2. Insulation resistance: ≥ 100M Ω
2.绝缘电阻: ≥100MΩ
3. Contact resistance: ≤ 100m Ω
3.接触电阻: ≤100mΩ
4. Withstand voltage: 250V AC
4.耐压: 250V AC
5. Operating temperature: - 20 °C ~ + 70 °C
5.使用温度: -20°C ~ + 70°C
6. Action force: 260 ± 50gf
6.动作力: 260±50gf
7. Service life: 1,000,000 times
7.寿命: 1,000,000次
8. Stroke: 0.35 ± 0.10mm
8.行程: 0.35±0.10mm

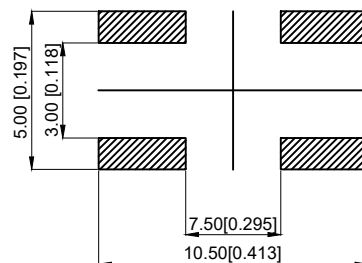

P.C.B LAND DIMENSION

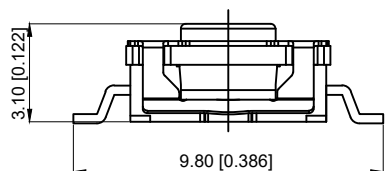
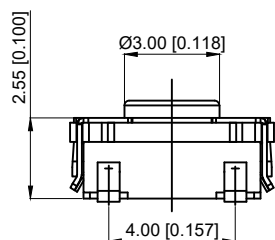

6	Terminal 端子	BASS 黄铜	4	Ag plating 镀银
5	Housing 外壳	SUS	1	
3	Handle 按柄	silica gel 硅胶	1	Blue 蓝色
2	Shrapnel 弹片	SUS	1	Ag plating 镀银
1	Base 基座	PA46	1	Black 黑色
NO 序号	Part name 部件名	Material 材料	QTY 数量	Remark 备注

A4				<p>台普 ROCPCU</p>	COMMON TOLERANCE	UNIT	MM	PROJECTED		PRODUCT NAME:		
A3					X.XX	± 0.10	DRAWN BY	FUYUAN		CHECKED BY	COCO	MODEL NO: TP11222631
A2					X.X	± 0.15	DATE	2019		APPROVAL B	ALEN	Https: www.rocpcu.tw
A1					X	± 0.25	<h1>ROCPCU TECHNOLOGY CO.,LTD</h1>					
REV	DATE	REVISION	DESCRIPTION		ISSUE	ANGULAR					Copies are issued in strict confidence and shall not be reproduced or copied, or used as the basic of manufacture or sale of apparatus without permission	
	A		B		C	D	E	F	G			