

REV.	LOCAS.	DESCRIPTION	DATE	DRAWN
01	NEW	BATCH PRODUCTION INITIAL RELEASE.	2011.11.14	李芳忠
02	△	依業務要求增加車載料號	2019.10.17	何東華

Specifications

Current Ratings: 3Amp
 Insulation Resistance: 1000MΩMin.
 Dielectric Withstanding Voltage: 600VAC
 Contact Resistance: 20mΩMax.
 Operating Temperature: -40°C to +105°C
 Materials
 Contact Material: Brass
 Insulator Material: High Temperature Thermoplastic, UL 94V-0 Nylon 6T (Halogen Free) or the equivalent material
 ☆ All materials must meet Greenconn requirement for environment protection.
 ★ "": Critical Characteristics, indicates product characteristics, functionalities, and manufacturing processes regarding to customer's specifications

☆ ☆: Safety Features indicates product characteristics, functionalities, and manufacturing processes complying to legal regulations stated by local government

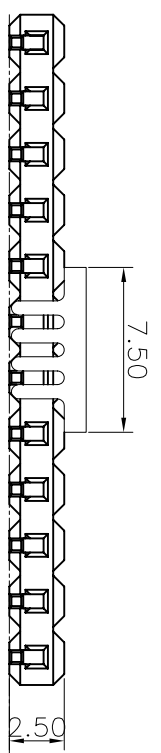

2.54 X No. of Positions+0.50

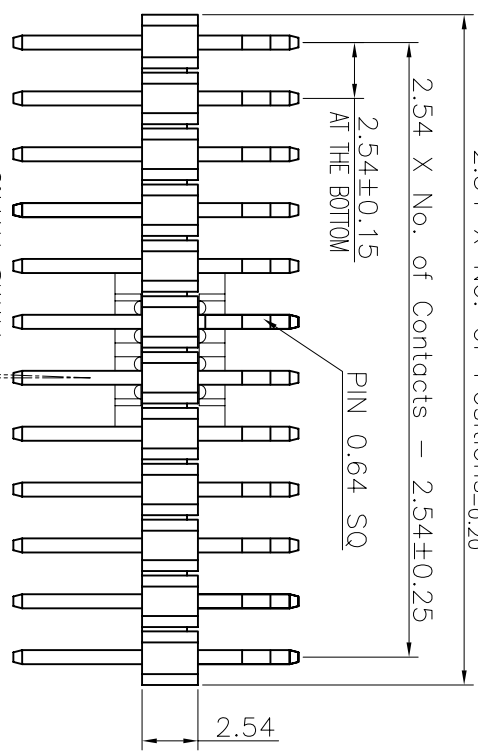
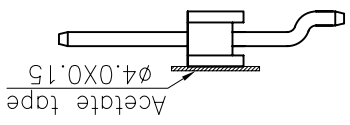
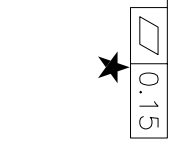

2°MAX SWAY (EITHER DIRECTION AT THE TOP)

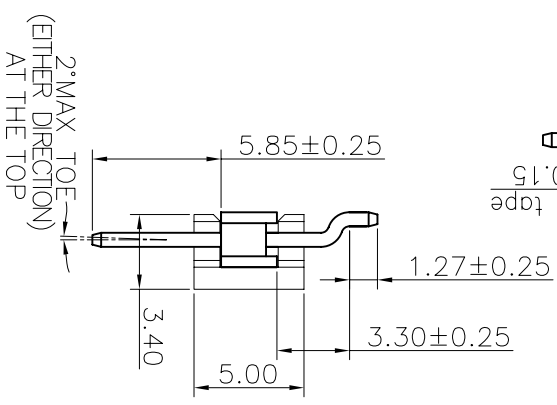

2°MAX TOE (EITHER DIRECTION AT THE TOP)

Ordering Information

G PHD101 - XX XX A 037 R 1 B X

No. of Pins per Row
02~40

Standard Plating
02=Gold Flash
Selective Plating
01=Tin
05=Gold Flash/Tin

Color
1=Black

Standard Packing
C=Tube
Selective Packing
A=Box
E=CAP+Tube
F=CAP+Tape&Reel
G=Acetate Tape+Tube
H=Acetate Tape+Tape&Reel

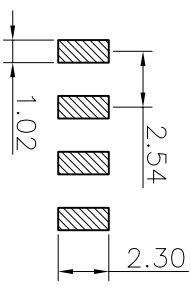

Recommended P.C.Board
Layout
(Tolerance: ±0.05)

Greenconn P/N	Customer	Remarks
△ GPHD101-0822A037R1BH	A007	Automotive Connector

格 菱 股 份 有 限 公 司
Greenconn Corporation

GENERAL TOLERANCE	X: ±5.0°	X: ±0.30
X: ±3.0°	X: ±0.25	
.XX: ±2.0°	.XX: ±0.15	
.XXX: ±1.0°	.XXX: ±0.10	

DESIGNED:	何東華	DATE:	2019.10.17
CHECKED:		DATE:	
CO SIGNED:	廖世龍	DATE:	2019.10.17
APPROVED:		DATE:	

DWG. NO.	GPHD101-CA37RB
PART NO.	GPHD101-XXXX A037R1BX

TITLE:
2.54 PIN HEADER
SINGLE ROW ENTRT SIDE
CONNECTOR

REV. 02
UNIT. mm
SCALE. 3:1
PAGE. 1/1

1 2 3 4 5 6 7 8 9