

Engineer Drawing

Electrical

Voltage: 50 V AC(rms)/DC
 Current: 0.5A AC(rms)/DC
 Contact Resistance: 40 mΩ max(initial)
 Dielectric Withstanding Voltage: 200 V AC/rms
 Insulation Resistance: 500 MΩ min
 Operating Temp: -40°C +105°C

MATERIAL:

HOUSING: LCP NATURE (UL94V-0)

TERMINAL: PHOSPHOR BRONZE C5191R-H

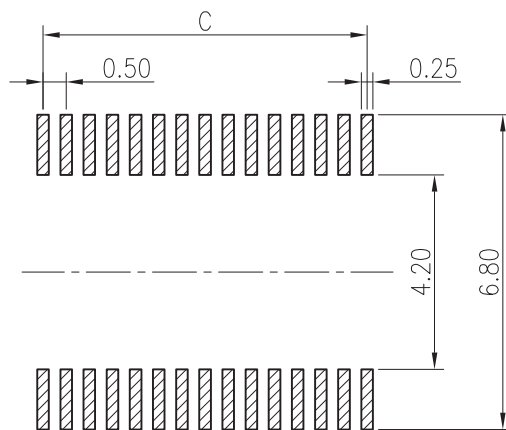
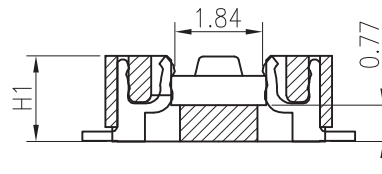
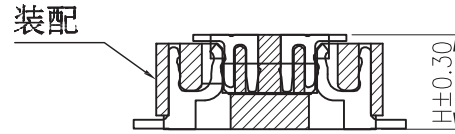
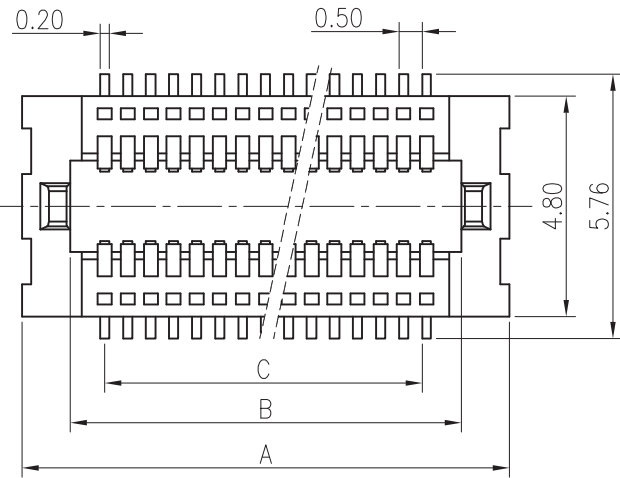

IPCB05XX1* ** * * *
 ① ② ③ ④ ⑤ ⑥
 ① Series Type ④ Serial code
 ② Type ⑤ Company code.
 ③ Pin code. ⑥ Serial code

P 数	尺 寸			P 数	尺 寸		
	A	B	C		A	B	C
10	5.60	3.50	2.00	54	16.60	14.50	13.00
12	6.10	4.00	2.50	56	17.10	15.00	13.50
14	6.60	4.50	3.00	58	17.60	15.50	14.00
16	7.10	5.00	3.50	60	18.10	16.00	14.50
18	7.60	5.50	4.00	62	18.60	16.50	15.00
20	8.10	6.00	4.50	64	19.10	17.00	15.50
22	8.60	6.50	5.00	66	19.60	17.50	16.00
24	9.10	7.00	5.50	68	20.10	18.00	16.50
26	9.60	7.50	6.00	70	20.60	18.50	17.00
28	10.10	8.00	6.50	72	21.10	19.00	17.50
30	10.60	8.50	7.00	74	21.60	19.50	18.00
32	11.10	9.00	7.50	76	22.1	20.00	18.50
34	11.60	9.50	8.00	78	22.60	20.50	19.00
36	12.10	10.00	8.50	80	23.10	21.00	19.50
38	12.60	10.50	9.00				
40	13.10	11.00	9.50				
42	13.60	11.50	10.00				
44	14.10	12.00	10.50				
46	14.60	12.50	11.00				
48	15.10	13.00	11.50				
50	15.60	13.50	12.00				
52	16.10	14.00	12.50				

HIGH	SOCKET (H1)
1.50	1.35
2.00	1.85
2.50	2.35

TOLERANCE X ±0.5 XX ±0.25 X ±0.35 XXX ±0.15 ANGLES ± 0.3°			www.i-ncp.com	
	PART NO. IPCB05XX1 xx		TITLE: 0.5mm Borad to Borad	
	DRAWING NO. IPCB05XX1		H=1.5/2.0/2.5mm Female	
UNLESS OTHERWISE SPECIFIED			SHEET 1 OF 1	UNITS mm SCALE 1:1 REV. 01