

YXS series

105°C 3000~6000時間品 小形化 低インピーダンス品
Load Life : 105°C 3000~6000 hours. Miniaturized, Low Impedance

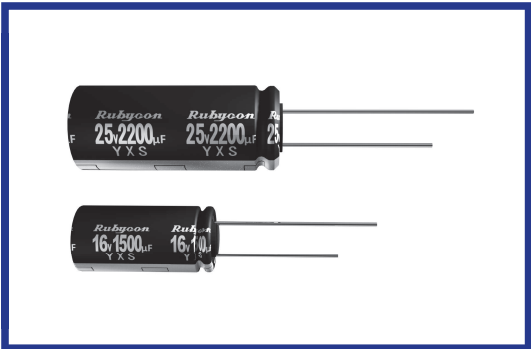

◆規格表/SPECIFICATIONS

| 項目 Item | 特性 Characteristics | | | | | | | |
|--|---|--|------|------|------|------|---------------------|----------------------|
| カテゴリ温度範囲 Category Temperature Range | -40~+105°C | | | | | | | |
| 定格電圧範囲 Rated Voltage Range | 6.3~50Vdc | | | | | | | |
| 静電容量許容差 Capacitance Tolerance | ±20%(20°C, 120Hz) | | | | | | | |
| 漏れ電流 Leakage Current (MAX) | I=0.01CV又は3µAのいずれか大なる値以下(定格電圧印加2分後) I=0.01CV or 3µA whichever is greater. (After 2 minutes) I=漏れ電流(µA) C=静電容量(µF) V=定格電圧(Vdc) Leakage Current Capacitance Rated Voltage | | | | | | | |
| 損失角の正接(tan δ) Dissipation Factor (MAX) | 定格電圧(Vdc) Rated Voltage | 6.3 | 10 | 16 | 25 | 35 | 50 | (20°C, 120Hz) |
| | tan δ | 0.22 | 0.19 | 0.16 | 0.14 | 0.12 | 0.10 | |
| 1000µFを越えるものは1000µF増す毎に上表の値に0.02を加えた値とする。 When capacitance is over 1000µF, tan δ shall be added 0.02 to the listed value with increase of every 1000µF. | | | | | | | | |
| 耐久性 Endurance | 105°C中で右表の時間定格電圧(リップル重畳)印加後、下記項目を満足すること。 After applying rated voltage with rated ripple current for specified time at 105°C, the capacitors shall meet the following requirements. | | | | | | | |
| | 静電容量変化率 Capacitance Change | 初期値の±25%以内(6.3Vdc, 10Vdc: ±30%) Within ±25% of the initial value(6.3Vdc, 10Vdc: ±30%) | | | | | ケースサイズ Case Size | 時間(hrs) Time(hrs) |
| | 損失角の正接 Dissipation Factor | 規格値の200%以下 Not more than 200% of the specified value. | | | | | 5×11 | 3000 |
| | 漏れ電流 Leakage Current | 規格値以下 Not more than the specified value. | | | | | 6.3×11, 8×11.5 | 4000 |
| 低温特性 Low Temperature Stability (インピーダンス比) Impedance Ratio (MAX) | 定格電圧(Vdc) Rated Voltage | 6.3 | 10 | 16 | 25 | 35 | 50 | (120Hz) |
| | Z(-25°C)/Z(+20°C) | 4 | 3 | 2 | 2 | 2 | 2 | |
| | Z(-40°C)/Z(+20°C) | 8 | 6 | 4 | 3 | 3 | 3 | |

◆呼称方法/PART NUMBER

YXS M D x L
 定格電圧 シリーズ名 静電容量 静電容量許容差 副記号 リード加工記号 ケースサイズ
 Rated Voltage Series Capacitance Capacitance Tolerance Option Lead Forming Case Size

◆リップル電流補正係数/
MULTIPLIER FOR RIPPLE CURRENT

| 周波数(Hz) Frequency | 120 | 1k | 10k | 100k≤ |
|----------------------|------|------|------|-------|
| 22~33µF | 0.42 | 0.70 | 0.90 | 1.00 |
| 47~270µF | 0.50 | 0.73 | 0.92 | 1.00 |
| 330~680µF | 0.55 | 0.77 | 0.94 | 1.00 |
| 820~1800µF | 0.60 | 0.80 | 0.96 | 1.00 |
| 2200~22000µF | 0.70 | 0.85 | 0.98 | 1.00 |

◆副記号/OPTION

EFG : PETスリーブ PET Sleeve

◆寸法図／DIMENSIONS

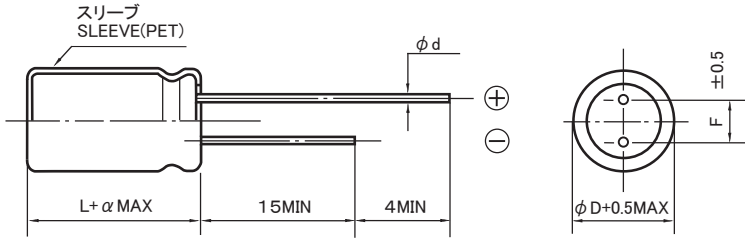

| (mm) | | | | | | | |
|----------|---|-----|-----|-----|------|-----|----|
| ϕD | 5 | 6.3 | 8 | 10 | 12.5 | 16 | 18 |
| ϕd | 0.5 | | 0.6 | | | 0.8 | |
| F | 2.0 | 2.5 | 3.5 | 5.0 | | 7.5 | |
| α | $L \leq 16 : \alpha = 1.5 \quad L \geq 20 : \alpha = 2.0$ | | | | | | |

◆標準品一覧表／STANDARD SIZE

| 定格電圧 Rated Voltage (Vdc) | 静電容量 Capacitance (μF) | 外形寸法 Size $\phi D \times L$ (mm) | 定格リップル 電流 Rated Ripple Current | インピーダンス (Ω MAX) Impedance | |
|--------------------------------|------------------------------------|--|---|---|---------------|
| | | | | 20°C, 100kHz | -10°C, 100kHz |
| | | | | 6.3 | 150 |
| | 220 | 5×11 | 210 | 0.58 | 2.3 |
| | 330 | 6.3×11 | 340 | 0.22 | 0.87 |
| | 470 | 6.3×11 | 340 | 0.22 | 0.87 |
| | 680 | 8×11.5 | 730 | 0.12 | 0.48 |
| | 820 | 8×16 | 1050 | 0.069 | 0.27 |
| | 1000 | 8×11.5 | 730 | 0.120 | 0.48 |
| | 1200 | 8×16 | 1050 | 0.069 | 0.27 |
| | 1200 | 10×12.5 | 1210 | 0.060 | 0.24 |
| | 1500 | 10×16 | 1450 | 0.046 | 0.18 |
| | 1800 | 10×20 | 1720 | 0.037 | 0.15 |
| | 2200 | 10×20 | 1720 | 0.037 | 0.15 |
| | 2700 | 10×23 | 1910 | 0.031 | 0.12 |
| | 2700 | 12.5×16 | 1730 | 0.04 | 0.12 |
| | 3300 | 12.5×16 | 1730 | 0.04 | 0.12 |
| | 3900 | 12.5×20 | 2160 | 0.028 | 0.089 |
| | 3900 | 16×16 | 1940 | 0.042 | 0.110 |
| | 4700 | 12.5×25 | 2650 | 0.024 | 0.065 |
| | 5600 | 12.5×25 | 2650 | 0.024 | 0.065 |
| | 5600 | 12.5×30 | 2880 | 0.020 | 0.065 |
| | 6800 | 12.5×35 | 3350 | 0.017 | 0.063 |
| | 6800 | 16×20 | 2540 | 0.021 | 0.06 |
| | 8200 | 16×25 | 3060 | 0.017 | 0.05 |
| | 10000 | 16×31.5 | 3610 | 0.017 | 0.044 |
| | 10000 | 18×20 | 2860 | 0.026 | 0.060 |
| | 12000 | 16×35.5 | 4080 | 0.015 | 0.038 |
| | 12000 | 18×25 | 3140 | 0.019 | 0.045 |
| | 15000 | 18×31.5 | 4170 | 0.015 | 0.038 |
| | 18000 | 18×35.5 | 4280 | 0.014 | 0.032 |
| | 22000 | 18×40 | 4550 | 0.012 | 0.030 |
| 10 | 100 | 5×11 | 210 | 0.58 | 2.3 |
| | 220 | 5×11 | 210 | 0.58 | 2.3 |
| | 220 | 6.3×11 | 340 | 0.22 | 0.87 |
| | 470 | 6.3×11 | 340 | 0.22 | 0.87 |
| | 680 | 8×11.5 | 730 | 0.12 | 0.48 |
| | 680 | 8×16 | 1050 | 0.069 | 0.27 |
| | 1000 | 8×16 | 1050 | 0.069 | 0.27 |
| | 1000 | 10×12.5 | 1210 | 0.060 | 0.24 |
| | 1200 | 10×16 | 1450 | 0.046 | 0.18 |
| | 1500 | 8×20 | 1650 | 0.042 | 0.17 |
| | 1500 | 10×16 | 1450 | 0.046 | 0.18 |
| | 1500 | 10×20 | 1720 | 0.037 | 0.15 |
| | 1800 | 10×20 | 1720 | 0.037 | 0.15 |
| | 2200 | 10×23 | 1910 | 0.031 | 0.12 |
| | 2200 | 12.5×16 | 1730 | 0.04 | 0.12 |

Rated Ripple Current (mA r.m.s./105°C, 100kHz)

| 定格電圧 Rated Voltage (Vdc) | 静電容量 Capacitance (μF) | 外形寸法 Size $\phi D \times L$ (mm) | 定格リップル 電流 Rated Ripple Current | インピーダンス (Ω MAX) Impedance | |
|--------------------------------|------------------------------------|--|---|---|---------------|
| | | | | 20°C, 100kHz | -10°C, 100kHz |
| | | | | 10 | 2700 |
| | 3300 | 12.5×20 | 2160 | 0.028 | 0.089 |
| | 3900 | 12.5×25 | 2650 | 0.024 | 0.065 |
| | 4700 | 12.5×30 | 2880 | 0.020 | 0.065 |
| | 5600 | 12.5×35 | 3350 | 0.017 | 0.063 |
| | 5600 | 16×20 | 2540 | 0.021 | 0.060 |
| | 6800 | 16×25 | 3060 | 0.017 | 0.050 |
| | 6800 | 18×20 | 2860 | 0.026 | 0.060 |
| | 8200 | 16×31.5 | 3610 | 0.017 | 0.044 |
| | 8200 | 18×25 | 3140 | 0.019 | 0.045 |
| | 10000 | 16×35.5 | 4080 | 0.015 | 0.038 |
| | 10000 | 18×31.5 | 4170 | 0.015 | 0.038 |
| | 12000 | 18×35.5 | 4280 | 0.014 | 0.032 |
| | 15000 | 18×40 | 4550 | 0.012 | 0.030 |
| 16 | 56 | 5×11 | 210 | 0.58 | 2.3 |
| | 120 | 5×11 | 210 | 0.58 | 2.3 |
| | 330 | 6.3×11 | 340 | 0.22 | 0.87 |
| | 470 | 8×11.5 | 730 | 0.12 | 0.48 |
| | 470 | 8×16 | 1050 | 0.069 | 0.27 |
| | 680 | 8×16 | 1050 | 0.069 | 0.27 |
| | 680 | 10×12.5 | 1210 | 0.060 | 0.24 |
| | 1000 | 8×20 | 1650 | 0.042 | 0.17 |
| | 1000 | 10×16 | 1450 | 0.046 | 0.18 |
| | 1000 | 10×20 | 1720 | 0.037 | 0.15 |
| | 1200 | 10×20 | 1720 | 0.037 | 0.15 |
| | 1500 | 10×20 | 1720 | 0.037 | 0.15 |
| | 1500 | 10×23 | 1910 | 0.031 | 0.12 |
| | 1500 | 12.5×16 | 1730 | 0.040 | 0.12 |
| | 1800 | 10×23 | 1910 | 0.031 | 0.12 |
| | 2200 | 10×25 | 2230 | 0.027 | 0.089 |
| | 2200 | 12.5×20 | 2160 | 0.028 | 0.089 |
| | 2200 | 16×16 | 1940 | 0.042 | 0.110 |
| | 2700 | 12.5×25 | 2650 | 0.024 | 0.065 |
| | 3300 | 12.5×30 | 2880 | 0.020 | 0.065 |
| | 3900 | 12.5×35 | 3350 | 0.017 | 0.063 |
| | 3900 | 16×20 | 2540 | 0.021 | 0.060 |
| | 4700 | 16×25 | 3060 | 0.017 | 0.050 |
| | 4700 | 18×20 | 2860 | 0.026 | 0.060 |
| | 5600 | 16×31.5 | 3610 | 0.017 | 0.044 |
| | 5600 | 18×25 | 3140 | 0.019 | 0.045 |
| | 6800 | 16×35.5 | 4080 | 0.015 | 0.038 |
| | 8200 | 18×31.5 | 4170 | 0.015 | 0.038 |
| | 10000 | 18×35.5 | 4280 | 0.014 | 0.032 |
| | 12000 | 18×40 | 4550 | 0.012 | 0.030 |

◆標準品一覧表／STANDARD SIZE

Rated Ripple Current (mA r.m.s./105°C, 100kHz)

| 定格電圧 Rated Voltage (Vdc) | 静電容量 Capacitance (μ F) | 外形寸法 Size ϕ DxL (mm) | 定格リップル 電流 RatedRipple Current | インピーダンス (Ω MAX) Impedance | |
|--------------------------------|-----------------------------------|---------------------------------|--|---|---------------|
| | | | | 20°C, 100kHz | -10°C, 100kHz |
| 25 | 47 | 5×11 | 210 | 0.58 | 2.3 |
| | 100 | 5×11 | 210 | 0.58 | 2.3 |
| | 220 | 6.3×11 | 340 | 0.22 | 0.87 |
| | 330 | 8×11.5 | 730 | 0.12 | 0.48 |
| | 330 | 8×16 | 1050 | 0.069 | 0.27 |
| | 390 | 8×16 | 1050 | 0.069 | 0.27 |
| | 470 | 8×16 | 1050 | 0.069 | 0.27 |
| | 470 | 10×12.5 | 1210 | 0.060 | 0.24 |
| | 560 | 8×20 | 1650 | 0.042 | 0.17 |
| | 680 | 10×16 | 1450 | 0.046 | 0.18 |
| | 680 | 10×20 | 1720 | 0.037 | 0.15 |
| | 820 | 10×20 | 1720 | 0.037 | 0.15 |
| | 1000 | 10×20 | 1720 | 0.037 | 0.15 |
| | 1000 | 10×23 | 1910 | 0.031 | 0.12 |
| | 1000 | 12.5×16 | 1730 | 0.040 | 0.12 |
| | 1200 | 16×16 | 1940 | 0.042 | 0.11 |
| | 1500 | 12.5×20 | 2160 | 0.028 | 0.089 |
| | 1800 | 12.5×25 | 2650 | 0.024 | 0.065 |
| | 2200 | 12.5×30 | 2880 | 0.020 | 0.065 |
| | 2200 | 16×20 | 2540 | 0.021 | 0.060 |
| | 2700 | 12.5×35 | 3350 | 0.017 | 0.063 |
| | 2700 | 16×20 | 2540 | 0.021 | 0.060 |
| | 3300 | 16×25 | 3060 | 0.017 | 0.050 |
| | 3300 | 18×20 | 2860 | 0.026 | 0.060 |
| | 3900 | 16×31.5 | 3610 | 0.017 | 0.044 |
| 3900 | 18×25 | 3140 | 0.019 | 0.045 | |
| 4700 | 16×35.5 | 4080 | 0.015 | 0.038 | |
| 4700 | 18×31.5 | 4170 | 0.015 | 0.038 | |
| 5600 | 18×35.5 | 4280 | 0.014 | 0.032 | |
| 6800 | 18×40 | 4550 | 0.012 | 0.030 | |
| 35 | 33 | 5×11 | 210 | 0.58 | 2.3 |
| | 56 | 5×11 | 210 | 0.58 | 2.3 |
| | 150 | 8×11.5 | 730 | 0.12 | 0.48 |
| | 220 | 8×11.5 | 730 | 0.12 | 0.48 |
| | 220 | 8×16 | 1050 | 0.069 | 0.27 |
| | 270 | 8×16 | 1050 | 0.069 | 0.27 |
| | 330 | 10×12.5 | 1210 | 0.060 | 0.24 |
| | 390 | 8×20 | 1650 | 0.042 | 0.17 |
| | 470 | 10×16 | 1450 | 0.046 | 0.18 |
| | 470 | 10×20 | 1720 | 0.037 | 0.15 |
| | 560 | 10×20 | 1720 | 0.037 | 0.15 |
| | 680 | 10×23 | 1910 | 0.031 | 0.12 |
| | 680 | 12.5×16 | 1730 | 0.040 | 0.12 |
| | 1000 | 12.5×20 | 2160 | 0.028 | 0.089 |
| | 1000 | 16×16 | 1940 | 0.042 | 0.110 |
| | 1200 | 12.5×25 | 2650 | 0.024 | 0.065 |
| | 1500 | 12.5×30 | 2880 | 0.020 | 0.065 |
| | 1800 | 12.5×35 | 3350 | 0.017 | 0.063 |
| | 1800 | 16×20 | 2540 | 0.021 | 0.060 |
| | 2200 | 16×25 | 3060 | 0.017 | 0.050 |
| 2200 | 18×20 | 2860 | 0.026 | 0.060 | |

| 定格電圧 Rated Voltage (Vdc) | 静電容量 Capacitance (μ F) | 外形寸法 Size ϕ DxL (mm) | 定格リップル 電流 RatedRipple Current | インピーダンス (Ω MAX) Impedance | |
|--------------------------------|-----------------------------------|---------------------------------|--|---|---------------|
| | | | | 20°C, 100kHz | -10°C, 100kHz |
| 35 | 2700 | 16×31.5 | 3610 | 0.017 | 0.044 |
| | 2700 | 18×25 | 3140 | 0.019 | 0.045 |
| | 3300 | 16×35.5 | 4080 | 0.015 | 0.038 |
| | 3300 | 18×31.5 | 4170 | 0.015 | 0.038 |
| | 3900 | 18×35.5 | 4280 | 0.014 | 0.032 |
| | 4700 | 18×40 | 4550 | 0.012 | 0.030 |
| | 50 | 22 | 5×11 | 210 | 0.58 |
| 56 | | 6.3×11 | 340 | 0.22 | 0.87 |
| 100 | | 8×11.5 | 730 | 0.12 | 0.48 |
| 120 | | 8×11.5 | 730 | 0.12 | 0.48 |
| 150 | | 8×16 | 910 | 0.091 | 0.36 |
| 180 | | 8×16 | 910 | 0.091 | 0.36 |
| 220 | | 10×12.5 | 1050 | 0.084 | 0.34 |
| 270 | | 10×16 | 1220 | 0.060 | 0.24 |
| 270 | | 10×20 | 1440 | 0.055 | 0.22 |
| 330 | | 10×20 | 1440 | 0.055 | 0.22 |
| 470 | | 10×23 | 1690 | 0.043 | 0.17 |
| 470 | | 12.5×16 | 1670 | 0.045 | 0.15 |
| 560 | | 12.5×20 | 1950 | 0.034 | 0.11 |
| 560 | | 16×16 | 1830 | 0.054 | 0.15 |
| 680 | | 12.5×25 | 2510 | 0.025 | 0.083 |
| 820 | | 12.5×25 | 2510 | 0.025 | 0.083 |
| 820 | | 12.5×30 | 2680 | 0.024 | 0.077 |
| 1000 | | 12.5×35 | 2920 | 0.021 | 0.069 |
| 1000 | | 16×20 | 2460 | 0.025 | 0.075 |
| 1200 | | 16×25 | 2980 | 0.022 | 0.066 |
| 1200 | | 18×20 | 2490 | 0.030 | 0.070 |
| 1500 | | 16×31.5 | 3150 | 0.019 | 0.057 |
| 1800 | | 16×35.5 | 3710 | 0.016 | 0.048 |
| 1800 | | 18×25 | 3150 | 0.022 | 0.057 |
| 2200 | | 18×31.5 | 3680 | 0.018 | 0.046 |
| 2700 | | 18×35.5 | 3800 | 0.014 | 0.038 |
| 3300 | | 18×40 | 4170 | 0.013 | 0.033 |