

SCHEMATIC (SHORTING)

PCB LAYOUT BOTTOM VIEW

1. Specification:
1. 规范:
 2. Rating: 1.0A/DC24V
 3. Contact resistance: ≤50mΩ
 4. Insulation Resistance: ≥100MΩ DC250V
 5. Compressive strength: AC250V 1minute
 6. Operating temperature: -25°C to +70°C
 7. Storage humidity: <85%RH
 8. Electrical life: 10,000Cycles
 9. Operating Force: 260±80gf

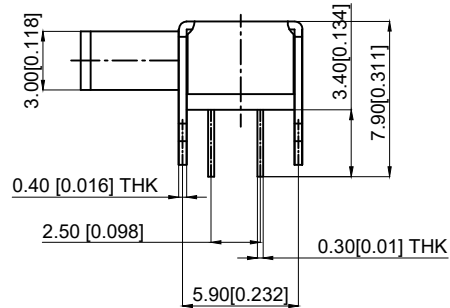
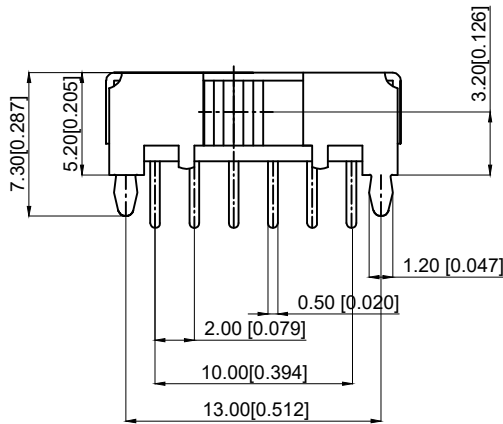

6	SPRING PLATE 簧片	PBS STRIP	1	NATURAL
5	CONTACT CLIP 接触片	PBS STRIP	4	Ag CLAD
4	TERMINAL 端子	BRASS	12	Ag PLATED
3	BASE 基座	PHENOLIC RESIN	1	NATURAL
2	FRAME 框架	STEEL STRIP	1	Ni PLATED
1	KBOB 手柄	POM	1	BLACK
NO 序号	Part name 部件名	Material 材料	QTY 数量	Remark 备注

A4				
A3				
A2				
A1				
REV	DATE	REVISION	DESCRIPTION	ISSUE
		A		B



COMMON TOLERANCE	
X.XX	± 0.10
X.X	± 0.15
X	± 0.25
ANGULAR	—

UNIT	MM	PROJECTED	
DRAWN BY	FUYUAN	CHECKED BY	COCO
DATE	2019	APPROVAL	B ALEN

PRODUCT NAME:
MODEL NO: TP60321125
Https: www.rocpcu.tw

ROCPCU TECHNOLOGY CO., LTD

Copies are issued in strict confidence and shall not be reproduced or copied, or used as the basic of manufacture or sale of apparatus without permission