

SCHEMATIC

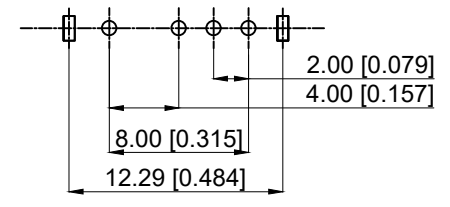

PCB LAYOUT

- | | |
|--|---|
| 1. Limit value: 0.3A 50V DC | 5. 动作力: 260±100gf |
| 1. 额定值: 0.3A 50V DC | 6. Stroke: 2.0mm |
| 2. Contact resistance: ≤ 100m Ω Max | 6. 行程: 2.0mm |
| 2. 接触电阻: ≤100mΩ MAX | 7. Service life: 10000 times |
| 3. Insulation resistance: ≥ 100m Ω Max | 7. 使用寿命: 10000次 |
| 3. 绝缘电阻: ≥100mΩ MAX | 8. Service temperature: - 16 °C ~ + 60 °C |
| 4. Withstand voltage: AC 500V 1 min | 8. 使用温度: - 16°C ~ + 60°C |
| 4. 耐电压: AC 500V 1 min | 9. Contact type: 1P3T |
| 5. Action force: 260 ± 100gf | 9. 接触型式: 1P3T |

4	Terminal 端子	Brass 黄铜	4	Ag plated 镀银
3	Base 基座	Phenolic Resin 酚醛树脂	1	
2	Frame 框架	SUS	1	Natural
1	Hand shank 手柄	PA66	1	Black 黑色
NO 序号	Part name 部件名	Material 材料	QTY 数量	Remark 备注

A4				
A3				
A2				
A1				
REV	DATE	REVISION	DESCRIPTION	ISSUE



COMMON TOLERANCE	
X.XX	± 0.10
X.X	± 0.15
X	± 0.25
ANGULAR	—

UNIT	MM	PROJECTED		PRODUCT NAME:
DRAWN BY	FUYUAN	CHECKED BY	COCO	MODEL NO: SK-13D07-6
DATE	2019	APPROVAL B	ALEN	Https: www.rocpcu.tw
ROCPCU TECHNOLOGY CO.,LTD				
Copies are issued in strict confidence and shall not be reproduced or copied, or used as the basic of manufacture or sale of apparatus without permission				