

MARK	DATE	EXPLANATION	REVISER
▽	20140805	Modified electroplating numbe	JACKY LIU
▽	20190123	Add "Nextron" LOGO and Nut post height	JACKY LIU

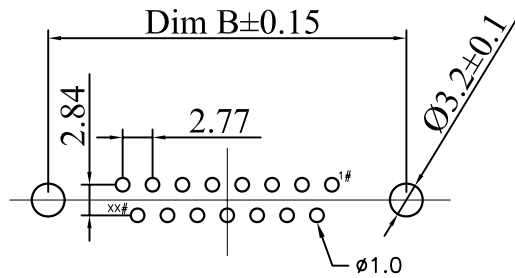
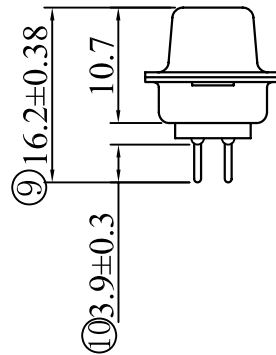
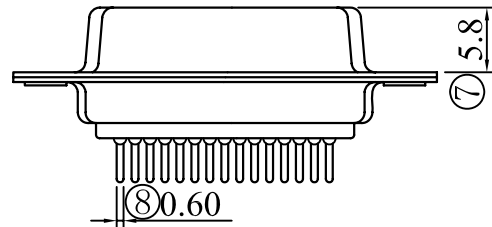
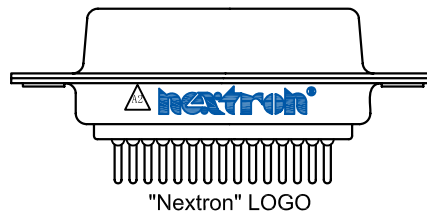
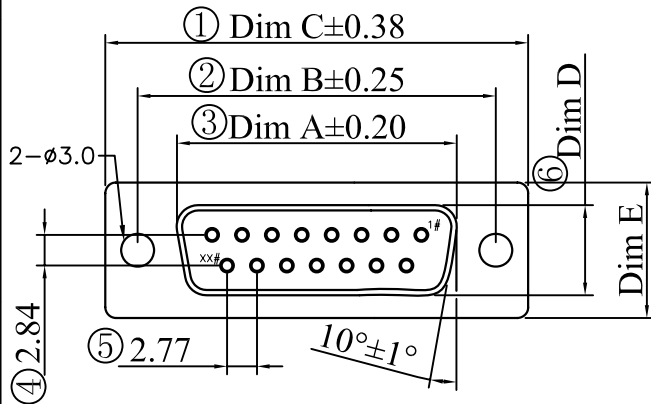

POS. NO.	A	B	C	D	E
37P	54.84	63.50	69.32	7.90	12.50
25P	38.38	47.04	53.04	7.90	12.50
15P	24.66	33.32	39.14	7.90	12.50
9P	16.33	24.99	30.81	7.90	12.50

DIMENSION

SPECIFICATIONS:

Current rating:3.0A AC/DC
Voltage rating:250V AC/DC
Contact resistance:30m ohm MAX
Insulation resistance:1000M ohm MIN
Withstanding voltage:1000V AC for one minute
Operating temperature range:-40°C~+85°C
Thread specification of nut:#4-40UN

MATERIAL AND FINISH

Insulator:PBT+30%G.F(UL94V-0)
Contact:Copper Alloy Nickel Undercoated
Selective Gold Plated
Finish:Metal Iron With Tin Plated

Ordering Information

SUB - DPXF - XXXX - XXX

Number of contacts		Housing Type	Mounting Options	Nut post height	Contacts Material	Contact Plated	Insulator material	Insulator color	Mark
Code	Definition	Code	Definition	Code	Definition	Code	Definition	Code	Definition
A	9 PIN	M	1 RIVETED W/ SHIELD ONLY	0	2 Brass	1	0 PBT	0	0 NONE
B	15 PIN		2 RIVETED W/ FRONT RIVET	1	7 Phosphor bronze	2	2 NYLON	6	2 Nextron
C	25 PIN	F	3 RIVETED W/ REAR RIVET			3		9	
E	37 PIN		4 RIVETED W/ NUT RIVET			4			
			5 RIVETED W/ HEX SCREW +HEX NUT			5			
						6			

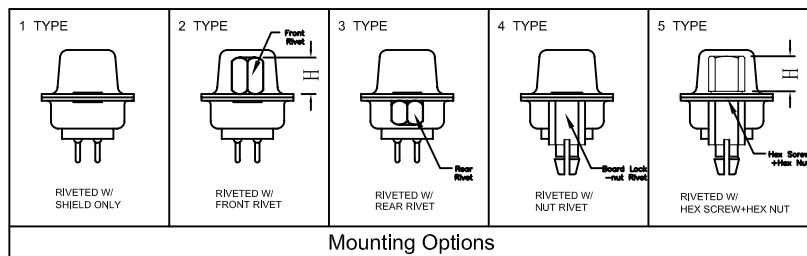

正凌精密工业股份有限公司
NEXTRONICS ENGINEERING CORP

PART. NAME: D型XX芯直插式PCB焊接插座 (孔)				TITLE: D-SUB/DP/xxP/FEMALE/	
PART. NO.: SEE TABLE				DWG NAME: C-SUB-DP0F-0001	
APPROVED BY	CHECKED BY	DESIGNED BY	DRAWN BY	CUSTOM NO.:	Tolerance
Jonnson	Jeff	allan	Jacky		x. ±0.50
			2019.01.23		x.xx ±0.30
				UNITS: mm	x.xx ±0.20
				SCALE:	xx° ±1°
				REVISION:A2	