

PIN No.	PIN NAME
C1	Supply Voltage Vcc
C2	Reset (RST)
C3	Clock (CLK)
C4	N/A
C5	Ground
C6	Programming Voltage Vpp
C7	I/O
C8	N/A

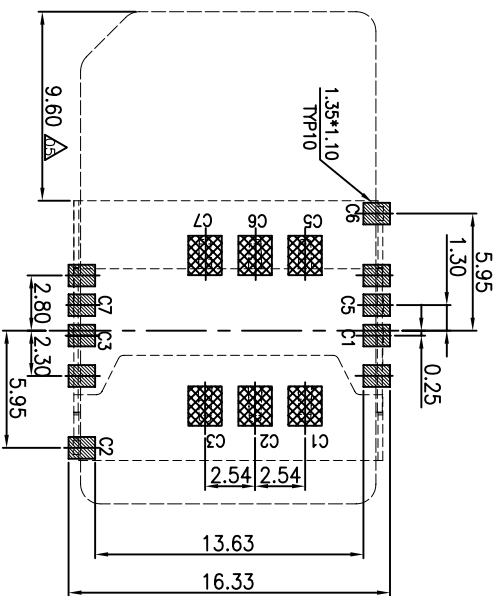
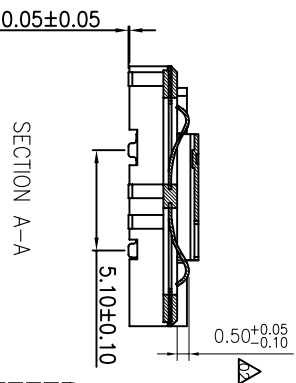
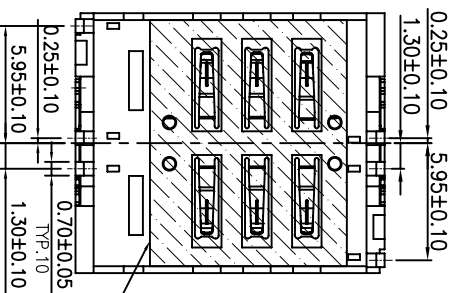
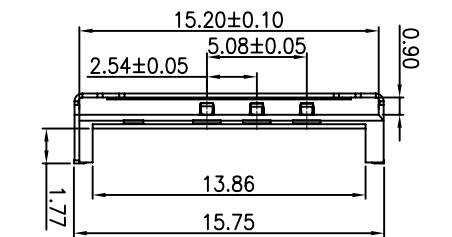
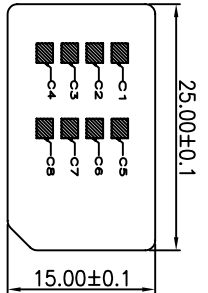

THESE AREA SHOULD BE FREE OF ANY CONDUCTIVE TRACES

SMT SOLDER AREA

RECOMMEND P.C.B. LAYOUT TOLERANCE ±0.05

REV.	LOCALS.	DESCRIPTION	DRAW.	DATE.
01	NEW	INITIAL RELEASE.	Mors	2011.03.30
02	△	ECN20110084	Mors	2011.11.18
03	△	ECN20110090	Huang	2011.12.06
04	△	ECN20110096	Huang	2011.12.23
05	△	ECN20120042	Huang	2012.10.26
06	△	modify pin Definition	Huang	2013.10.18

NOTES:

- MATERIAL:
 - Housing:High Temperature Thermoplastic UL94V-0; Color Black.
 - Terminal:Copper Alloy.
 - Sheet:Stainless Steel
- SPECIALTY:
 - Rated current:0.5A
 - Rated voltage:30V
 - Contact Resistance:50mΩ MAX
 - Insulation Resistance:100MΩ MIN 100V DC
 - Dielectric withstanding voltage: 100V AC.
 - Solder ability:245±5°C, 5±0.5s.
 - Durability:5000 Cycles Min.
 - Operating condition:Temperature: -30°C ~ +80°C; Humidity: 80% R.H MAX

Ordering Information

S A 06 07 254 350-019-XX

S:SIM CARD Series
A:Finished Product
No.of PINS:06(6PIN)
Standard Plating
254:Pitch 2.54mm

01:Without Mylar,Without Logo
02:With Mylar,Without Logo
03:Without Mylar,With Logo
04:With Mylar,With Logo
Distinctive Code
350:Height 3.50mm

MEASURE POINT:	(QP)
QUADRANT POINT	(TP)
TANGENCY POINT	(TP)
INTERSECTION POINT	(IP)
UNLESS OTHERWISE SPECIFIED,TOLERANCE:	
X	±0.25
Xx	±0.20
Xxx	±0.15
ANGULAR	±3°

		SHEN ZHEN D-CHAIN TECHNOLOGY CO.,LTD		
		DESIGN	Huang	DATE
CHECKED	Andy	DATE	2012.10.26	
APPROVED	Andy	DATE	2012.10.26	
PART NO:	SM0607254350-019-XX	REV:	06	
DRAWING NO:	DOSM0607254350-019-01	SIZE:	A4	
TITLE:		SIM-CARD 6PIN PH:2.54MM	SCALE:	3:1
		H:3.50mm	SHEET:	1/1
		SMT TYPE	UNIT:	mm