

TYPE R1

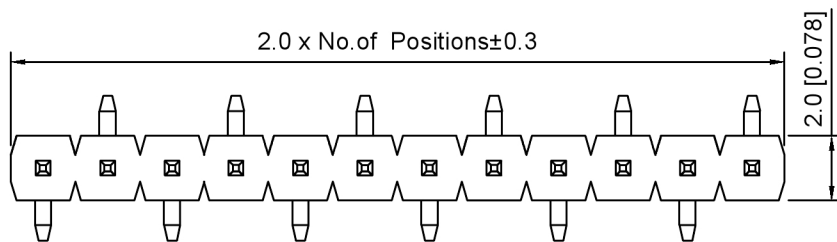

TYPE R2

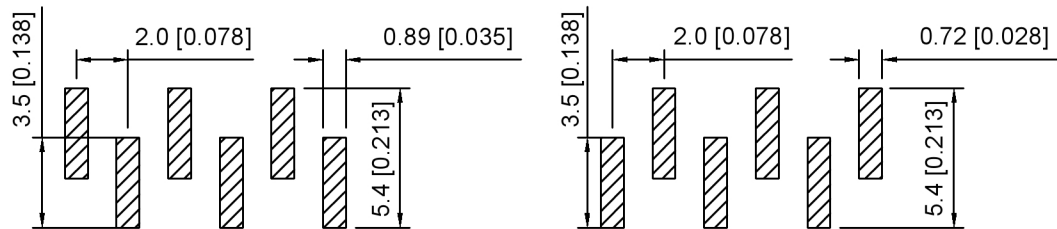
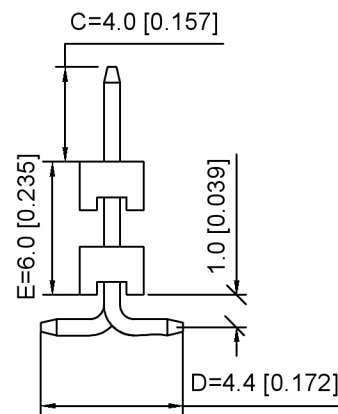
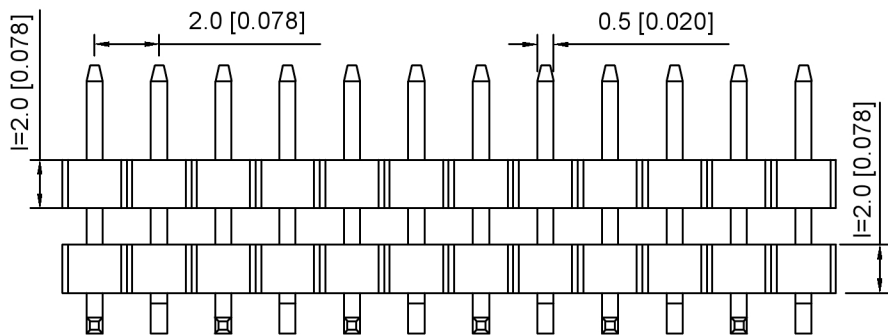

TYPE R2

Specifications:

规格:

Voltage rating: 250V AC/DC

额定电压: 250V AC/DC

Current rating: 3A AC/DC

额定电流: 3A AC/DC

Withstanding voltage: 1000V AC/minute

耐受电压: 1000V AC/分钟

Temperature range: -40°C - +105°C

温度范围: -40°C - +105°C

Insulation resistance: ≥1000MΩ

绝缘电阻: ≥1000MΩ

Contact resistance: ≤20mΩ

接触电阻: ≤20mΩ

Material: PA6T UL94V-0

材质: PA6T UL94V-0

Plating Category: 1U" Gold

镀层: 1U" Gold

Reflow soldering temperature: 260 ± 5°C, 10S

回流焊温度: 260 ± 5°C, 10S

X4612 W V S - XX I - C40 D44 - E60 X
 ① ② ③ ④ ⑤ ⑥ ⑦ ⑧ ⑨ ⑩

1. Series No.

2. Category: W-Water

3. Welding Board Angle: V-Straight 180°

4. Welding Way: S-SMT

5. Row No -Pin No: XX-02P-40P

6. Plastic height: I=2.0mm

7. Pin length: C=4.0mm

8. Pin Pitch: D=4.4mm

9. Pin length: E=6.0mm

10. Type: X-R1 ; R2

| | | | | |
|--------------------------|----------|---------------|-------------|---------------------|
| X4612WVS-XXI-C40D44-E60X | PA6T | Brass | 1U"Gold | X4611F |
| PART NO | Material | Material(Pin) | Finish(Pin) | Suitable XKB Female |

TYPE R1

广东星坤科技股份有限公司

| | |
|---|----|
| Δ | 日期 |
| Δ | 日期 |
| Δ | 日期 |

文件工程章

| | | | | | | |
|-------------|------|---------|----------|------------------------|-------------|------|
| DESCRIPTION | DATE | REVISED | APPROVED | UNSPECIFIED TOLERANCES | ANGLAR | ±5° |
| | | | | | L ≤ 4 | ±0.2 |
| | | | | | 4 < L ≤ 16 | ±0.3 |
| | | | | | 16 < L ≤ 63 | ±0.4 |
| | | | | | L > 63 | ±0.5 |



XKB INDUSTRIAL PRECISION CO., LIMITED

| | | | |
|------|--|-------------|----------------------------|
| DSND | | SCALE: N/A | MODEL TYPE: |
| DWN | | VIEW: | 2.0 BTB Connector |
| CHKD | | UNIT: mm/in | PART NO.: |
| APPD | | SIZE: A4 | X4612WVS-XXI-C40D44-E60X |
| | | | DWG NO.: |
| | | | X-X4612WVS-XXI-C40D44-E60X |
| | | | WEIGHT |
| | | | SHEET |
| | | | REVISION |
| | | | 1/1 |
| | | | A0 |