

REV.	LOCAS	DESCRIPTION	DATE	DRAWN
01	NEW	INITIAL RELEASE.	08-06-04'	XIAO PING
02	△	變更塑膠材質	07.11.20	周禮軍
03	△	變更料號	2008.08.05	彭思城
04	△	變更圖號	2011.01.10	黃明霞
05	△	新增電碼	2022.11.01	謝青平

Recommended P.C.Board Hole Layout

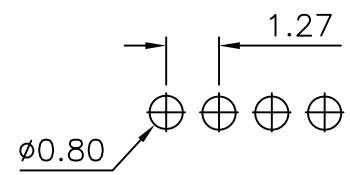

Specifications  
 Current Rating:1Amp  
 Insulation Resistance:1000MΩMin.  
 Dielectric Withstanding: 300VAC  
 Contact Resistance:20mΩMax.  
 Operating Temperature:-40°C to +105°C  
 Materials  
 Contact Material: Phosphor Bronze  
 Insulator Material: Polyester, UL 94V-0  
 △<sub>01</sub>LCP  
 All materials must meet Greenconn requirement for environment protection.

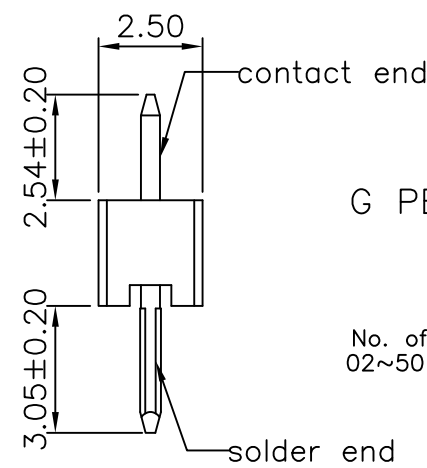
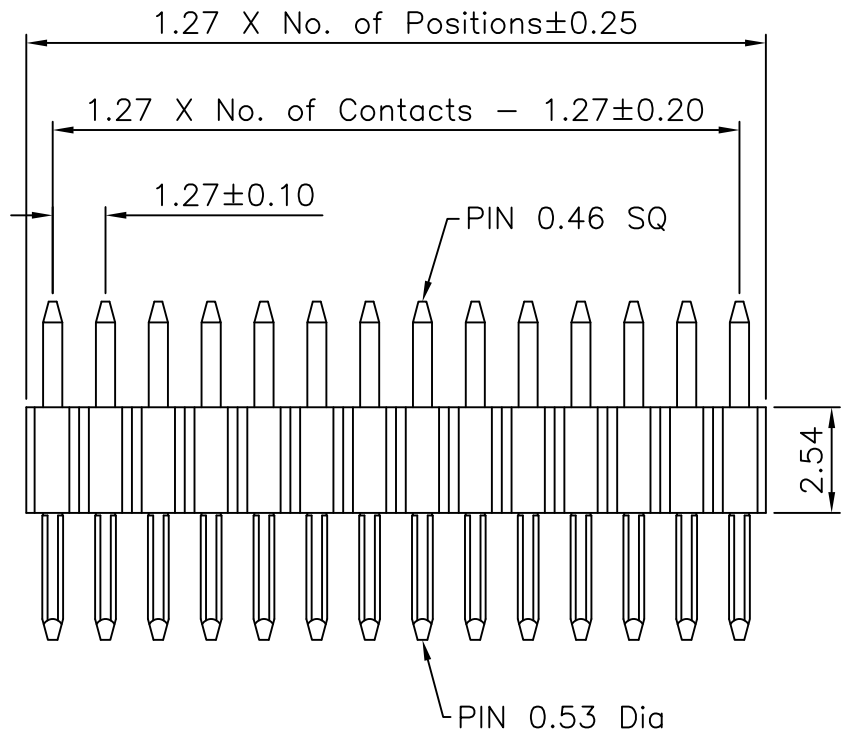
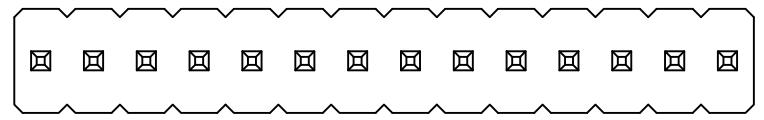

Ordering Information △

G PEA101 - XX XX A036 C 1 A X

No. of Pins per Row 02~50      Contact Plating 01=Tin, 02=Gold Flash, Duplex plating, 05=Gold Flash /Tin, △10=Gold 10u" /Gold Flash      Options D=tape reel, F=cap+tape reel, ...

F  
E  
D  
C  
B  
A

F  
E  
D  
C  
B  
A

格菱股份有限公司  
**Greenconn Corporation**

GENERAL TOLERANCE	
X. ±5.0'	X. ±0.30
.X' ±3.0'	.X ±0.25
.XX' ±2.0'	.XX ±0.15
.XXX' ±1.0'	.XXX ±0.10

DESIGN: 谢青平	DATE: 2022.11.01
CHECKED: LINK	DATE: 2022.11.01
AUDITED: LINK	DATE: 2022.11.01

DWG. NO. △△ GPEA101-CA36CA
PART NO. △ GPEA101-XXXA036C1AX

TITLE. 1.27PIN HEADER SINGLE ROW DIP TYPE BASE 2.54 H
--

REV.	UNIT.	SCALE.	PAGE.	Symbol
05	mm	1:1	1/1	⊕