

1

2

3

4

5

6

7

8

9

REV.	LOCAS.	DESCRIPTION	DATE	DRAWN
03	△	變更料號	2009.03.03	李彬彬
04	△	依上級要求變更圖號	2011.08.11	李芳忠

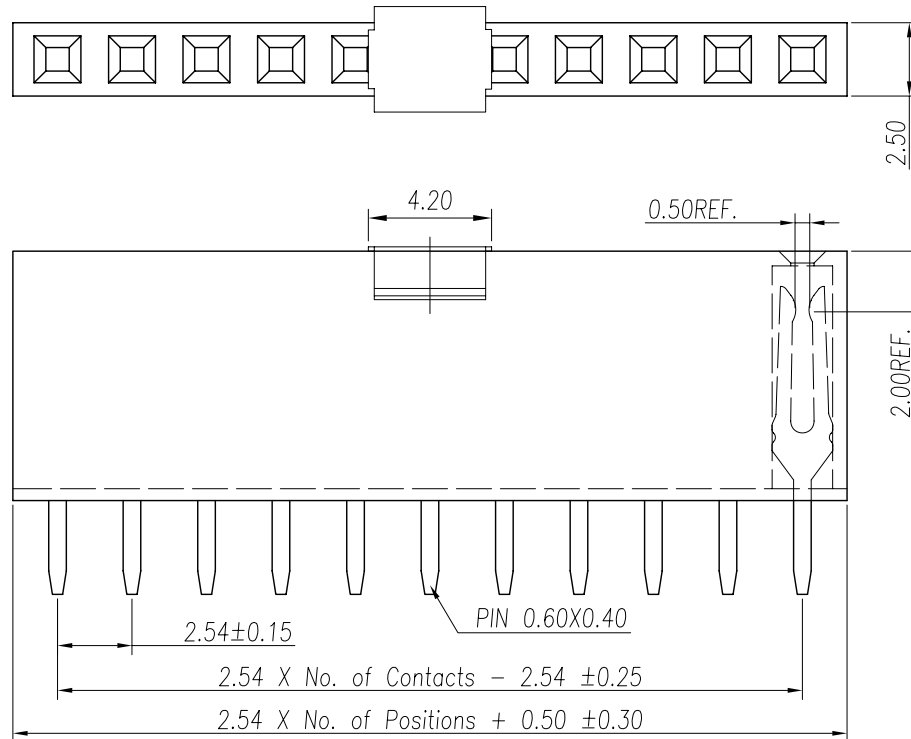

Specifications

Current Rating: 3Amp

Insulation Resistance: 1000MΩMin.

Dielectric Withstanding Voltage: 600VAC

Contact Resistance: 20mΩMax.

Operating Temperature: -40°C to +105°C

Materials

Contact Material: Phosphor Bronze

Insulator Material: Thermoplastic, UL 94V-0
PBT or the equivalent materialAll materials must meet Greenconn
requirement for environment protection.

△ Ordering Information △

C SHA101 - XX XX A 001 A X A X

No. Of Pins Per Row
02~40

Standard Plating
02=Gold Flash
Selective Plating
01=Tin
05=Gold Flash/Tin

Color
1=Black
6=Gray
K=Pink

Standard Packing
A=Box
Selective Packing
C=Tube
E=Cap+Tube
F=Cap+Tape&Reel

Recommended P.C.Board
Layout

(Tolerance: ±0.05)

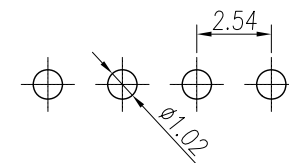

格菱股份有限公司
Greenconn Corporation

GENERAL TOLERANCE

X'±5.0'	X.±0.30
.X'±3.0'	.X±0.25
.XX'±2.0'	.XX±0.15
.XXX'±1.0'	.XXX±0.10

DESIGN:	李芳忠	DATE:	2011.08.11
CHECKED:	劉北平	DATE:	2011.08.11
AUDITED:	李輝	DATE:	2011.08.11
APPROVED:	cc_li	DATE:	2011.08.11

DWG. NO.	△△ CSHA101-CA1AA
PART NO.	△ CSHA101-XXXX A001AXAX

TITLE.
2.54 FEMALE HEADER
SINGLE ROW DIP TYPE
CONNECTOR

REV.	UNIT.	SCALE.	PAGE.	Symbol
04	mm	4:1	1/1	⊕

1

2

3

4

5

6

7

8

9