

1

2

3

4

5

6

7

8

9

REV.	LOCAS.	DESCRIPTION	DATE	DRAWN
03	△	變更料號	2009.03.03	李彬彬
04	△	依上級要求變更圖號	2011.08.11	李芳忠

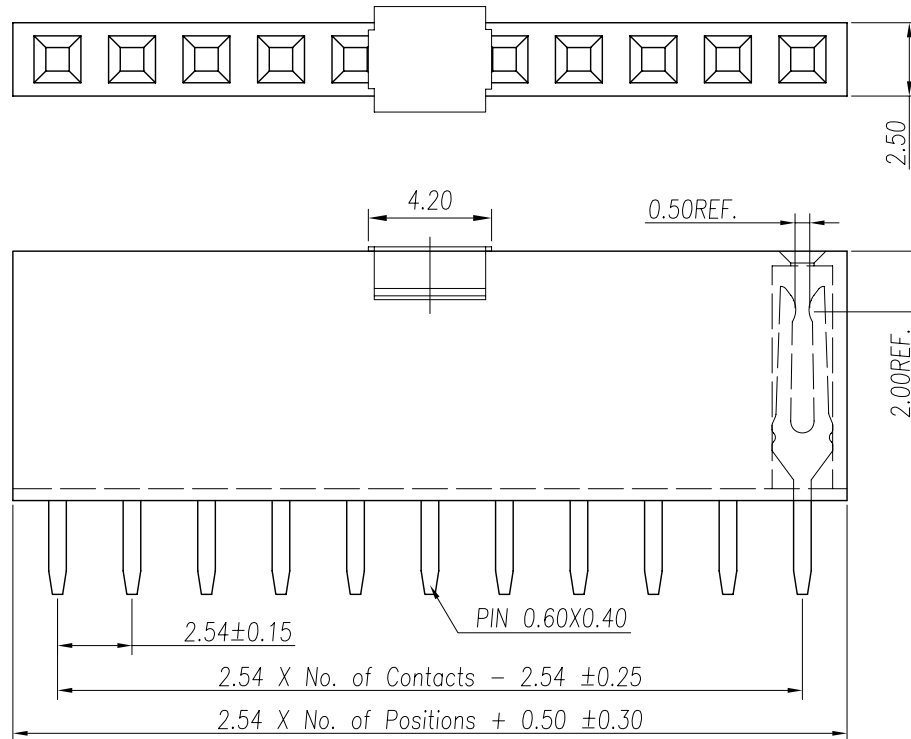

## Specifications

Current Rating: 3Amp

Insulation Resistance: 1000MΩ Min.

Dielectric Withstanding Voltage: 600VAC

Contact Resistance: 20mΩ Max.

Operating Temperature: -40°C to +105°C

## Materials

Contact Material: Phosphor Bronze

Insulator Material: Thermoplastic, UL 94V-0  
PBT or the equivalent materialAll materials must meet Greenconn  
requirement for environment protection.

## △ Ordering Information △

C SHA101 - XX XX A 001 A X A X

No. Of Pins Per Row  
02~40

Standard Plating  
02=Gold Flash  
Selective Plating  
01=Tin  
05=Gold Flash/Tin

Color  
1=Black  
6=Gray  
K=Pink

Standard Packing  
A=Box  
Selective Packing  
C=Tube  
E=Cap+Tube  
F=Cap+Tape&Reel

Recommended P.C.Board  
Layout

(Tolerance: ±0.05)

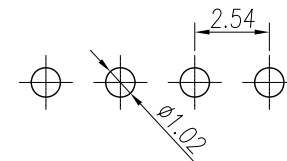

格稜股份有限公司  
**Greenconn Corporation**

## GENERAL TOLERANCE

X.'±5.0'	X.±0.30
.X'±3.0'	.X±0.25
.XX'±2.0'	.XX±0.15
.XXX'±1.0'	.XXX±0.10

DESIGN: 李芳忠

DATE: 2011.08.11

CHECKED: 劉北平

DATE: 2011.08.11

AUDITED: 李輝

DATE: 2011.08.11

APPROVED: cc\_li

DATE: 2011.08.11

DWG. NO.

△△

CSHA101-CA1AA

PART NO.

△  
CSHA101-XXXX A001AXAX

TITLE.

2.54 FEMALE HEADER  
SINGLE ROW DIP TYPE  
CONNECTOR

REV.	UNIT.	SCALE.	PAGE.	Symbol
04	mm	4:1	1/1	☉

1

2

3

4

5

6

7

8

9