

REV.	LOCAS.	DESCRIPTION	DATE	DRAWN
04	△△	依業務要求修改電氣特性	2019.01.08	何東華
05	△△	依業務要求修改電氣特性	2021.04.29	何東華

△△ Specifications

Current Rating: 1.70Amp/PIN △△

Insulation Resistance: 10000MΩ Min.

Dielectric Withstanding Voltage: 500VAC

Contact Resistance: 25mΩ Max.

Operating Temperature: -55°C to +125°C

Materials

Contact Material: Phosphor Bronze

Insulator Material: High Temperature

Thermoplastic, UL 94V-0 LCP or

the equivalent material

All materials must meet GREENCONN

hazardous substances control standards.

No. of PIN/ROW	Dimension Information							
	A	B	C	D	E	F	G	H
2x06	8.37	6.35	10.57	9.37	10.77	11.87	13.20	10.10
2x08	10.91	8.89	13.11	11.91	13.31	14.41	15.74	12.64
2x10	13.45	11.43	15.65	14.45	15.85	16.95	18.28	15.18
2x13	17.26	15.24	19.46	18.26	19.66	20.76	22.09	18.99
2x16	21.07	19.05	23.27	22.07	23.47	24.57	25.90	22.80
2x20	26.15	24.13	28.35	27.15	28.55	29.65	30.98	27.88
2x25	32.50	30.48	34.70	33.50	34.90	36.00	37.33	34.23
2x34	43.93	41.91	46.13	44.93	46.33	47.43	48.76	45.66
2x40	51.55	49.53	53.75	52.55	53.95	55.05	56.38	53.28

Recommended P.C.Board
Layout

(Tolerance: ±0.05)

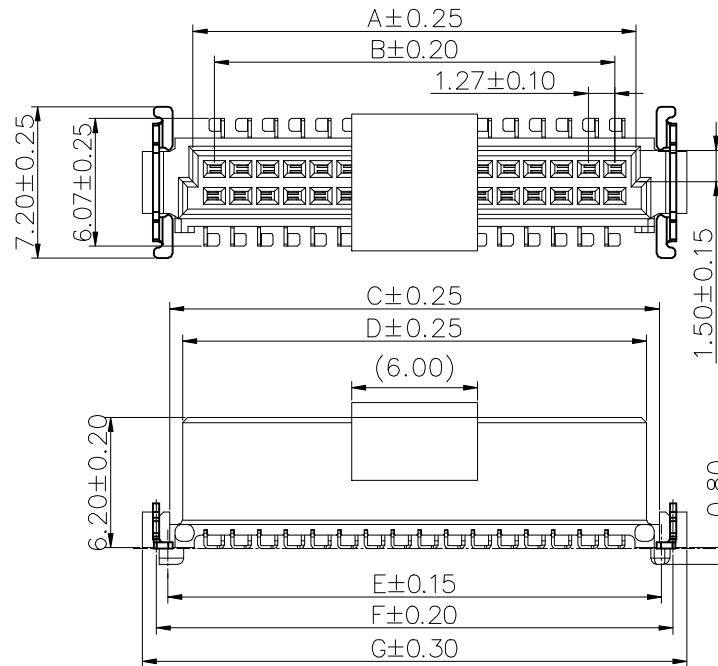
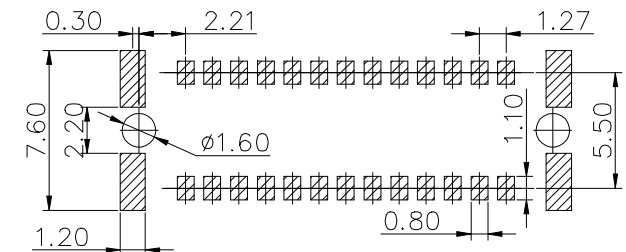

Pin No.	Dim.F
≤25pin	0.12
>25pin	0.15

Dim.F

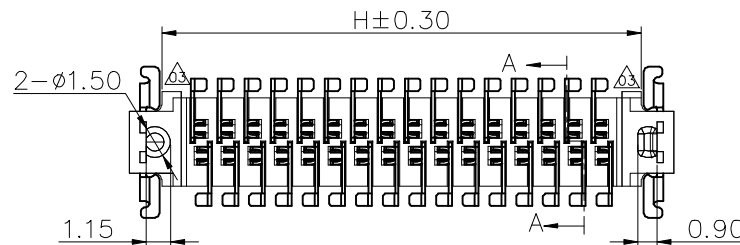
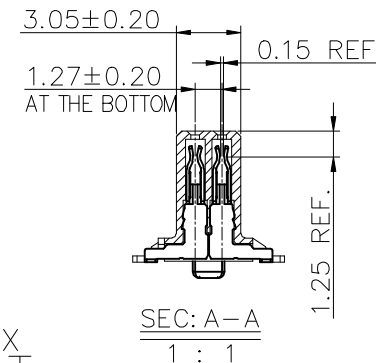

Ordering Information

C BEC201- XX XX B 004 C 1 T X

No. of Pins per Row
06,08,10,13,16,
20,25,34,40

Standard Plating
79=5u"Au/80~160u"Matte Tin
Selective Plating
52=5u"Au/80~160u" Tin
△△01= Tin

Color
1=Black

Standard Packing
F=Cap+Tape&Reel
Selective Packing
C=Tube



3RD.ANG
PROJ.
PAGE. 1/1

GENERAL TOLERANCE	
X.±5.0°	X.±0.30
.X.±3.0°	.X.±0.25
.XX.±2.0°	.XX.±0.15
.XXX.±1.0°	.XXX.±0.10

DESIGNED: 何東華
CHECKED:
APPROVED:

DATE: 2021.04.29
DATE:
DATE:

DWG. NO.
CBEC201-CB4CT
PART NO.
CBEC201-XXXX B004C1TX

TITLE.
1.27 BOARD TO BOARD
FEMALE DUAL ROW SMT
TYPE CONNECTOR