

REV.	DESCRIPTION OF REVISIONS	APPR.	DRAW.	RELEASE	DATE
X1	NEW REVISION				Mar.14.2018
X2					

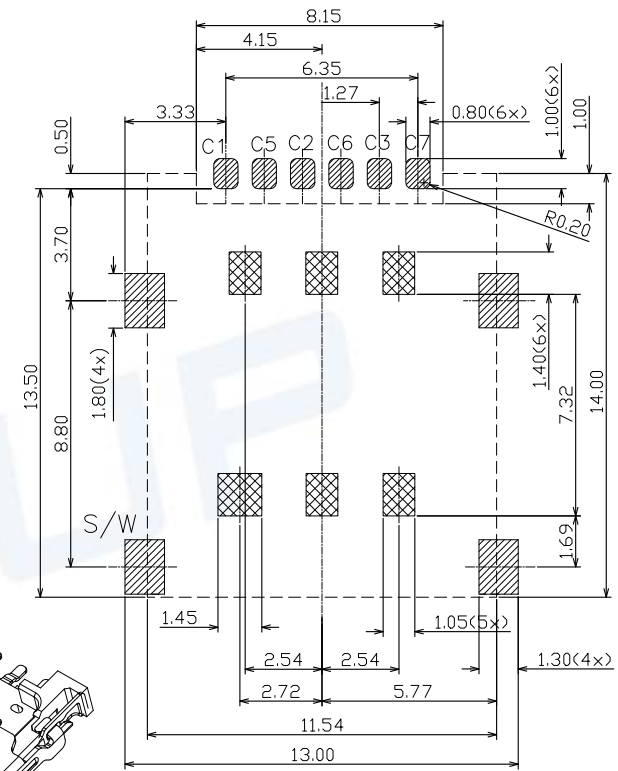

RECOMMENDED P.C.B LAYOUT  
COMPONENT SIDE(TOLERANCE ±0.05)

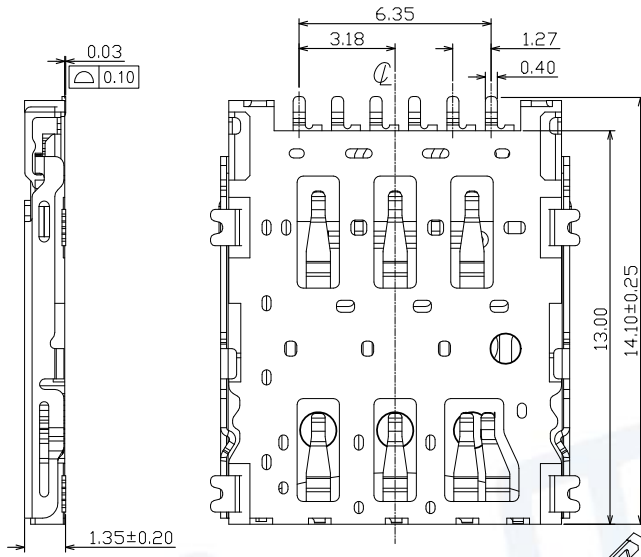
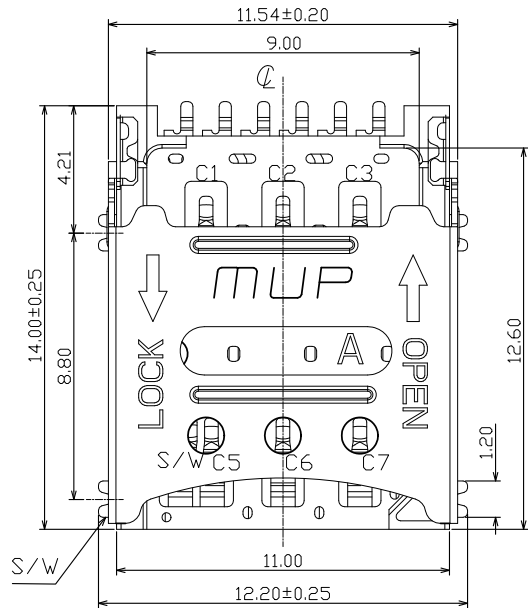
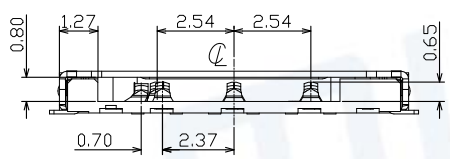

NANO SIM CARD	
Pin No.	ASSIGNMENT
C1	VCC(SUPPLY VOLTAGE)
C2	RST(RESET SIGNAL)
C3	CLK(CLOCK SIGNAL)
SW	DETECTION SWITCH
C5	GND
C6	VPP(VARIABLE SUPPLY VOLTAGE)
C7	I/O(DATA INPUT/OUTPUT)

ELECTRIC FUNCTION	DETECT SWITCH
WITHOUT CARD	OPEN
CARD INSERTED	CLOSED

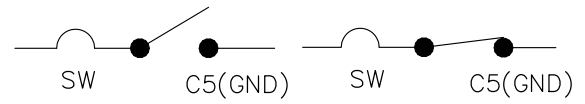

SWITCH OPERATION DIAGRAM

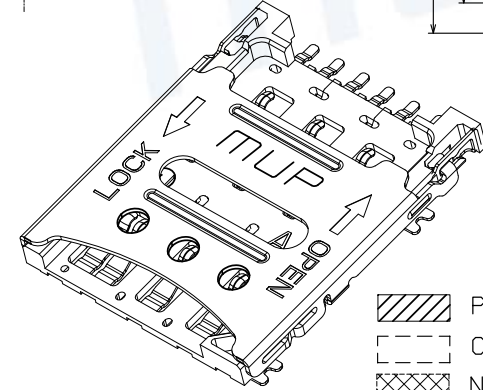

- PAD AREA
- CONNECTOR OUTLINE
- NO PATTERN AND VIA HOLE IN THIS AREA

**TECHNICAL CHARACTERISTICS**

1.General Characteristics  
 Dimensions:14.00LX11.70WX1.40H mm  
 Weight:Approx 0.50±0.2g  
 Durability:2,500 cycles min.  
 2.Electrical Characteristics  
 Contact resistance:50mΩ typical,  
 100mΩMax  
 Insulation resistance:>1000MΩ/500V DC  
 3.Solderability  
 Vaporphase:215°C, 30sec.Max  
 IR reflow:250°C,5sec.Max  
 Manual soldering:370°C.3sec.Max  
 4.Environmental Characteristics  
 Operating temperature:-40°C~+85°C  
 Operating humidity:10%~+95%RH

ITEM	PART NAME	Q'TY	MATERIAL	FINISH
1	HOUSING	1	Hi-temp Thermoplastic	Black UL94V-0
2	DATA CONTACT	6	Copper Alloy	Contact area:Gold plated
3	SHELL	1	Stainless Steel	

Unless otherwise specified, other tolerance are:

X	±0.35	X'	±5'
X.X	±0.25	X.X'	±4'
X.XX	±0.15	X.XX'	±3'
X.XXX	±0.10	X.XXX'	±2'

**MUP<sup>®</sup> MUP INDUSTRIAL CO.,LTD.**

NAME: **Hinge Type NANO-SIM Card Connector**  
 MODEL NO: **MUP-C7802-2**  
 TYPE: **6PIN,H1.35mm WITH SWITCH PIN**

PROJ.	UNIT	SCALE	DRAWN	DWG NO.:
	mm	1:1	Henry Ou.03.2018	DWG-MUP-C7802-2
CHECKED	APPROVAL		Simon 03.2018	SHEET
CUSTOMER DRAWING			1/1	REVISION
				X1