

# 承認書

## SPECIFICATION FOR APPROVAL

CUSTOMER: 2144

DESCRIPTION: WIRE WOUND TYPE COMMON MODE FILTER

DDY PART NO: WBA3416L600T-D-1R1-HF

CUSTOMER MODEL NO: \_\_\_\_\_

DRAWING		
MADE	CHECKED	APPROVED
余运鸿	曹春宁	陈启善
DATE:	2021年4月22日	

CUSTOMER APPROVE

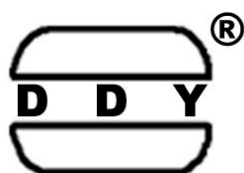

惠州市德立电子有限公司  
HUI ZHOU DE LI ELECTRONICS CO., LTD

廣東省博羅縣洲際工業園梅園三路  
NO.3 MEI YUAN ROAD, ZHOU JI INDUSTRIAL AREA, BOLUO COUNTY GUANGDONG

電話：0752-6207968    0752-6207962

傳真：0752-6207969

郵編：516100

Http://ddycoils.com



惠州市德立电子有限公司

HUIZHOU DELI ELECTRONICS CO., LTD

CUSTOMER:	2144	REV NO:	A1.0
DESCRIPTION:	WIRE WOUND TYPE COMMON MODE FILTER	PAGE NO:	PAGE 1 OF 6
PART NO:	WBA3416L600T-D-1R1-HF	SN.	
CUSTOMER NO:		DATE:	2021年4月22日

## CATALOG

Resume	.....	P2
Shape & Dimension	.....	P3
Characteristic	.....	P3
Part numbering system	.....	P3
General specification	.....	P3
Test Data for samples	.....	P4
Soldering Conditions	.....	P5
Package Information	.....	P6





# 惠州市德立电子有限公司

## HUIZHOU DELI ELECTRONICS CO., LTD

CUSTOMER:	2144	REV NO:	A1.0
DESCRIPTION:	WIRE WOUND TYPE COMMON MODE FILTER	PAGE NO:	PAGE 3 OF 6
PART NO:	WBA3416L600T-D-1R1-HF	SN.	
CUSTOMER NO:		DATE:	2021年4月22日

### 1. SHAPE & DIMENSION

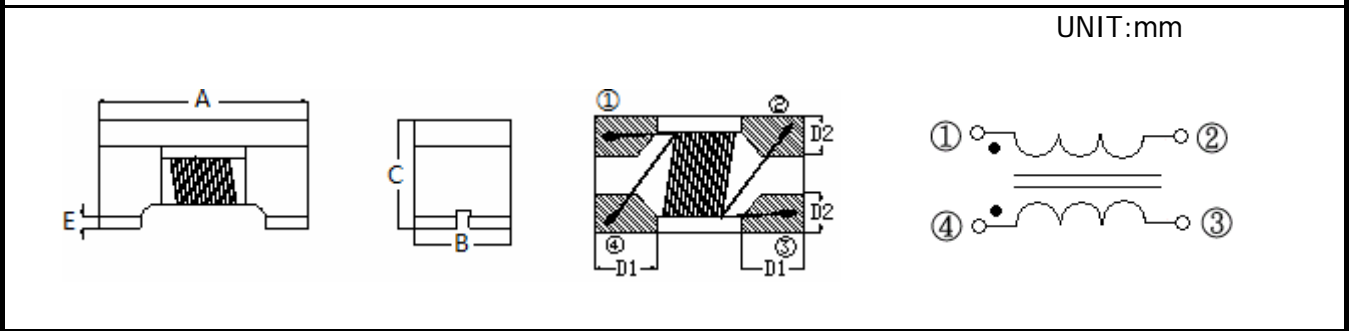

CODE	A	B	C	D1	D2	E	
DIMENSION	3.40±0.20	1.60±0.20	2.0±0.20	0.64 TYP	0.66 TYP	0.12 TYP	

### 2. ELECTRICAL CHARACTERISTICS @25°C

Part Number	L	Freq	Rdc	Irms	Rated Voltage	Min Insulation Resistance
	(μH)MIN	(KHz)	(Ω)max	(mA)max	Volts	MΩ
WBA3416L600T-D-1R1-HF	60	100/0.1V	1.1	200	50	10

### 3. PART NUMBERING SYSTEM

**WBA** □□□□ □ □□□ □ □ — □□  
 1 2 3 4 5 6 7

- 1 PRODUCT SYMBOL (产品代号)
- 2 DIMENSIONS (规格尺寸)
- 3 MATERIAL (芯片类型)
- 4 INDUCTANCE (电感量)
- 5 TOLERANCE (公差) : MIN
- 6 PACKAGING (包装方式) : T-编带盘装; B-散装
- 7 E.P. (环保) : LF—Lead Free HF—Halogen Free FP—Red Phosphor Free

### 4. GENERAL SPECIFICATION

a. Rating DC current: Temperature rise(ΔT) is 40°C approximately at I<sub>rms</sub>.

APPROVED BY	CHECKED BY	DRAFT
陈启善	曹春宁	余运鸿



惠州市德立电子有限公司

HUIZHOU DELI ELECTRONICS CO., LTD

CUSTOMER:	2144	REV NO:	A1.0
DESCRIPTION:	WIRE WOUND TYPE COMMON MODE FILTER	PAGE NO:	PAGE 4 OF 6
PART NO:	WBA3416L600T-D-1R1-HF	SN.	
CUSTOMER NO:		DATE:	2021年4月22日

**5. TEST DATA FOR SAMPLES**

TEST ITEM	L	R <sub>dc</sub>	A	B	C	D1	D2
	( $\mu$ H)	( $\Omega$ )	(mm)	(mm)	(mm)	(mm)	(mm)
CON.	100KHz/0.1V	At 25°C	3.40±0.20	1.60±0.20	2.0±0.20	0.64 TYP	0.66 TYP
SPEC.	60MIN	1.10 MAX					
1	72.0	0.93	3.43	1.62	2.02	0.62	0.62
2	69.0	0.96	3.44	1.62	2.01	0.62	0.64
3	68.0	0.95	3.42	1.61	2.01	0.63	0.67
4	67.0	0.96	3.44	1.62	2.01	0.65	0.64
5	68.0	0.95	3.43	1.63	2.00	0.64	0.62
6	65.0	0.95	3.43	1.61	2.03	0.64	0.61
7	66.0	0.93	3.42	1.61	2.02	0.63	0.63
8	66.0	0.94	3.41	1.63	2.01	0.63	0.66
9	68.0	0.95	3.43	1.61	2.01	0.63	0.63
10	69.0	0.95	3.42	1.62	2.01	0.63	0.66
X	67.8	0.95	3.43	1.62	2.01	0.63	0.64
R	7.0	0.03	0.03	0.02	0.03	0.03	0.06

图示:

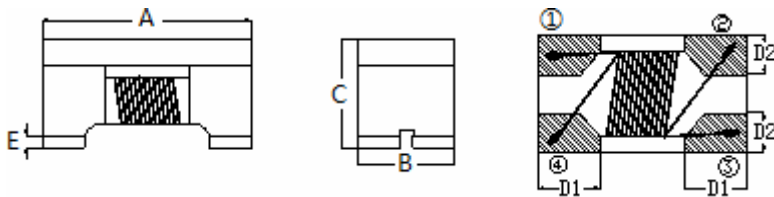

APPROVED BY	CHECKED BY	DRAFT
陈启善	曹春宁	余运鸿



CUSTOMER:	2144	REV NO:	A1.0
DESCRIPTION:	WIRE WOUND TYPE COMMON MODE FILTER	PAGE NO:	PAGE 5 OF 6
PART NO:	WBA3416L600T-D-1R1-HF	SN.	
CUSTOMER NO:		DATE:	2021年4月22日

**6. SOLDERING CONDITIONS**

**Figure 1.  
Re-flow  
Soldering (Lead  
Free)**

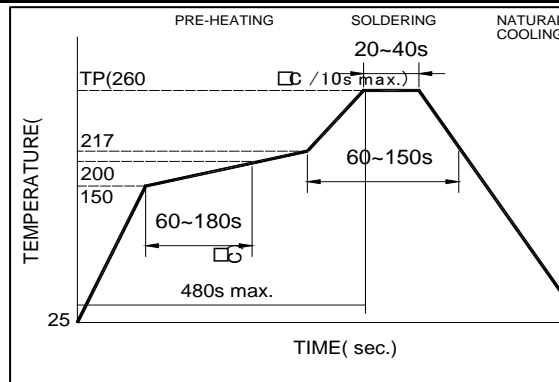

Note:

- Preheat circuit and products to 150°C
- 260°C tip temperature (max)
- Reflow times: no more than 2 times
- Solder paste thickness: the best 0.08mm is ,but max is 0.1mm

**Figure 2.  
Wave Soldering**

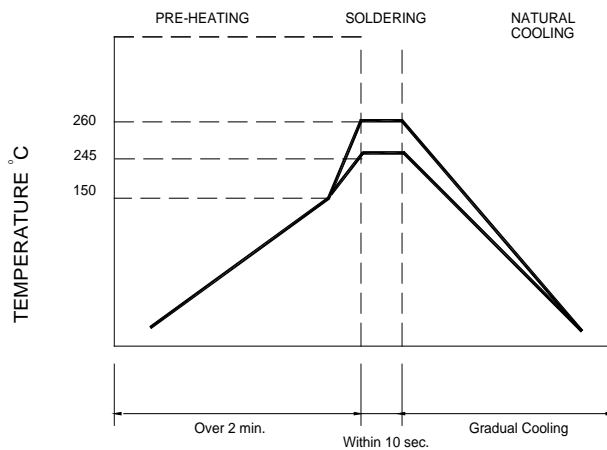

Note :

- Never contact the ceramic with the iron tip
- 1.0mm tip diameter (max)

**Figure 3.  
Hand Soldering**

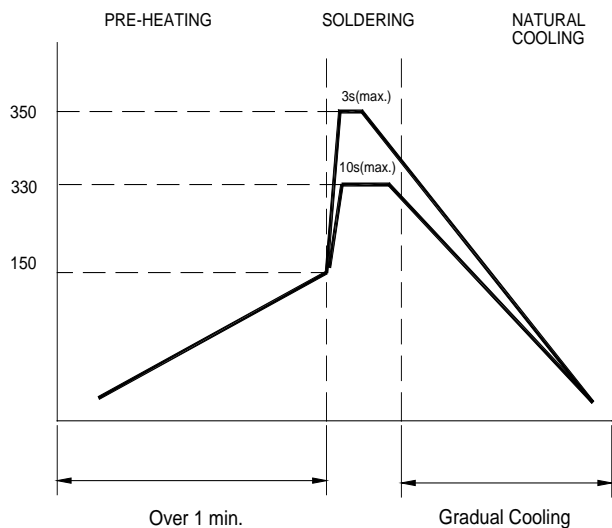

Note:

- Use a 20 watt soldering iron with tip diameter of 1.0mm
- Limit soldering time to 3 sec.

APPROVED BY	CHECKED BY	DRAWN BY
陈启善	曹春宁	余运鸿



惠州市德立电子有限公司

HUIZHOU DELI ELECTRONICS CO., LTD

CUSTOMER:	2144	REV NO:	A1.0
DESCRIPTION:	WIRE WOUND TYPE COMMON MODE FILTER	PAGE NO:	PAGE 6 OF 6
PART NO:	WBA3416L600T-D-1R1-HF	SN.	
CUSTOMER NO:		DATE:	2021年4月22日

**7. PACKAGING(unit: mm)**

Type	1210	1608	2012	3416	3225	4532
Quantity	3000	2000	2000	2000	1000	500

**TAPING DRAWINGS**

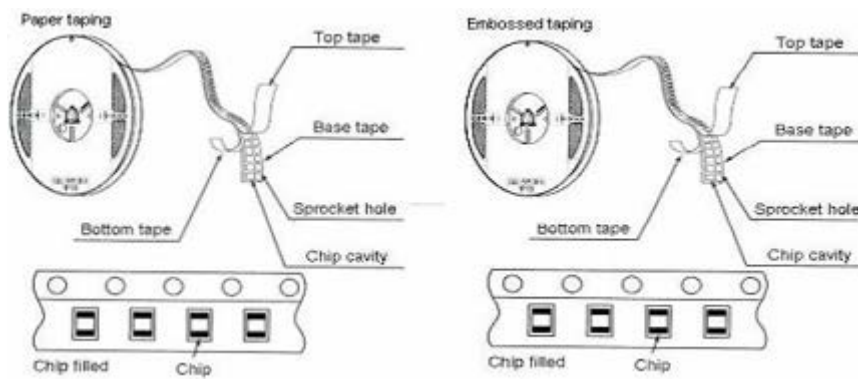

**REEL DIMENSIONS(UNIT:mm)**

	A	B	C	N	G
CF-8	178±2.0	22±2.0	12.5±1.5	57±2.0	8
CF-12	178±2.0	22±2.0	12.5±1.5	98±2.0	12

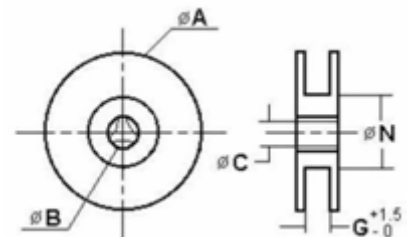

**LEADER AND BLANK PORTION**

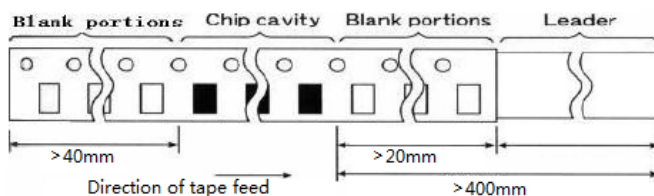

**PEELLING OFF FORCE:0.05 to 0.7N in the direction show below.**

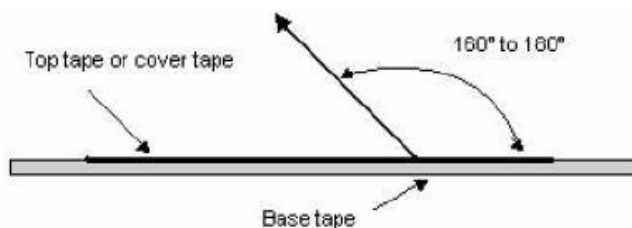

APPROVED BY	CHECKED BY	DRAFT
陈启善	曹春宁	余运鸿