

REED SWITCH MKC-27103

CONTACT FORM C TRANSFER

Switching current 1 A

Switching power 30 W, VA

Switching voltage 220 V

Pull in range 40...90 AT

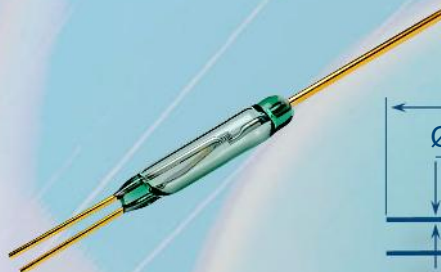

Dimensions



Electrical Data

| | |
|---|----------------------|
| Release range, AT, min | 14 |
| Carry current, A | 1 |
| Breakdown voltage | less 50 A more 50 A |
| V, not less, AC/DC | 160/220 250/350 |
| Resetting Ratio | 0,35...0,9 |
| Contact resistance, Ω, not more | 0,15 |
| Operating time including bounce, ms, not more | 1,5 |
| Release time including bounce ms, not more | 2,5 |
| Capacitance, pF, not more | 3,0(N.C.) 1,5 (N.O.) |
| Insulation resistance, GΩ, not less | 0,5 (N.C.) 1 (N.O.) |
| Operating frequency, Hz | 50 |
| Switching current frequency, kHz, not more | 10 |

Environmental Data

| | |
|--|-----------|
| Contact material | Ru |
| Life expectancy, switching cycles x10 ⁶ max load power... low load power | 0,01...5 |
| Vibration (1...2000 Hz), g, not more | 10 |
| Resonant frequency, Hz | 2200 |
| Shock (1±0,3) ms, g, not more | 150 |
| Weight, g, not more | 1,5 |
| Operating temperature, °C | -60...125 |
| Humidity, %, not more | 98 |

Certificates



Test Coil

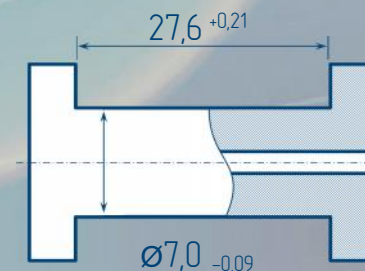

5000 turns, wire Ø0,08 mm
coil resistance 450

Order information

Delivery of reed switches with formed and/or cropped leads and with narrow pull in ranges is available by agreements.



RYAZAN METAL CERAMICS INSTRUMENTATION PLANT, JSC
51V, Novaya St., 390027, Ryazan, Russia
Phone: +7 (4912) 240-234, Факс: +7 (4912) 240-234 E-mail: ives@rmcip.ru

Update on 27 November 2013

