

REED SWITCH MKC-17103

CONTACT FORM C TRANSFER

Switching current 1 A

Switching power 30 W, VA

Switching voltage 127 V

Pull in range 30...100 AT

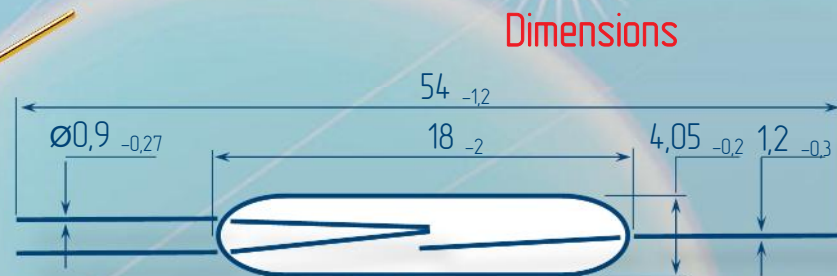
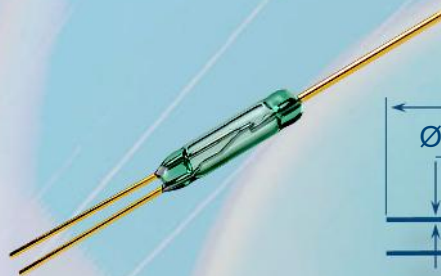

Electrical Data

Release range, AT, min	11
Carry current, A	1
Breakdown voltage	less 80 A more 80 A
V, not less, AC/DC	150/210 200/280
Resetting Ratio	0,35...0,9
Contact resistance, , not more	0,15
Operating time including bounce, ms, not more	1,5
Release time including bounce ms, not more	2
Capacitance, pF, not more	2,5(N.C.) 0,5 (N.O.)
Insulation resistance, G , not less	0,5 (N.C.) 1 (N.O.)
Operating frequency, Hz	50
Switching current frequency, kHz, not more	10

Environmental Data

Contact material	Ru
Life expectancy, switching cycles x10 ⁶ max load power... low load power	0,001...1
Vibration (1...2000 Hz) , g, not more	10
Resonant frequency, Hz	3600
Shock (1±0,3) ms, g, not more	150
Weight, g, not more	0,65
Operating temperature, °C	-60...125
Humidity, %, not more	98

Certificates



Test Coil

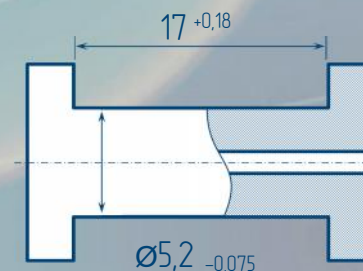

5000 turns, wire Ø0,08 mm
coil resistance 455

Order information

Delivery of reed switches with formed and/or cropped leads and with narrow pull in ranges is available by agreements.



RYAZAN METAL CERAMICS INSTRUMENTATION PLANT, JSC
51V, Novaya St., 390027, Ryazan, Russia
Phone: +7 (4912) 240-234, Факс: +7 (4912) 240-234 E-mail: oves@rmcip.ru

Update on 27 November 2013

