

# REED SWITCH MKA-20101

## CONTACT FORM A NORMALLY OPEN CONTACTS

Switching current 0,5 A

Switching power 10 W, VA

Switching voltage 180 V

Pull in range 10...42 AT



### Electrical Data

|                                               |                 |
|-----------------------------------------------|-----------------|
| Release range, AT, min                        | 4               |
| Carry current, A                              | 0,5             |
| Breakdown voltage less 20 A more 20 A         |                 |
| V, not less, AC/DC                            | 160/220 200/280 |
| Resetting Ratio                               | 0,35...0,9      |
| Contact resistance, $\Omega$ , not more       | 0,15            |
| Operating time including bounce, ms, not more | 1               |
| Release time including bounce ms, not more    | 0,3             |
| Capacitance, pF, not more                     | 0,4             |
| Insulation resistance, G $\Omega$ , not less  | 1               |
| Operating frequency, Hz                       | 100             |
| Switching current frequency, kHz, not more    | 10              |

### Environmental Data

|                                                                                     |            |
|-------------------------------------------------------------------------------------|------------|
| Contact material                                                                    | Ru         |
| Life expectancy, switching cycles $\times 10^6$<br>max load power... low load power | 0,01...100 |
| Vibration (1...2000 Hz), g, not more                                                | 20         |
| Resonant frequency, Hz                                                              | 2600       |
| Shock (1 $\pm$ 0,3) ms, g, not more                                                 | 150        |
| Weight, g, not more                                                                 | 0,36       |
| Operating temperature, $^{\circ}\text{C}$                                           | -60...125  |
| Humidity, %, not more                                                               | 98         |

### Certificates



### Test Coil

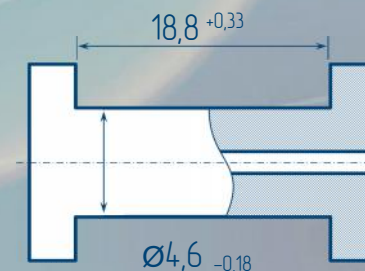

5000 turns, wire  $\varnothing 0,063$  mm  
coil resistance 550

### Order information

Delivery of reed switches with formed and/or cropped leads and with narrow pull in ranges is available by agreements.



RYAZAN METAL CERAMICS INSTRUMENTATION PLANT, JSC  
51V, Novaya St., 390027, Ryazan, Russia  
Phone: +7 (4912) 240-234, Факс: +7 (4912) 240-234 E-mail: ives@rmcip.ru

Update on 19 November 2013

