

23.00

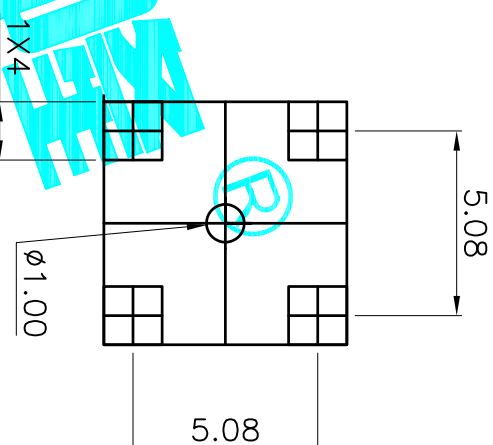
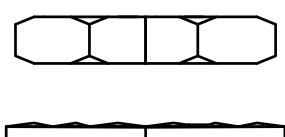
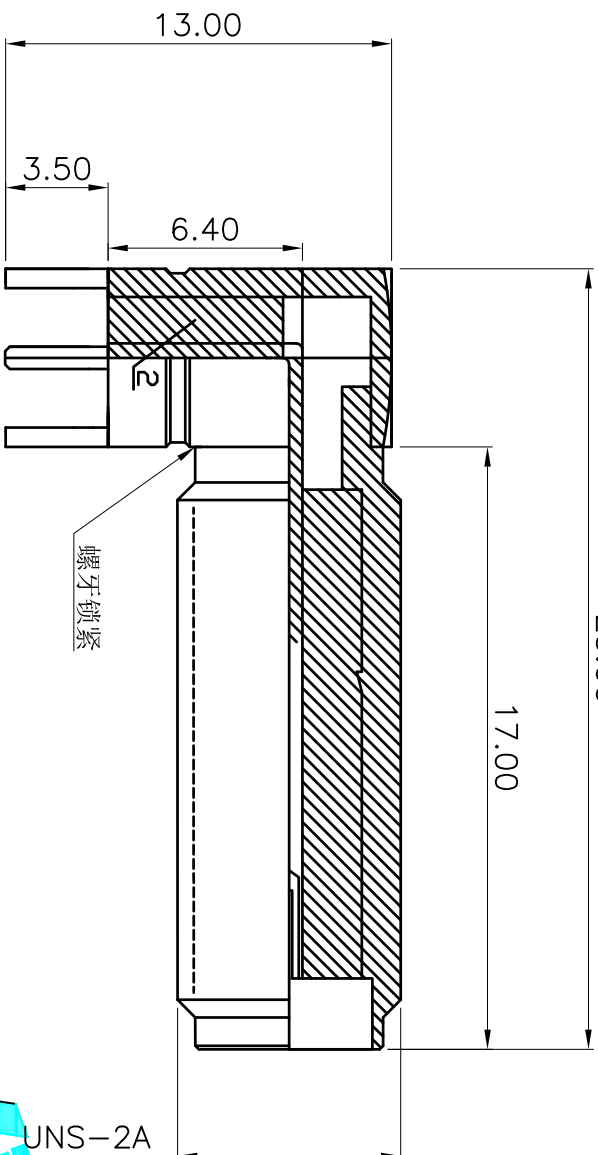

电气性能

序号	检测项目	技术指标
1	特性阻抗	50 Ω
2	频率范围	0~6GHz
3	工作电压	1000V _{rms}
4	绝缘电阻	$\geq 50000 \Omega$
5	接触电阻	内导体 $\leq 3m \Omega$, 外导体 $\leq 2m \Omega$
6	机械耐久性	500次
6	耐压	1000V _{rms} (海平面)

材质与镀层

序号	零件名称	材料	镀层
1	插孔	HPb59-1(黄铜)	Au0.1
2	绝缘子	聚四氟乙烯	
3	外壳	HPb59-1(黄铜)	Au0.1
4	螺母	HPb59-1(黄铜)	Au0.1
3	花垫	HPb59-1(黄铜)	Au0.1

APPROVALS		DATE	DRAWING NO.	
DRAWN	G.M.Chen	2015/7/17	DL-SMA-KE11-17	
CHECKED			RF CONNECTOR	
APPROVALS			ELECTRONICS CO.,LTD	

DEALON 德之隆®
ELECTRONICS CO.,LTD

TITLE: RF CONNECTOR

PART NO. DL-SMA-KE11-17

UNIT: mm SCALE: 1:1 SHEET 1 OF 1

DRAWING NO. PROJ.

APPROVALS

APPROVALS	DATE	APPROVALS	DATE
DRAWN	G.M.Chen	2015/7/17	
CHECKED			
APPROVALS			

TOLERANCES ARE

30 ^{±0.15}	±0.30	ANGLE
10 ^{±0.10}	±0.20	±2°
5 ^{±0.10}	±0.15	

ECN NO.	REV.	DATE.	DESCRIPTION.	CHANGE.	CHECK.	APPRO.
	A		NEW			