

PN 0-1719957-1

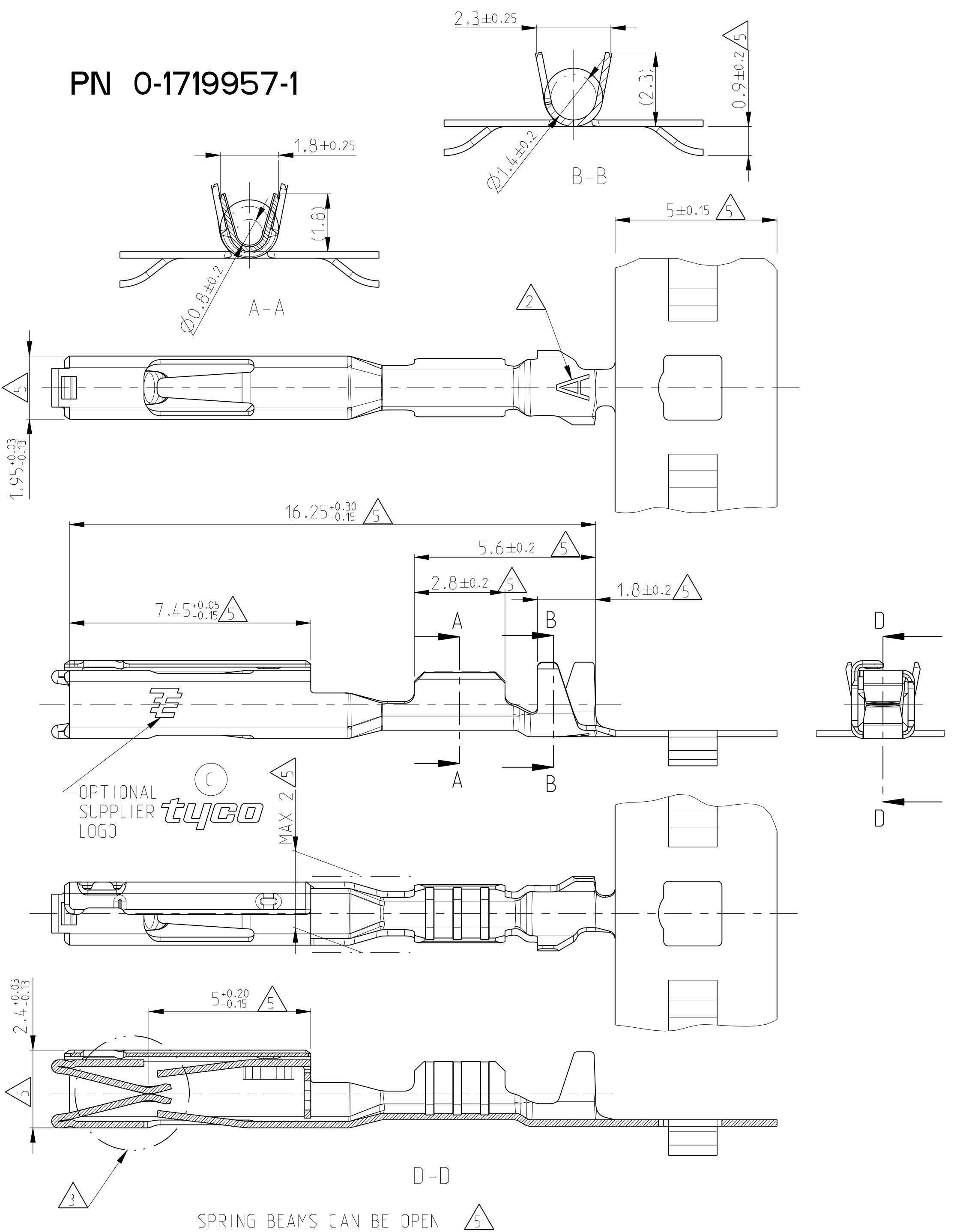

PN 0-1719958-1

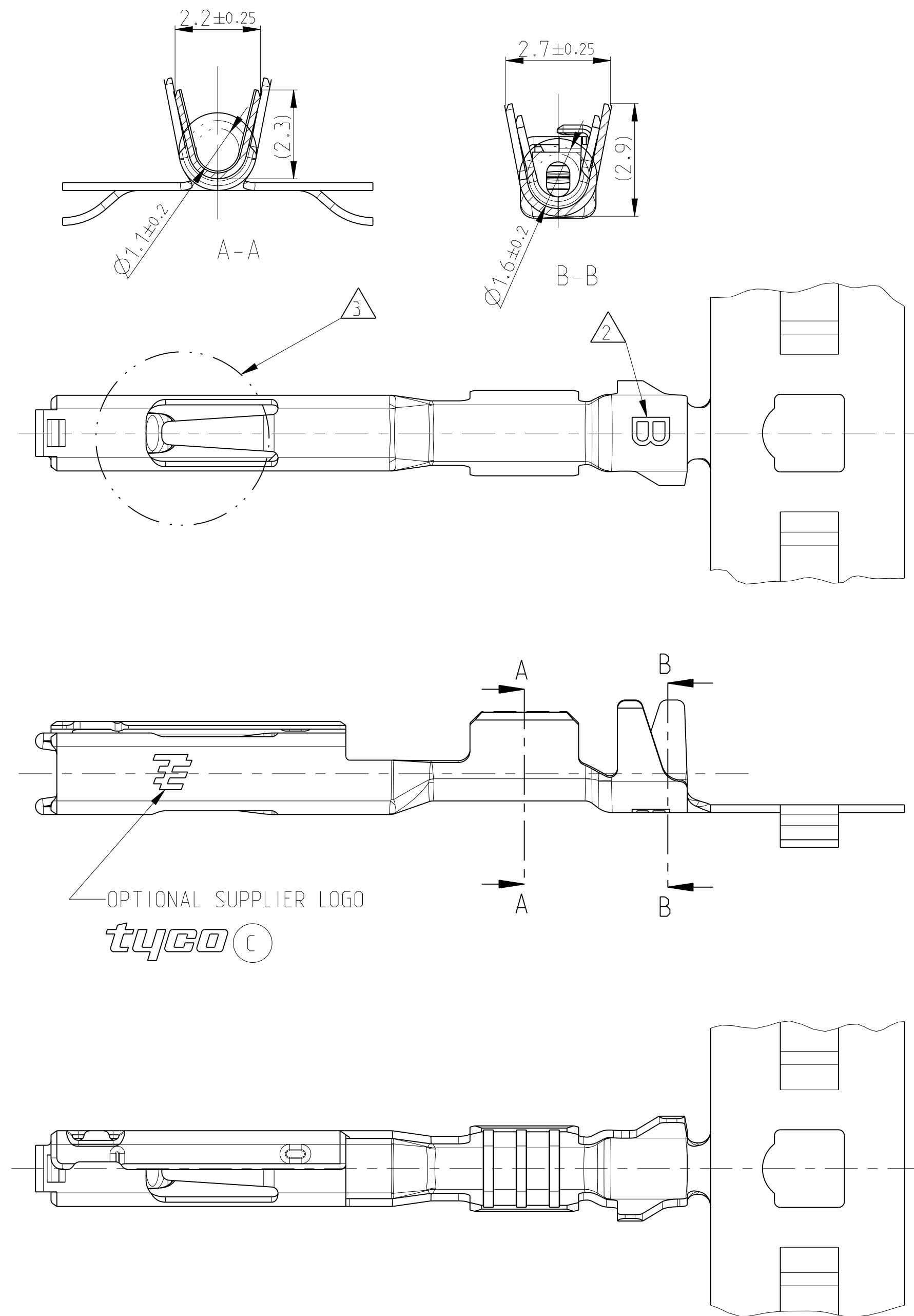

PN 0-1564880-1

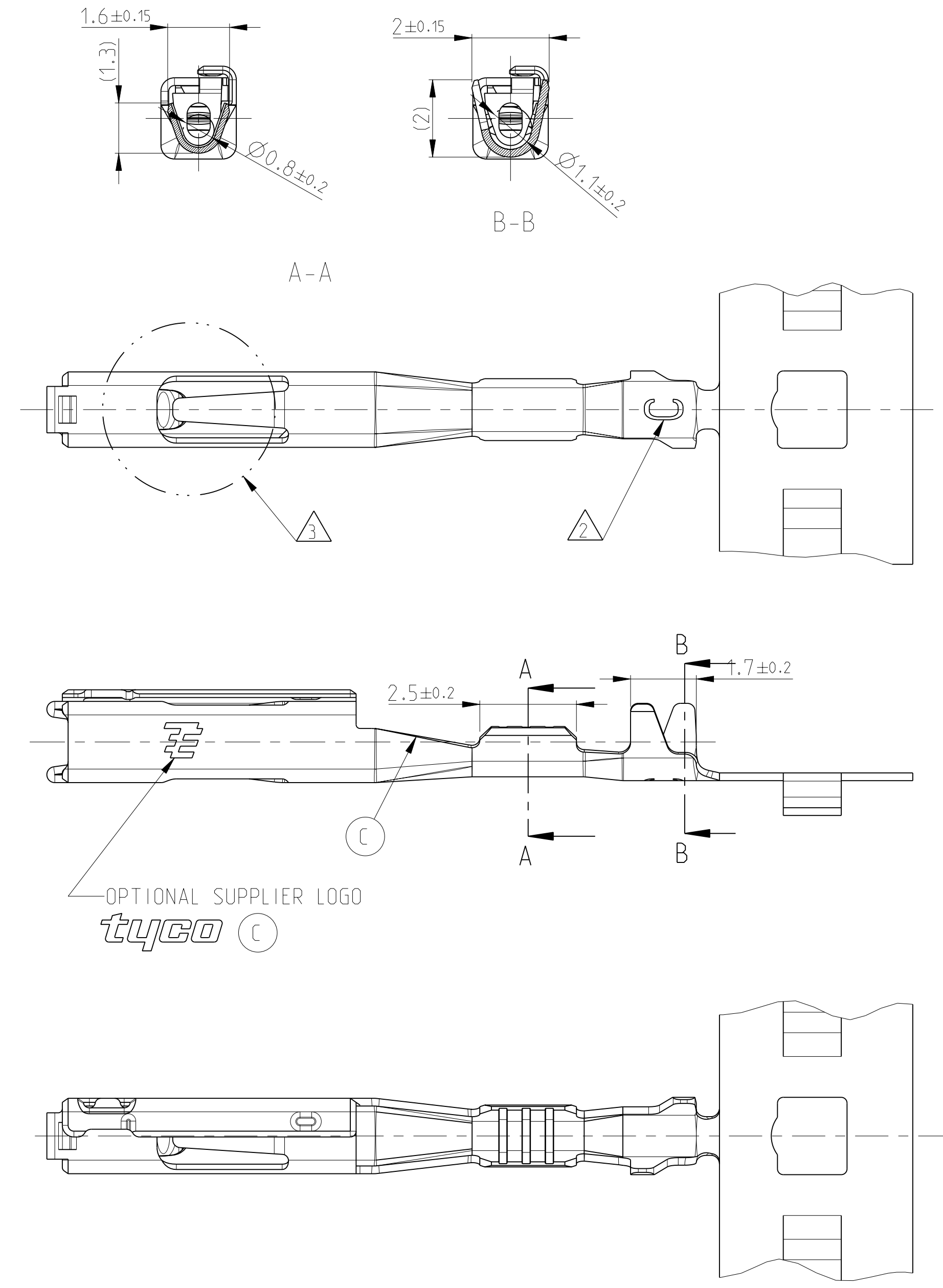

LOC	DIST	REV	DESCRIPTION	DATE	DWN	APVD
A1	-	B3	SEE PCN E-09-014603	26 JUN 2009	GH	GM
		C	SEE PCN E-10-021811	25 OCT 2010	GH	GS

REELING

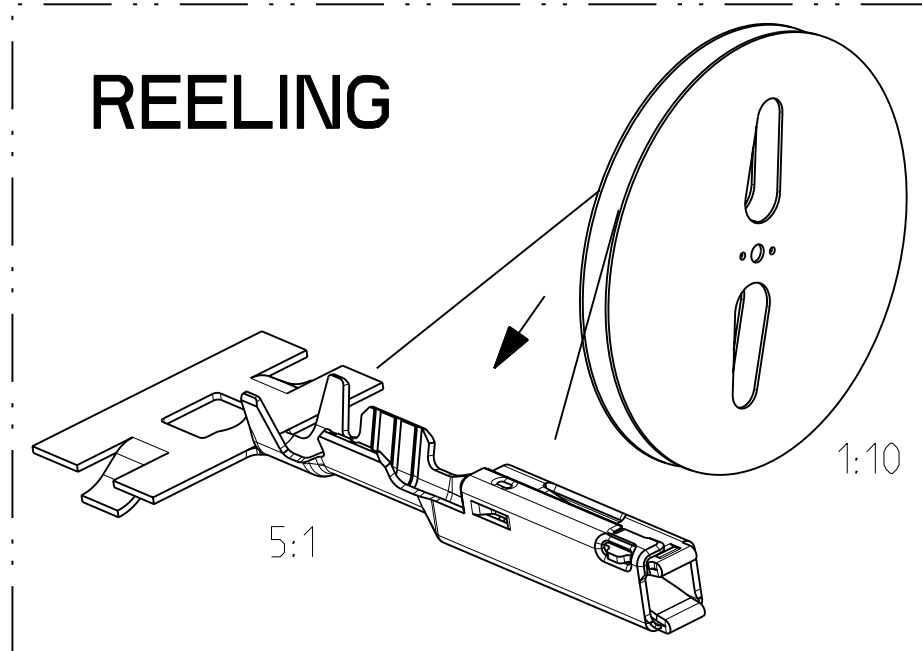

DIE FEED

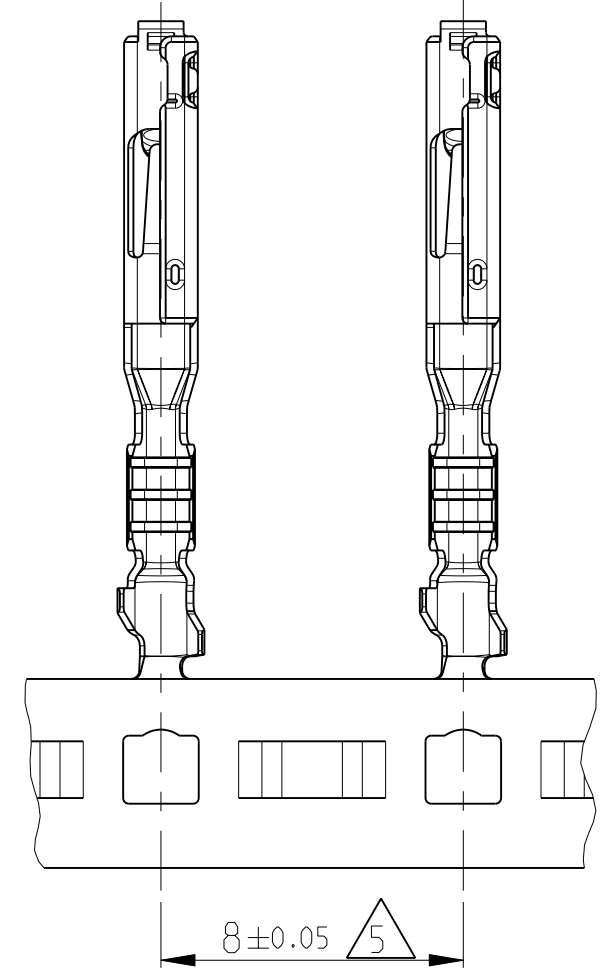

NOTES
BEMERKUNGEN

- 1 APPLICATION TOOL FEED 8.0±0.05
- 2 MARKING CRIMP CODE "A" FOR WIRE SIZE 0.22-0.35mm²
 MARKING CRIMP CODE "B" FOR WIRE SIZE 0.5-0.75mm²
 MARKING CRIMP CODE "C" FOR WIRE SIZE 0.13mm²
- 3 OPTIMOL (UNDILUTED) LUBRICATION IN THIS AREA
- 4 FEMALE TERMINALS SHOULD ALWAYS BE USED WITH PINS/MALE TERMINALS WITH THE SAME PLATING MATERIAL
- 5 DIMENSION APPLY TO ALL PART NUMBERS

PLATING	MATERIAL	WEIGHT (g)	CRIMP CODE	CONDUCTOR WIRE SIZE	TE PART NO	TE PART REV.
TIN HOT DIPPED 1-3µm	COPPER ALLOY	0.22	C	0.13mm ² ISO6722 THINN WALL	0-1564880-1	C
TIN HOT DIPPED 1-3µm	COPPER ALLOY	0.24	B	0.5-0.75mm ² /AWG 18-20	0-1719958-1	B
TIN HOT DIPPED 1-3µm	COPPER ALLOY	0.23	A	0.22-0.35mm ² /AWG 22	0-1719957-1	B

DIMENSIONS: mm		TOLERANCES UNLESS OTHERWISE SPECIFIED: 9 PLC ±0.3 1 PLC ±0.3 2 PLC ±0.3 3 PLC ± 4 PLC ± ANGLES ±		DWN G.S. HOEJA ZODEC 2006 CHK G. MUMPER ZODEC 2008		Tyco Electronics Tyco Electronics AMP GmbH 64625 Bensheim (Germany)	
MATERIAL S. TAB		FINISH S. TAB		NAME GET FEMALE TERMINAL, 0.2 STOCK SHEET GET BUCHSENKONTAKT, 0.2 BLECHSTAERKE		PRODUCT SPEC 108-94032 APPLICATION SPEC 114-18774	
WEIGHT S. TAB		SIZE CAGE CODE DRAWING NO A1 00779 C=1719957		RESTRICTED TO		CUSTOMER DRAWING SCALE 10:1 SHEET 1 OF 1 REV C	