



**Material**

Insulator: Glass filled PBT, (UL 94V-0)  
 Contact : Brass

**Electrical Characteristics**

Current rating: 3AMP  
 Dielectric Withstanding Voltage: AC 500V for 1 Minute.  
 Insulator Resistance: 1000MΩ Min. AT DC 500V.  
 Contact Resistance: 20mΩ Max.  
 Operating Temperature: -45°C ~ +105°C

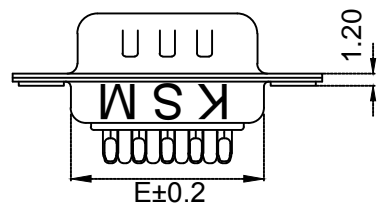
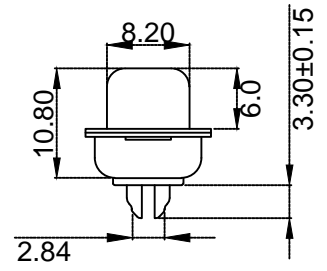
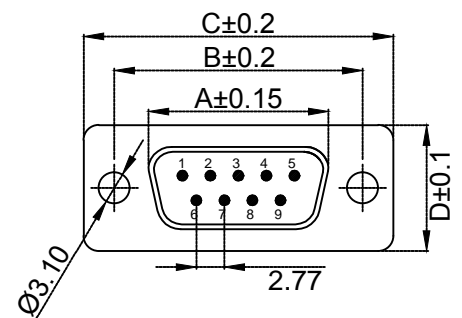

| PIN       | 尺寸     |       |       |       |       |      |       |     | D-SUB-*M     | 上海洲日电子有限公司<br>Shanghai Zhouri Electronics CO.,LTD<br>上海康司玛电子设备进出口有限公司<br>Shanghai KangSiMa Eletronic Equipment<br>import and export Co.,LTD<br>TEL:86-21-34975176/51571121 |                             |     |    |    |    |  |
|-----------|--------|-------|-------|-------|-------|------|-------|-----|--------------|--|-----------------------------|-----|----|----|----|--|
|           | A±0.15 | B±0.2 | C±0.2 | D±0.1 | E±0.2 |      |       |     |              |  |                             |     |    |    |    |  |
| D-SUB-9M  | 17.90  | 25.00 | 30.80 | 12.50 | 19.20 | X.   | ±0.3  | ±5° | 20171018 A/0 | ZR20171018-DB-61   | TEL:86-21-34975176/51571121 | 1:1 | mm | 图幅 | A4 |  |
| D-SUB-15M | 26.50  | 33.30 | 39.20 | 12.50 | 27.80 | X.X  | ±0.2  | ±3° |              |  |                             |     |    |    |    |  |
| D-SUB-25M | 40.00  | 47.10 | 53.05 | 12.50 | 41.30 | X.XX | ±0.15 |     |              |  |                             |     |    |    |    |  |
| D-SUB-37M | 56.50  | 63.50 | 69.44 | 12.50 | 57.50 |      |       |     | 201171018    | 物料编号   |                             |     |    |    |    |  |
|           |        |       |       |       |       |      |       |     | 201171018    |  |                             |     |    |    |    |  |
|           |        |       |       |       |       |      |       |     | 201171018    |  |                             |     |    |    |    |  |



: 1 1