

NOTES1:

UL Standard

- 1.Rated voltage/current : 300V / 30A
- 2.Withstanding voltage : AC1600V/1Min.
- 3.Torque value : M3 , 4.43lb.in
- 4.Wire range : 30~10AWG

IEC Standard

1. Pollution degree	2	2	3
Overvoltage category	II	III	III
Rate impulse voltage(KV)	6KV	6KV	6KV
Rate voltage(V)	1000V	630V	500V
Rate current(A)		32A	

- 2.Torque value : M3 , 0.5N·m
- 3.Wire range : 0.2~4.0mm<sup>2</sup>/6mm<sup>2</sup>(sol)

NOTES2:

- 1.Dimension shall be interpreted per ASME Y14.5-2009
- 2.Pitch : 6.35mm, Poles : N=02~24P
- 3.Stripping length : 8~9mm
- 4.Operating temperature: -40°C~+105°C
- 5.Undimensioned tolerances:

Pitch range in mm		Nominal dimension range in mm			
Over	Over	Over	Over	Over	Over
6	10	30	60	100	150
TO	TO	TO	TO	TO	TO
6	10	24	30	60	100
				150	
±0.15±0.20±0.30		±0.30±0.50±0.70		±1.00	±1.30
					±2°

6.RoHS Compliance

## Ordering Information

JL636S - 635 XX G 0 1

Pitch  
635=6.35PH      No.of pins  
2P,3P,4P~24P

Housing Color      Packing  
B=Black      0=Pe bag  
G=Green      T=Tube  
U=Blue      A=Tray  
R=Red  
W=White  
Y=Yellow  
D=Orange  
E=Grey

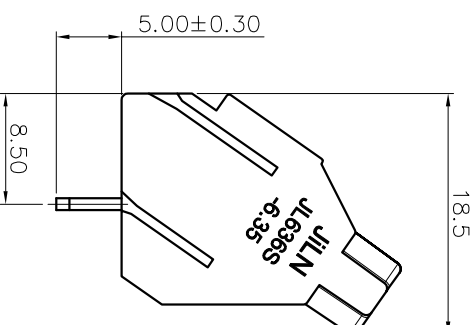
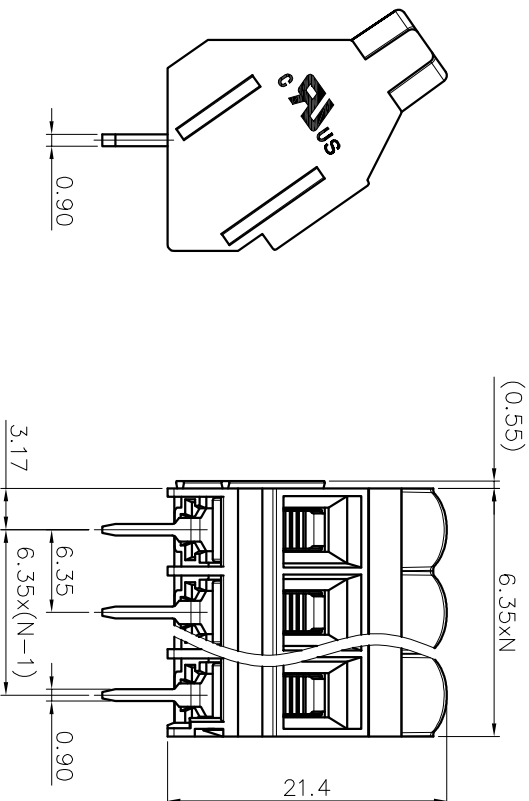
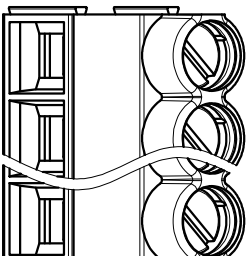

REVISION RECORD				
REV	ECN	DESCRIPTION	DRFT	DATE
A		新发行	Z.S.P	22.6.24

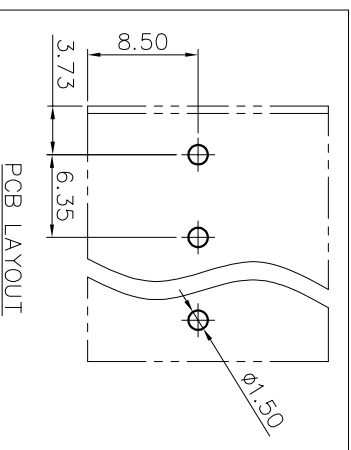

DRAW	SHUANGPING ZHENG		SCALE	FIT	jilin <sup>®</sup> 东莞市锦凌电子有限公司 DONGGUAN JINLING ELECTRONIC CO., LTD	
	UNIT	mm				
CHECK	LICHAD LIU	SIZE	A4	SHEET	1/1	PART NO. JL636S-635XXG01
APPROVE	YONGLIANG GAO	PRD				TITLE: JL636S-6.35-XXP 螺钉式端子台/绿色