

REV.	DESCRIPTION OF REVISIONS	APPR.	DRAW.	RELEASE	DATE
X1					
X2					

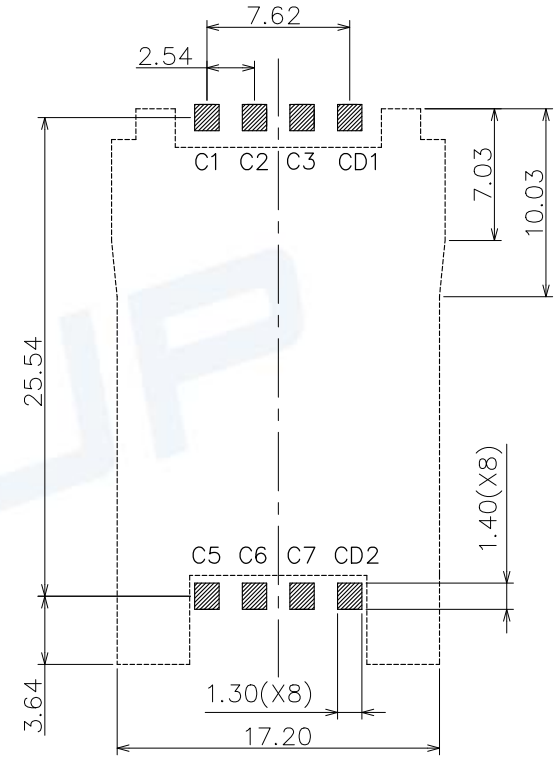

RECOMMENDED P.C.B LAYOUT  
COMPONENT SIDE(TOLERANCE ±0.05)

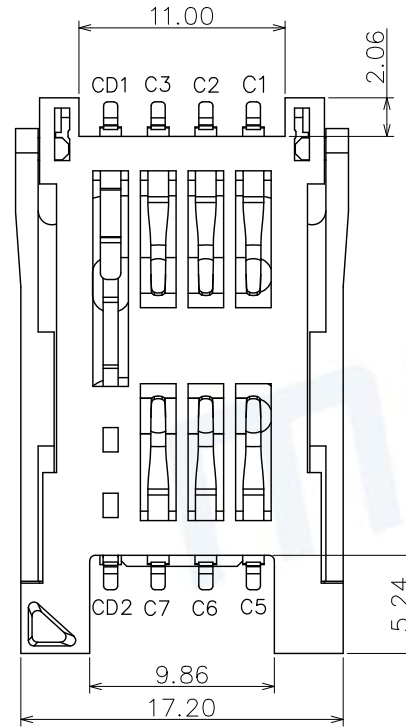
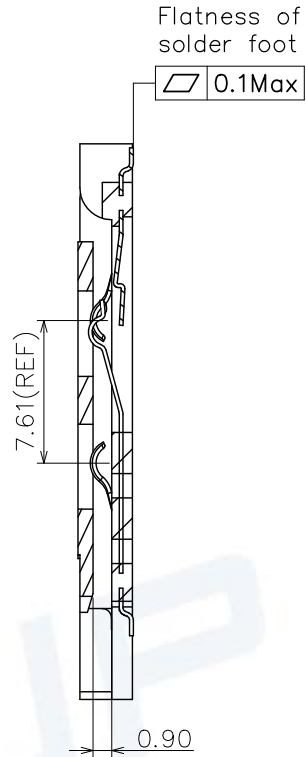
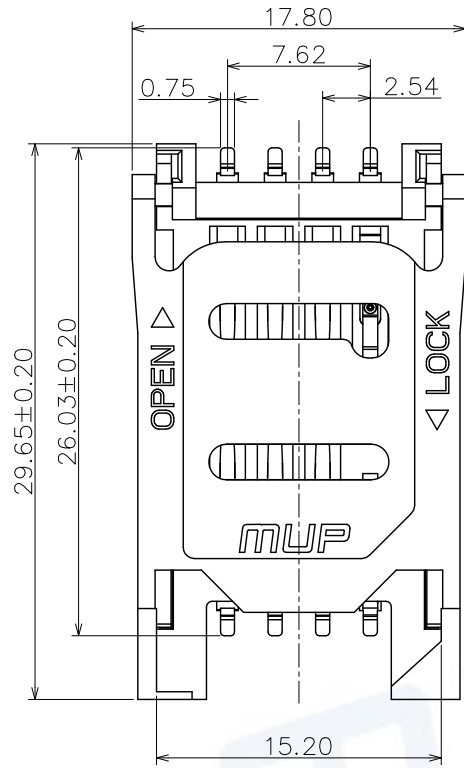

TECHNICAL CHARACTERISTICS

- General Characteristics  
Durability: 5,000 cycles min.
- Electrical Characteristics  
Contact resistance: 50mΩ typical, 100mΩ max  
Insulation resistance: >1000MΩ/500V DC
- Solderability  
Vapor phase: 215°C, 30sec. Max  
IR reflow: 260°C, 5sec. Max  
Manual soldering: 370°C, 3sec. Max
- Environmental Characteristics  
Operating temperature: -40°C~+85°C  
Operating humidity: 10%~+95%RH

ELECTRIC FUNCTION	DETECT SWITCH
WITHOUT CARD	OPEN
CARD INSERTED	CLOSED

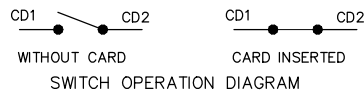

ITEM	PART NAME	Q'TY	MATERIAL	FINISH
1	BASE	1	Hi-temp Thermoplastic	Natural color UL94V-0
2	COVER	1	Hi-temp Thermoplastic	Natural color UL94V-0
3	DATA CONTACT	6	Copper Alloy	Contact area: Gold plated
4	SWITCH CONTACT 2	1	Copper Alloy	Contact area: Gold plated
5	SWITCH CONTACT 1	1	Copper Alloy	Contact area: Gold plated

Unless otherwise specified, other tolerance are:

**MUP** MUP INDUSTRIAL CO.,LTD.

NAME: **SIM Card Connector**

MODEL NO: **MUP-C7101-2**

TYPE: **H2.8 without post 6p(smaller hole)**

PROJ.	UNIT	SCALE	DRAWN	huabo Sep.14.2021	DWG NO.:
①	mm	1:1	CHECKED	Jimmy Sep.14.2021	DWG-MUP-C7101-002
CUSTOMER DRAWING			APPROVAL	Simon Sep.14.2021	SHEET
					1/1
					REVISION
					X1

