

MARK	DATE	EXPLANATION	REVISER
▽	20140805	Modified electroplating numbe	JACKY LIU
▽	20190123	Add "Nextron" LOGO and Nut post height	JACKY LIU

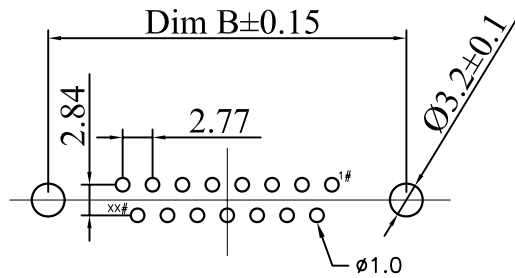
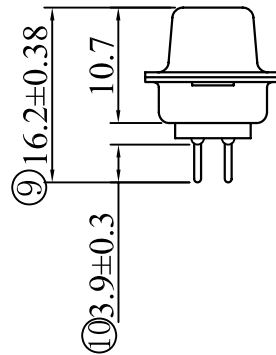
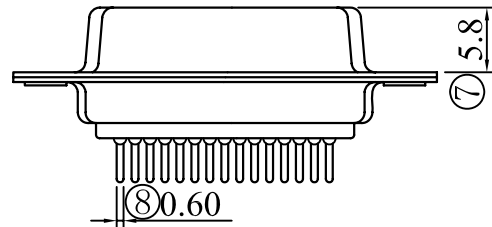
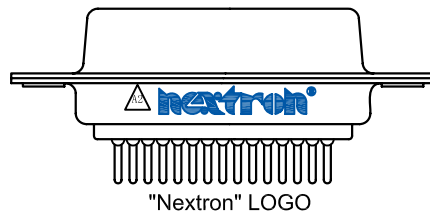
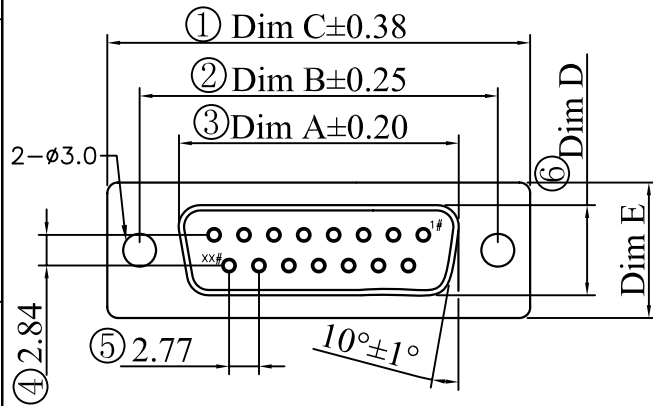

POS. NO.	A	B	C	D	E
37P	54.84	63.50	69.32	7.90	12.50
25P	38.38	47.04	53.04	7.90	12.50
15P	24.66	33.32	39.14	7.90	12.50
9P	16.33	24.99	30.81	7.90	12.50

SPECIFICATIONS:

Current rating:3.0A AC/DC
Voltage rating:250V AC/DC
Contact resistance:30m ohm MAX
Insulation resistance:1000M ohm MIN
Withstanding voltage:1000V AC for one minute
Operating temperature range:-40°C~+85°C
Thread specification of nut:#4-40UN

MATERIAL AND FINISH

Insulator:PBT+30%G.F(UL94V-0)
Contact:Copper Alloy Nickel Undercoated
Selective Gold Plated
Finish:Metal Iron With Tin Plated

Ordering Information

SUB		DPXF		XXXX		XXX		XXX		XXX		XXX					
Number of contacts		Housing Type		Mounting Options		Nut post height		Contacts Material		Contact Plated		Insulator material		Insulator color		Mark	
Code	Definition	Code	Definition	Code	Definition	Code	Definition	Code	Definition	Code	Definition	Code	Definition	Code	Definition	Code	Definition
1	9 PIN	M	Male	1	RIVETED W/ SHIELD ONLY	0	H=5,8mm	2	Brass	1	Full Gold 1u"	0	PBT	0	Black	0	NONE
2	15 PIN	F	Female	2	RIVETED W/ FRONT RIVET	1	H=4,8mm	7	Phosphor bronze	2	Gold 3u"	2	NYLON	6	Blue	2	Nextron
3	25 PIN			3	RIVETED W/ REAR RIVET					3	Gold 5u"						
4	37 PIN			4	RIVETED W/ NUT RIVET					4	Gold 10u"						
				5	RIVETED W/ HEX SCREW +HEX NUT					5	Gold 15u"						
										6	Gold 30u"						

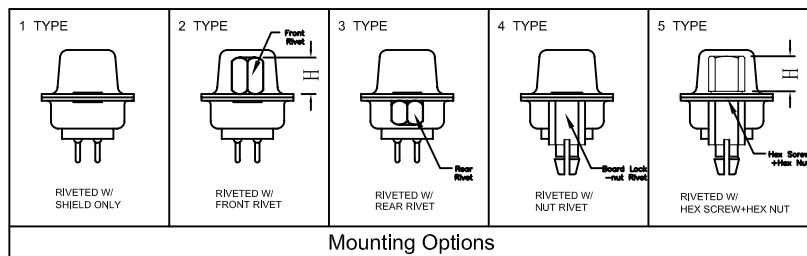

nextron 正凌精密工业股份有限公司
NEXTRONICS ENGINEERING CORP

PART. NAME: D型XX芯直插式PCB焊接插座 (孔) TITLE: D-SUB/DP/xxP/FEMALE/
PART. NO.: SEE TABLE DWG NAME: C-SUB-DP0F-0001

APPROVED BY: Jonnson CHECKED BY: Jeff DESIGNED BY: allan DRAWN BY: Jacky
CUSTOM NO.: 2019.01.23 Tolerance: x. ±0.50, x.xx ±0.30, x.xx ±0.20, xx° ±1°

UNITS: mm SCALE: REVISION:A2