

REV.	ECN. NO.	APPD.
A		

NOTES.
 Rated Current:1.0AMP.
 Contact Resistance:20mΩ Max.
 Withstand Voltage:500V AC/DC
 Insulation Resistance:1000MΩ Min.
 Operation Temperature:-40°C to +105°C

Contact Material:Brass
 Contact Plating:Au or Sn Over Ni
 Insulator Material:PA9T+30%G.F UL94V-0 BK

Recommended P.C.B Layout (Top Side)
 (PCB BOARD TOLERANCE±0.05)

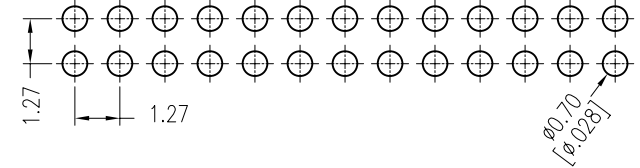
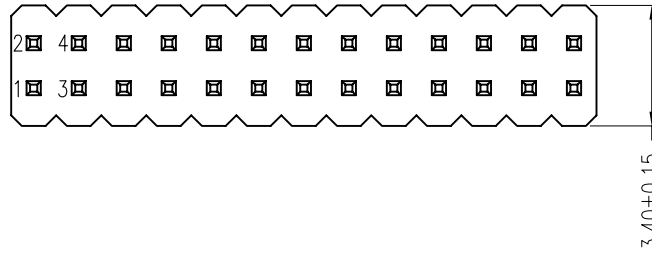

Ordering Information

MTP310-12XX S1

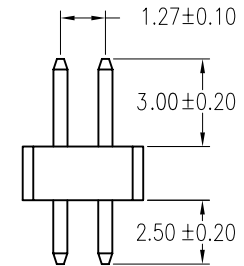
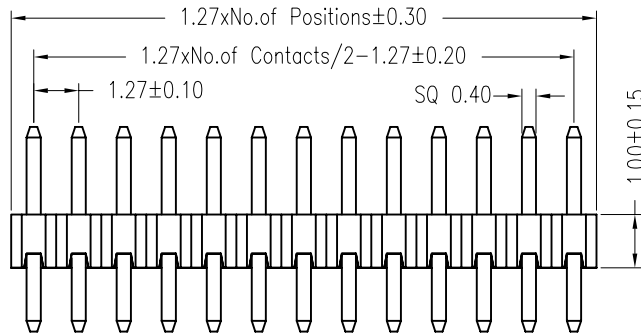

X. ± 0.30	X.° ± 5°	UNITS mm	NAME (INTENDED USE)	MINTRON CO.,LTD.				
.X ± 0.20	.X° ± 2°	MAT'L	PART NO. (INTENDED USE)		TITLE: PH1.27 DUAL ROW 180° H=1.0			
.XX ± 0.10	.XX° ± 1°	FINISH	APPD: SUNNY	DWG NO.:				
.XXX ± 0.05	.XXX° ± 0.5°		Q'TY	CHKD: LISA	MTP310-12XXS1			
PIN HEADER CONNECTOR			DR: ZOE	2006-11-28		SCALE	SHEET	REV.
						1/1	1/1	A