

REV.	ECN. NO.	APPD.
A		

NOTES.
 Rated Current:1.0AMP.
 Contact Resistance:20mΩ Max.
 Withstand Voltage:500V AC/DC
 Insulation Resistance:1000MΩ Min.
 Operation Temperature:-40°C to +105°C

Contact Material:Brass
 Contact Plating:Au or Sn Over Ni
 Insulator Material:PA9T+30%G.F UL94V-0 BK

Recommended P.C.B Layout (Top Side)
 (PCB BOARD TOLERANCE±0.05)

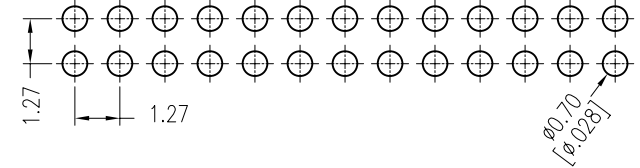
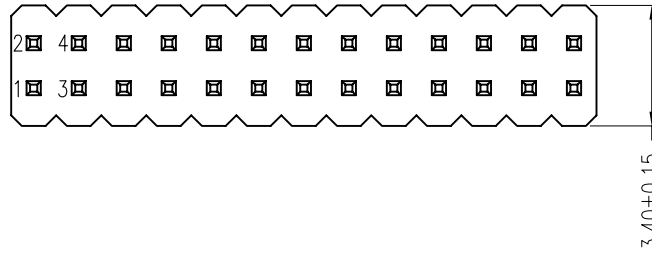

Ordering Information

MTP310-12XX S1

No. of Pins per
 Row: 01~40

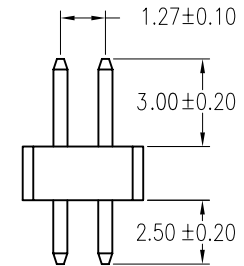
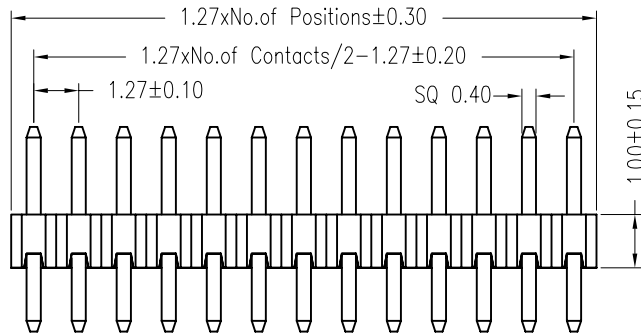

X. ± 0.30	X.° ± 5°	UNITS mm	NAME (INTENDED USE)	MINTRON CO.,LTD.
.X ± 0.20	.X° ± 2°	MAT'L		
.XX ± 0.10	.XX° ± 1°	FINISH	PART NO. (INTENDED USE)	TITLE: PH1.27 DUAL ROW 180° H=1.0
.XXX ± 0.05	.XXX° ± 0.5°		Q'TY	APPD: SUNNY
PIN HEADER CONNECTOR			CHKD: LISA	
			DR: ZOE 2006-11-28	