

REV.	ECN. NO.	APPD.
A		

NOTES:  
 Current Rating:1.5AMP  
 Contact Resistance:20mΩ max  
 Withstand Voltage:500V AC/DC  
 Insulation Resistance:1000MΩ min  
 Operation Temperature:-40°C to +105°C

Contact Material:Brass  
 Contact plating:Au or Sn Over Ni  
 Insulator Material:PA6T+30%GF(UL94V-0)

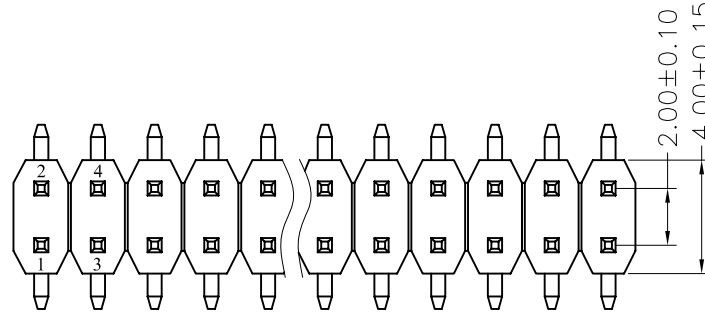

Recommended P.C.B Layout(Top Side)  
 (PCB BOARD TOLERANCE±0.05)

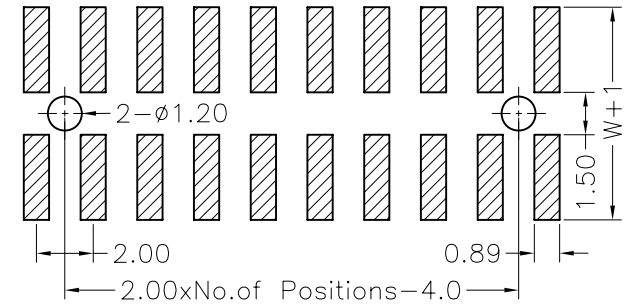

## Ordering Information

MTP220-12XXM2

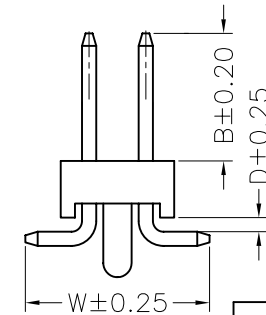
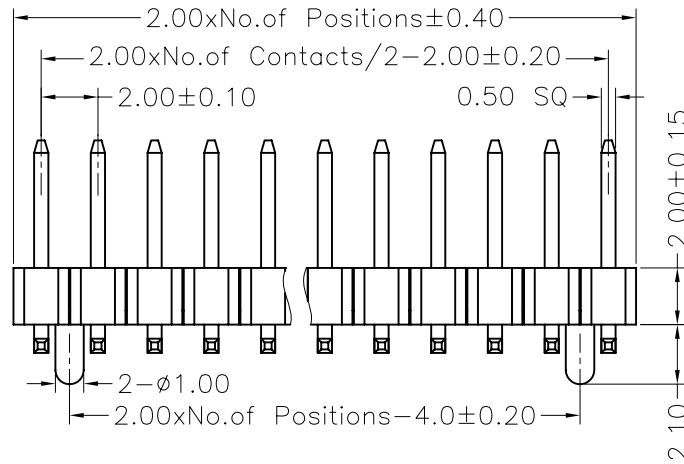
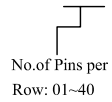

Dimension antitheses list			
ITEM	B	D	W
Standard	4.50	0.50	6.50
Alternate			

X. ± 0.30	X.° ± 5°	UNITS mm	NAME(INTENDED USE)	MINTRON CO.,LTD.			
.X ± 0.20	.X° ± 2°				MAT'L	TITLE: PH2.00 DUAL ROW SMT H=2.0	
.XX ± 0.10	.XX° ± 1°				FINISH		DWG NO.: MTP220-12XXM2
.XXX ± 0.05	.XXX° ± 0.5°				Q'TY		
PIN HEADER CONNECTOR			APPD: SUNNY	SCALE 1/1 SHEET 1/1 REV. A			
			CHKD: LISA				
			DR: ZOE 2006-11-28				