

REV.	ECN. NO.	APPD.
A		

NOTES:
 Current Rating:1.5AMP
 Contact Resistance:20mΩ max
 Withstand Voltage:500V AC/DC
 Insulation Resistance:1000MΩ min
 Operation Temperature:-40°C to +105°C

Contact Material:Brass
 Contact plating:Au or Sn Over Ni
 Insulator Material:PA6T+30%GF(UL94V-0)

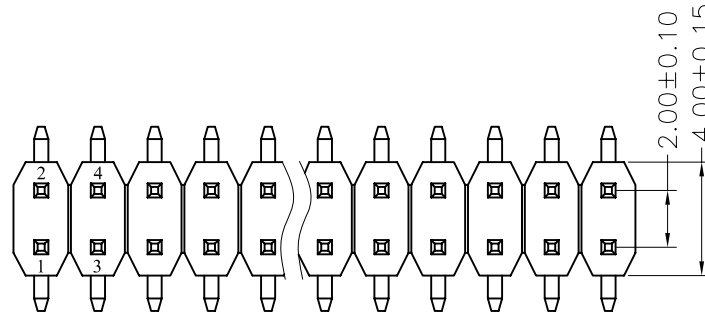

Recommended P.C.B Layout(Top Side)
 (PCB BOARD TOLERANCE±0.05)

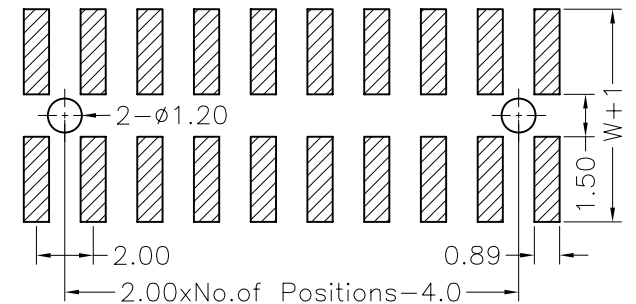

Ordering Information

MTP220-12XXM2

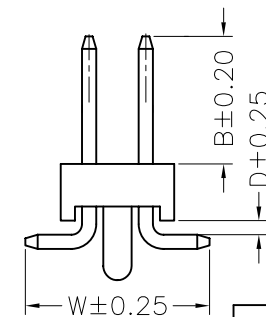
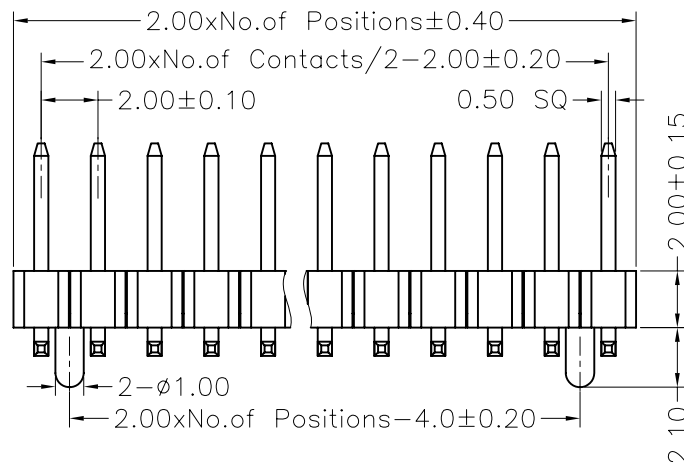
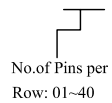

Dimension antitheses list			
ITEM	B	D	W
Standard	4.50	0.50	6.50
Alternate			

X. ± 0.30	X.° ± 5°	UNITS mm	NAME(INTENDED USE)	MINTRON CO.,LTD.
.X ± 0.20	.X° ± 2°			
.XX ± 0.10	.XX° ± 1°	FINISH	PART NO.(INTENDED USE)	
.XXX ± 0.05	.XXX° ± 0.5°	Q'TY	APPD: SUNNY	
PIN HEADER CONNECTOR			CHKD: LISA	TITLE: PH2.00 DUAL ROW SMT H=2.0
			DR: ZOE 2006-11-28	DWG NO.: MTP220-12XXM2
				SCALE 1/1
				SHEET 1/1
				REV. A