

TYPE2

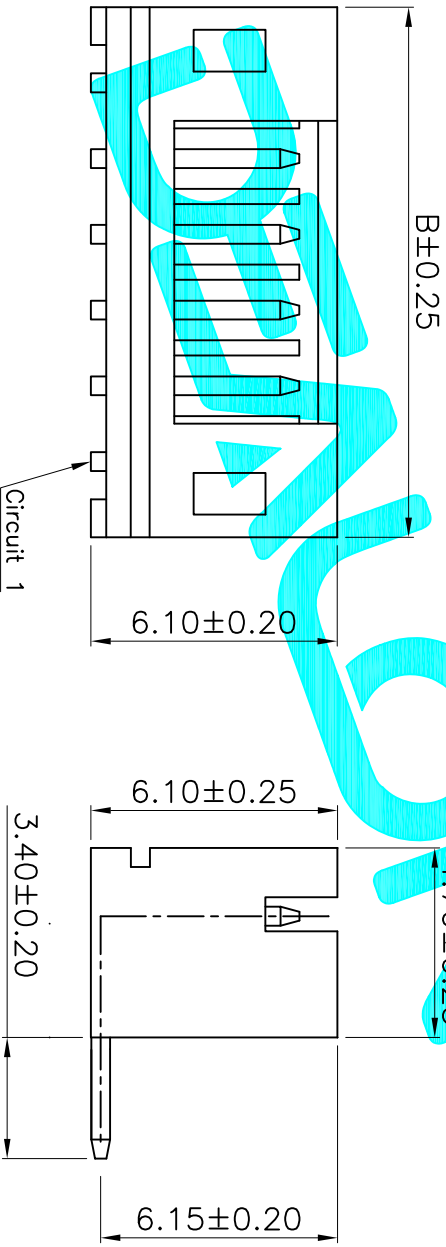

Poles	Dimensions(mm)		Poles	Dimensions(mm)	
	A	B		A	B
02	2.00	6.00	08	14.00	18.00
03	4.00	8.00	09	16.00	20.00
04	6.00	10.00	10	18.00	22.00
05	8.00	12.00	11	22.00	24.00
06	10.00	14.00	12	24.00	26.00
07	12.00	16.00	13	26.00	28.00

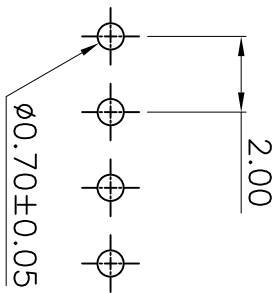

P.C.B LAYOUT

- 技术指标:
1. 塑件表面应无污、无毛边、无明显收缩、缺陷、裂纹等现象。
 2. 温度范围: -25° C~85° C.
 3. 额定电压: 50V, AC, DC.
 4. 接触电阻: ≤0.02Ω.
 5. 绝缘电阻: ≥100MΩ.

APPROVALS		DATE	DRAWING NO.	
DRAWN	G.M.Chen	2015/7/17	PH-W-XXA	
CHECKED			SHEET 1 OF 1	
APPROVALS			PROJ.	
<p>DEALON 德之隆® ELECTRONICS CO.,LTD</p>				
<p>30°±0.1° ±0.30 10°~30° ±0.20 5°~10° ±0.15 ~5 ±0.10</p>				
<p>PH-W-XXA 2.0 Pitch 弯插</p>				
<p>ECN NO. REV. DATE. DESCRIPTION. CHANGE. CHECK. APPRO.</p>				
<p>NEW</p>				