

Product Summary

$V_{(BR)DSS}$	$R_{DS(on)MAX}$	I_D
20V	380mΩ@4.5V	0.75A
	450mΩ@2.5V	
	800mΩ@1.8V	

Feature

- Surface Mount Package
- N-Channel Switch with Low $R_{DS(on)}$
- Operated at Low Logic Level Gate Drive

Application

- Load/Power Switching
- Interfacing Switching
- Battery Management for Ultra Small Portable Electronics
- Logic Level Shift

MARKING:

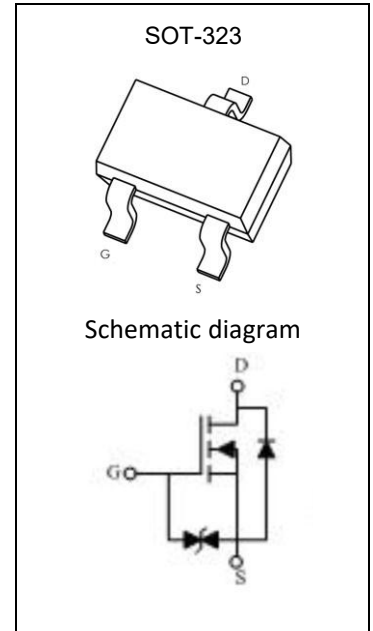

ABSOLUTE MAXIMUM RATINGS ($T_a=25^\circ\text{C}$ unless otherwise noted)

Parameter	Symbol	Value	Unit
Drain-Source Voltage	V_{DS}	20	V
Gate-Source Voltage	V_{GS}	± 12	V
Continuous Drain Current	I_D	0.75	A
Pulsed Drain Current ⁽¹⁾	I_{DM}	3	A
Power Dissipation ⁽²⁾	P_D	200	mW
Thermal Resistance from Junction to Ambient ⁽¹⁾	$R_{\theta JA}$	625	$^\circ\text{C}/\text{W}$
Junction Temperature	T_J	150	$^\circ\text{C}$
Storage Temperature	T_{STG}	-55~ +150	$^\circ\text{C}$

MOSFET ELECTRICAL CHARACTERISTICS(T_a=25°C unless otherwise noted)

Parameter	Symbol	Test Condition	Min	Type	Max	Unit
Static Characteristics						
Drain-source breakdown voltage	V _{(BR)DSS}	V _{GS} = 0V, I _D = 250μA	20			V
Zero gate voltage drain current	I _{DSS}	V _{DS} = 20V, V _{GS} = 0V			1	μA
Gate-body leakage current	I _{GSS}	V _{GS} = ±10V, V _{DS} = 0V			±20	μA
Gate threshold voltage ⁽³⁾	V _{GS(th)}	V _{DS} = V _{GS} , I _D = 250μA	0.35	0.75	1.1	V
Drain-source on-resistance ⁽³⁾	R _{DS(on)}	V _{GS} = 4.5V, I _D = 650mA		190	380	mΩ
		V _{GS} = 2.5V, I _D = 550mA		260	450	
		V _{GS} = 1.8V, I _D = 450mA		350	800	
Forward tranconductance	g _{FS}	V _{DS} = 10V, I _D = 800mA		1.6		S
Dynamic characteristics⁽⁴⁾						
Input Capacitance	C _{iss}	V _{DS} = 16V, V _{GS} = 0V, f = 1MHz		79	120	pF
Output Capacitance	C _{oss}			13	20	
Reverse Transfer Capacitance	C _{rss}			9	15	
Switching Characteristics⁽⁴⁾						
Turn-on delay time	t _{d(on)}	V _{DS} = 10V, I _D = 500mA, V _{GS} = 4.5V, R _G = 10Ω		6.7		ns
Turn-on rise time	t _r			4.8		
Turn-off delay time	t _{d(off)}			17.3		
Turn-off fall time	t _f			7.4		
Source-Drain Diode characteristics						
Diode Forward voltage ⁽³⁾	V _{DS}	I _S = 0.15A, V _{GS} = 0V			1.2	V

Notes:

1. Repetitive Rating: Pulse width limited by maximum junction temperature.
2. This test is performed with no heat sink at T_a = 25°C.
3. Pulse Test : Pulse Width ≤ 300μs, Duty Cycle ≤ 0.5%.
4. These parameters have no way to verify.

Typical Electrical and Thermal Characteristics

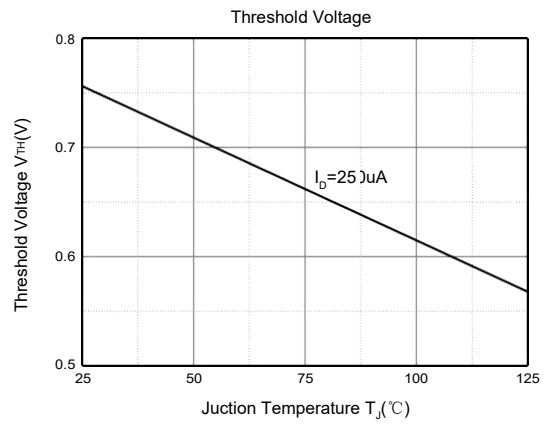
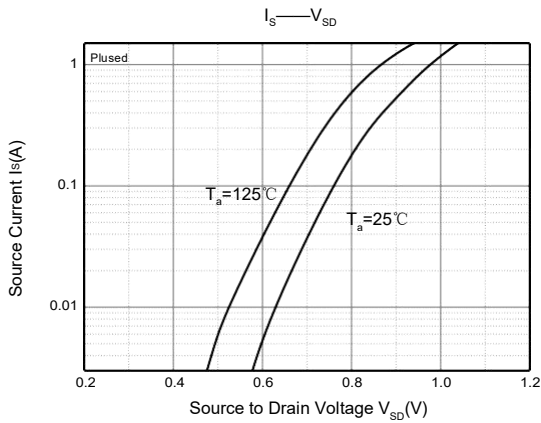
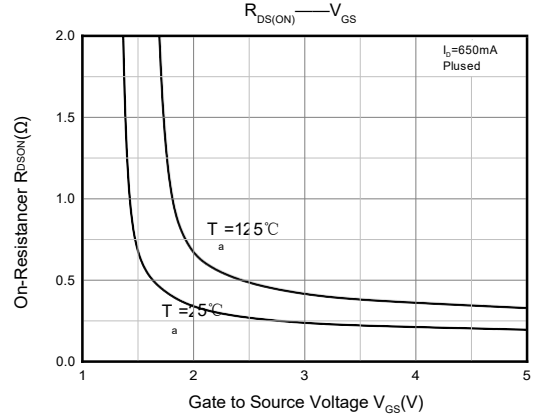
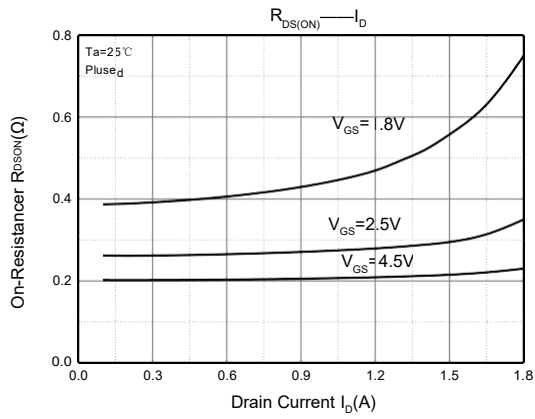
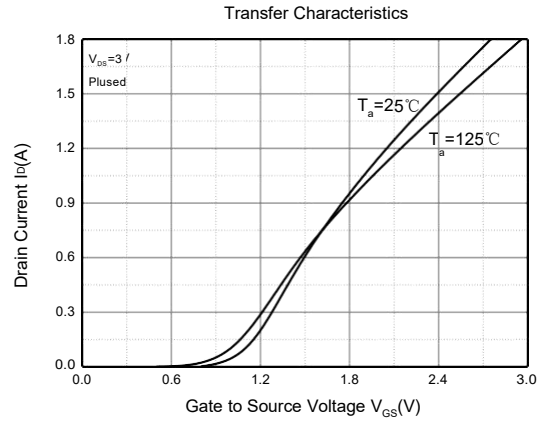
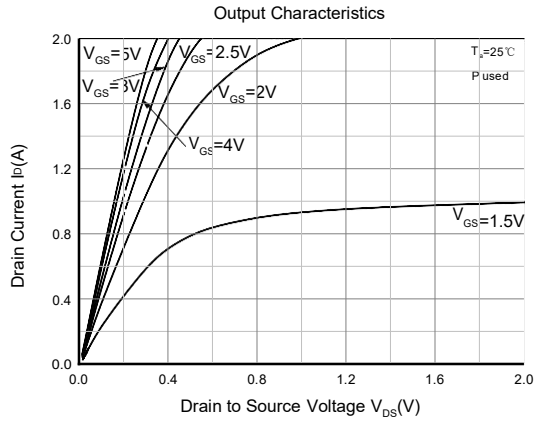



SOT-323 Package Information

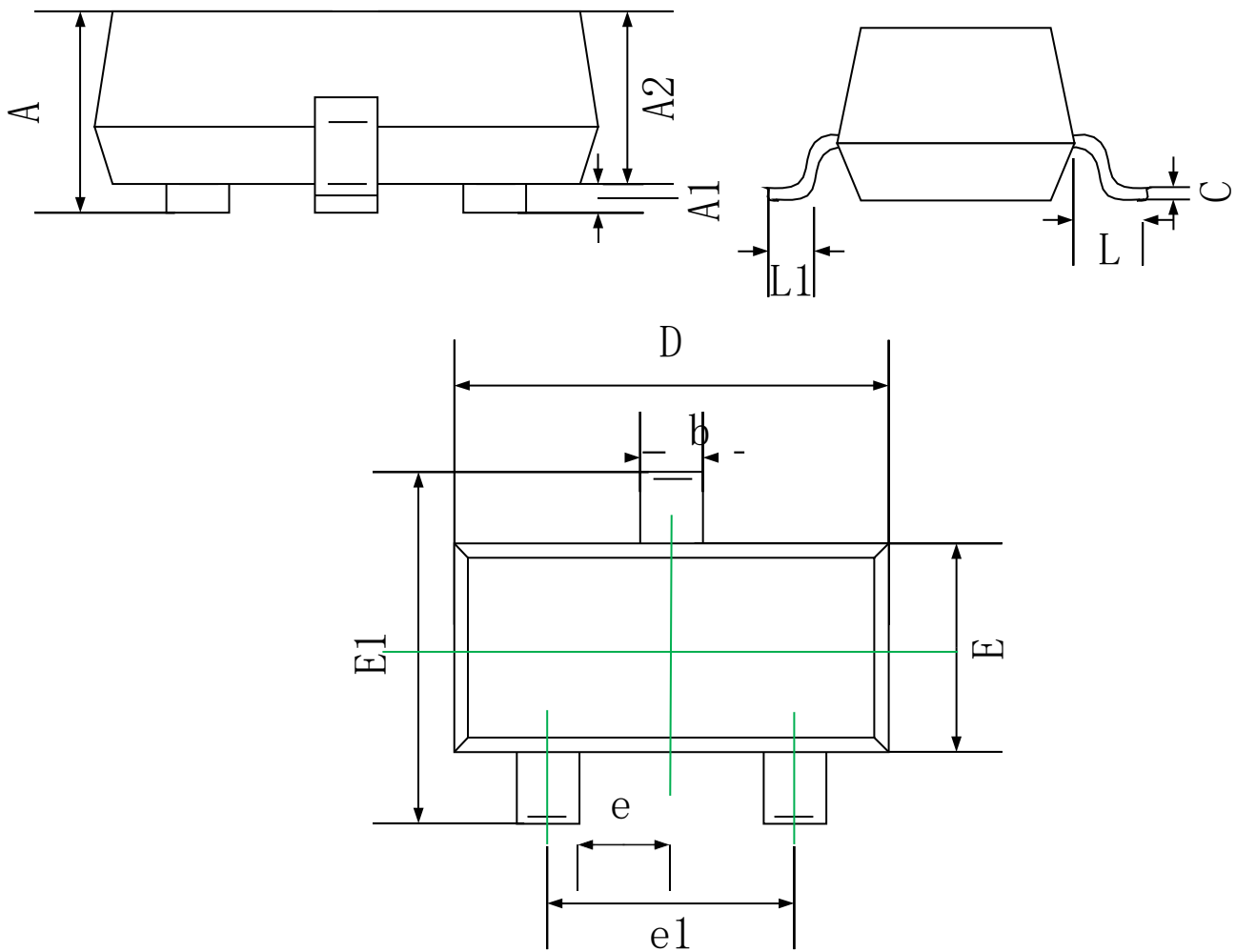

Symbol	Dimensions In Millimeters	
	Min.	Max.
A	0.90	1.10
A1	0.00	0.10
A2	0.90	1.00
b	0.30	0.50
c	0.10	0.15
D	2.00	2.20
E	1.15	1.35
E1	2.15	2.40
e	0.65 TYP.	
e1	1.20	1.40
L	0.525 REF.	
L1	0.26	0.46

SOT-323 Tape and Reel

SOT-323 Tape and reel

SOT-323 Embossed Carrier Tape

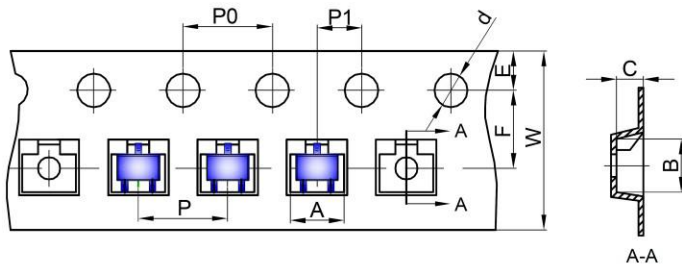

Packaging Description:

SOT-323 parts are shipped in tape. The carrier tape is made from a dissipative (carbon filled) polycarbonate resin. The cover tape is a multilayer film (Heat Activated Adhesive in nature) primarily composed of polyester film, adhesive layer, sealant, and anti-static sprayed agent. These reeled parts in standard option are shipped with 3,000 units per 7" or 17.8cm diameter reel. The reels are clear in color and is made of polystyrene plastic (anti-static coated).

Dimensions are in millimeter											
Pkg type	A	B	C	d	E	F	P0	P	P1	W	
SOT-323	2.25	2.55	1.19	Ø1.55	1.75	3.50	4.00	4.00	2.00	8.00	

SOT-323 Tape Leader and Trailer

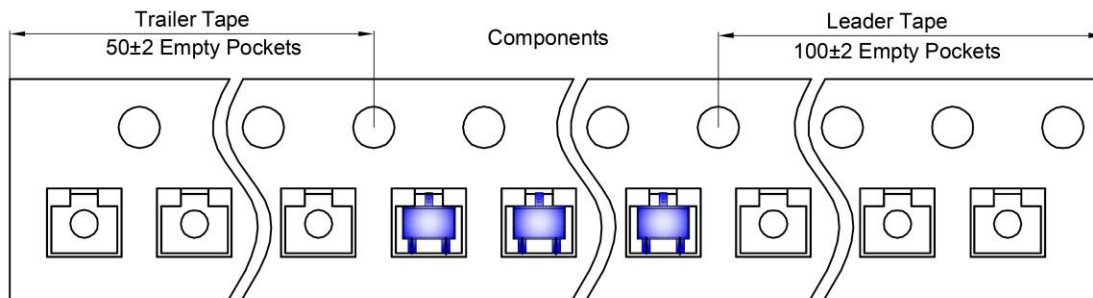

SOT-323 Reel

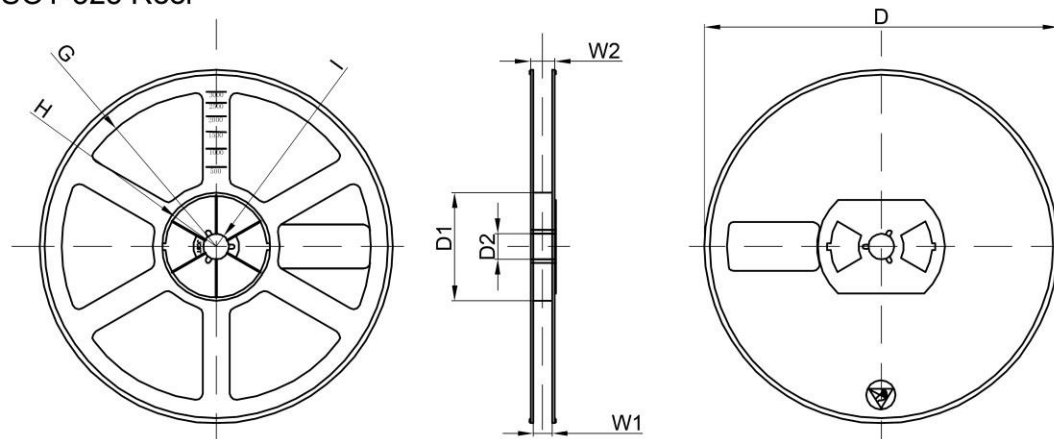

Dimensions are in millimeter								
Reel Option	D	D1	D2	G	H	I	W1	W2
7" Dia	Ø178.00	54.40	13.00	R78.00	R25.60	R6.50	9.50	12.30

REEL	Reel Size	Box	Box Size(mm)	Carton	Carton Size(mm)	G.W.(kg)
3000 pcs	7 inch	30,000 pcs	203×203×195	120,000 pcs	438×438×220	