

| | | |
|------|----------|-------|
| REV. | ECN. NO. | APPD. |
| A | | |

NOTES:
 Current Rating:1.5AMP
 Contact Resistance:20mΩ max
 Withstand Voltage:500V AC/DC
 Insulation Resistance:1000MΩ min
 Operation Temperature:-40°C to +105°C

Contact Material:Brass
 Contact plating:Au or Sn Over Ni
 Insulator Material:PA6T+30%GF(UL94V-0)

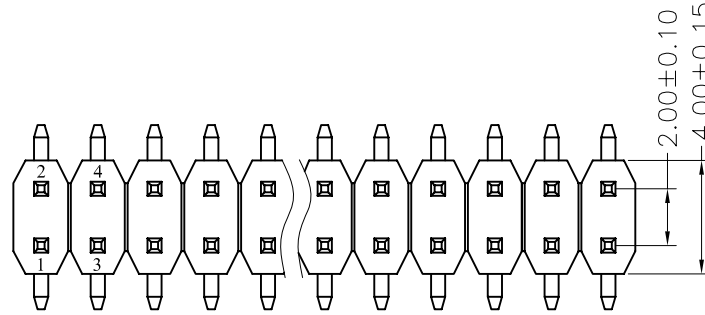

Recommended P.C.B Layout(Top Side)
 (PCB BOARD TOLERANCE±0.05)

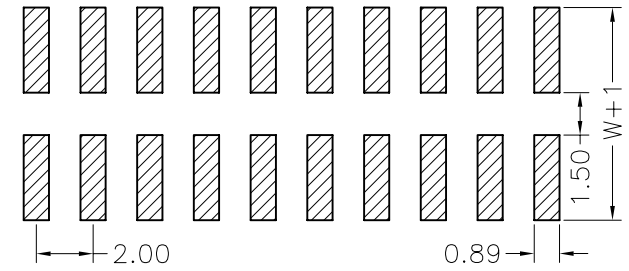

Ordering Information

MTP220-12XXM1

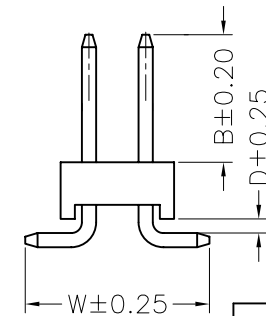
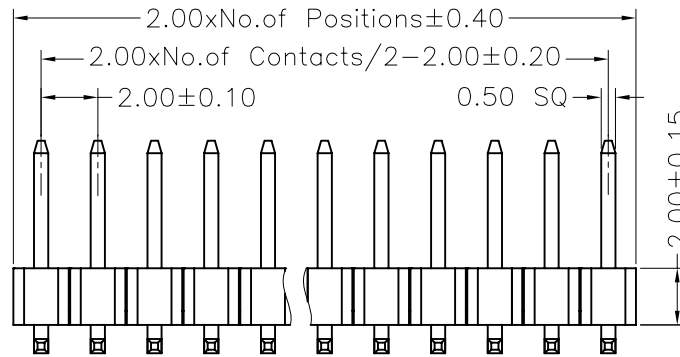

| Dimension antitheses list | | | |
|---------------------------|------|------|------|
| ITEM | B | D | W |
| Standard | 4.50 | 0.50 | 6.50 |
| Alternate | | | |

| | | | | |
|----------------------|--------------|----------|------------------------|----------------------------------|
| X. ± 0.30 | X.° ± 5° | UNITS mm | NAME(INTENDED USE) | MINTRON CO.,LTD. |
| .X ± 0.20 | .X° ± 2° | | | |
| .XX ± 0.10 | .XX° ± 1° | FINISH | PART NO.(INTENDED USE) | |
| .XXX ± 0.05 | .XXX° ± 0.5° | Q'TY | APPD: SUNNY | |
| PIN HEADER CONNECTOR | | | CHKD: LISA | TITLE: PH2.00 DUAL ROW SMT H=2.0 |
| | | | DR: ZOE 2006-11-28 | DWG NO.: MTP220-12XXM1 |
| | | | | SCALE 1/1 |
| | | | | SHEET 1/1 |
| | | | | REV. A |