

REV.	ECN. NO.	APPD.
A		

NOTES:
 Rated Current:2.0AMP.
 Contact Resistance:20mΩ Max.
 Withstand Voltage:500V AC/DC
 Insulation Resistance:1000MΩ Min.
 Operation Temperature:-40°C to +105°C

Contact Material:Brass
 Contact Plating:Au or Sn Over Ni
 Insulator Material:PA9T+30%G.F UL94V-0 BK

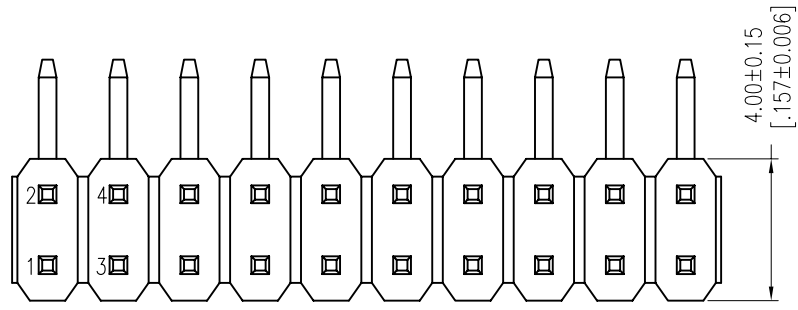

Recommended P.C.B Layout (Top Side)
 (PCB BOARD TOLERANCE±0.05)

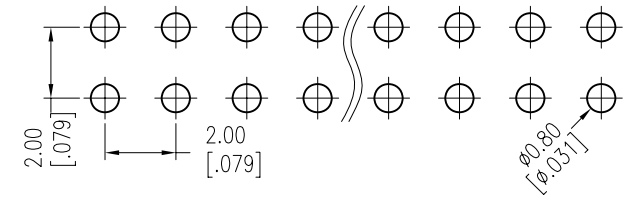

Ordering Information

MTP220-12XXR1

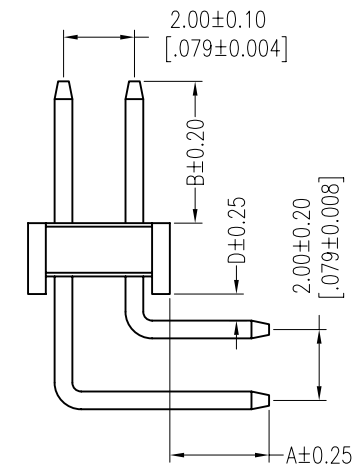
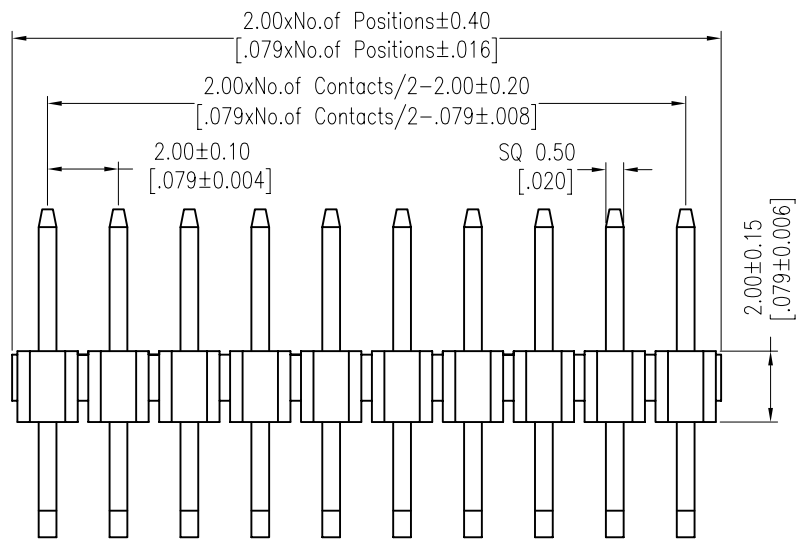

Item	Pin Length	A	D	B	Mating			
Standard	10.50	2.80	0.75	4.00	2240	2243	2263	2272
Alternate								

X. ± 0.30	X.° ± 5°	UNITS mm	NAME (INTENDED USE)	MINTRON CO.,LTD.										
.X ± 0.20	.X° ± 2°						MAT'L	TITLE: MTP220-12XXR1						
.XX ± 0.10	.XX° ± 1°										FINISH	APPD: SUNNY		
.XXX ± 0.05	.XXX° ± 0.5°													
PIN HEADER CONNECTOR		DR: ZOE 2006-11-28		DWG NO.:										
			SCALE 1/1			SHEET 1/1		REV. A						