

| | | |
|------|----------|-------|
| REV. | ECN. NO. | APPD. |
| A | | |

NOTES:
 Current Rating:3.0AMP
 Contact Resistance:20mΩ max
 Withstand Voltage:500V AC/DC
 Insulation Resistance:1000MΩ min
 Operation Temperature:-40°C to +105°C

Contact Material:Brass
 Contact plating:Au or Sn Over Ni
 Insulator Material:PBT or PA6T+30%GF(UL94V-0)

Recommended P.C.B Layout(Top Side)
 (PCB BOARD TOLERANCE±0.05)

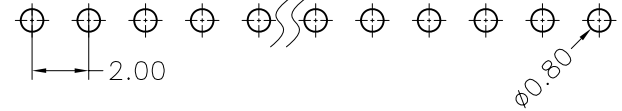
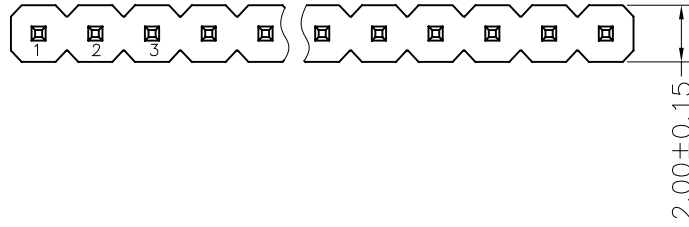

MTP220-11XXS1

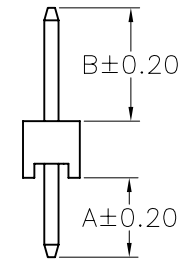
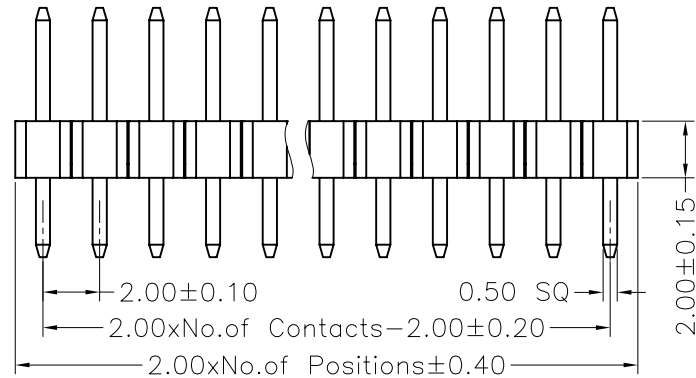
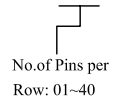

| Dimension antitheses list | | |
|---------------------------|------|------|
| ITEM | A | B |
| Standard | 2.80 | 4.00 |
| Alternate | | |

| X. ± 0.30 | X.° ± 5° | UNITS mm | NAME(INTENDED USE) | MINTRON CO.,LTD. | | | | | | | |
|----------------------|--------------|----------|--------------------|------------------|--|------------------------|----------------------|------|-----|-----|---|
| .X ± 0.20 | .X° ± 2° | | | | MAT'L | PART NO.(INTENDED USE) | TITLE: MTP220-11XXS1 | | | | |
| .XX ± 0.10 | .XX° ± 1° | FINISH | APPD: SUNNY | DWG NO.: | | | | | | | |
| .XXX ± 0.05 | .XXX° ± 0.5° | | Q'TY | CHKD: LISA | | | | | | | |
| PIN HEADER CONNECTOR | | | DR: ZOE 2006-11-28 | | <table border="1"> <tr> <th>SCALE</th> <th>SHEET</th> <th>REV.</th> </tr> <tr> <td>1/1</td> <td>1/1</td> <td>A</td> </tr> </table> | SCALE | SHEET | REV. | 1/1 | 1/1 | A |
| SCALE | SHEET | REV. | | | | | | | | | |
| 1/1 | 1/1 | A | | | | | | | | | |